

## PUBLIC MEETING NOTICE

The Carlin City Council, City of Carlin, State of Nevada, will conduct a **Regular** meeting on **June 10, 2020** beginning at **7:00pm**. For more information on the available Live Stream and Public Comment opportunity, please see below.

Attached, with this Notice, is the Agenda for the City Council Meeting. We are pleased to make reasonable accommodations for members of the public who are disabled and wish to participate during the meeting. If special arrangements are necessary, please notify LaDawn Lawson, City Clerk, in writing at PO Box 787, Carlin, Nevada 89822 or by telephoning 775-754-6354.

In accordance with Federal law and U.S. Department of Agriculture policy, the City of Carlin is prohibited from discriminating on the basis of race, color, national origin, sex, religion, age, disability. To file a complaint of discrimination, write USDA, Director, Office of Civil Rights, 1400 Independence Avenue, S.W. Washington, D.C. 20250-9410 or call (800) 795-3272 (voice) or (202) 720-6382 (TDD).

**In accordance with Nevada Declaration of Emergency Directive 006, Directive 016, Directive 018, and Directive 021 Section 37** this agenda has been posted in the following locations:

- City of Carlin Website
- State of Nevada Public Notice Website

**In accordance with Nevada Declaration of Emergency 006, Section 2**, this City Council Meeting will stream on Facebook Live on the City of Carlin Facebook Page: <http://www.facebook.com/CityofCarlin>. The City of Carlin will not monitor comments made during the live stream. If you would like to submit a statement to be read into the record, or receive supporting material electronically, please email them directly to City Manager Madison Mahon [mmahon@cityofcarlin.com](mailto:mmahon@cityofcarlin.com), or call City Hall at (775) 754-6354 **by Wednesday, June 10, 2020 at 5:00PM.**

  
\_\_\_\_\_  
Madison Mahon, Carlin City Manager

Agenda prepared by City Manager Madison Mahon.

*Dated this 3rd day of June, 2020.*

***The City of Carlin is an equal opportunity employer and provider.***

**CARLIN CITY COUNCIL  
CITY OF CARLIN, STATE OF NEVADA  
CARLIN MUNICIPAL COURT ROOM  
101 SOUTH EIGHTH STREET  
CARLIN, NEVADA**

**June 10, 2020  
7:00PM**

**The public may address the Board on agenda items as they are reviewed, at the discretion of the presiding officer or during the time reserved for Comments by the General Public, after being recognized by the presiding officer. The Public and all persons addressing the Board must abide by the requirements of the Carlin Municipal Code 1-6-11, detailed at the Public Comment section of this agenda.**

**Note: The Mayor or Vice Mayor Reserves the Right to Change the Order of the Agenda. Additionally, the Council may, by majority vote, combine two or more agenda items for consideration or may remove any item from the agenda or delay consideration to a future City Council Agenda.**

**Call to Order and Roll Call**

**Pledge of Allegiance**

- 1. Comment by the General Public (Non-Action Item):** Pursuant to NRS 241.020(2)(D)(3)(I & II) this time is devoted to comments by the general public and possible discussion of those comments. No action may be taken upon a matter raised under this item until the matter has been included on a successive agenda pursuant to the required procedures at the discretion of the City in accordance with applicable law and identified as an action item.

**Municipal Code: 1-6-11: MANNER OF ADDRESSING BOARD; TIME LIMIT:**

Each person addressing the board shall first give his name and address for the records, and unless further time is granted by the presiding officer, shall limit his address to five (5) minutes. All remarks shall be addressed to the board as a body and not to any member thereof. No person, other than the mayor, the members of the board and the person having the floor, shall be permitted to enter into any discussion, either directly or through a member of the board, without the permission of the presiding officer. No question shall be asked except through the presiding officer. (Ord. 81, 9-10-1975, eff. 9-17-1975)

**PUBLIC COMMENT MAY BE TAKEN DURING DISCUSSION OF  
INDIVIDUAL AGENDA ITEMS.**

**2. POOL/PACT 2020-2021 Renewal (For Possible Action):**

- A) Review, discussion, and possible acceptance of renewal proposal from Nevada Public Agency Insurance Pool (POOL) and approval for payment from fiscal year 2020 - 2021 funds.

**3. Law Enforcement Services (For Possible Action):**

- A) Review, discussion, and possible consideration of hiring a full-time Chief of Police and maintaining the Carlin Police Department, or contracting law enforcement services with Elko County, and all related matters.

**4. Parcel Map Approval (For Possible Action):**

- A) Review, discussion, and possible approval of the Parcel Map Application for 1120 Green Street, Carlin, Nevada, Parcel # 002-210-057, and all related matters.

**5. Upcoming Events (For Possible Action):**

- A) Review, discussion, and possible action to approve or deny the purchasing of fireworks for the City of Carlin's July 4, 2020 celebration, and all related matters.
- B) Review, discussion, and possible approval of a memorandum regarding upcoming City events and how they may operate under Phase 2 and future Phase directives, and all related matters.

**6. APPROVAL of Expenditures (For Possible Action):**

- A) Review, discussion, and possible approval of City expenditures for the period of 05/23/2020-06/05/2020, and all related matters. The expenditure list can be requested by emailing City Manager Madison Mahon, [mmahon@cityofcarlin.com](mailto:mmahon@cityofcarlin.com),

**7. PUBLIC COMMENTS: (Non-Action Item)**

- A) Pursuant to NRS 241.020(2)(D)(3)(I & II) this time is devoted to comments by the general public and possible discussion of those comments. No action may be taken upon a matter raised under this item until the matter has been included on a successive agenda pursuant to the required procedures at the discretion of the City in accordance with applicable law and identified as an action item.

**8. Adjournment (For Possible Action):**

## **Call to Order and Roll Call**

### **Pledge of Allegiance**

- 1. Comment by the General Public (Non-Action Item):** Pursuant to NRS 241.020(2)(D)(3)(I & II) this time is devoted to comments by the general public and possible discussion of those comments. No action may be taken upon a matter raised under this item until the matter has been included on a successive agenda pursuant to the required procedures at the discretion of the City in accordance with applicable law and identified as an action item.



**2. POOL/PACT 2020-2021 Renewal (For Possible Action):**

- A) Review, discussion, and possible acceptance of renewal proposal from Nevada Public Agency Insurance Pool (POOL) and approval for payment from fiscal year 2020 - 2021 funds.



May 8, 2020

City of Carlin  
PO Box 787  
Carlin, NV 89822

RE: Pool renewal policy with NPAIP

Madison Mahon and the Carlin City Council

Enclosed please find your renewal documents and quote for the fiscal year July 1, 2020 to July 1, 2021, along with the invoice for the year. The POOL has expanded the information contained in this years proposal to incorporate the graphs, information on the State of the Insurance market, and Risk Management and Human Resources.

Please review the Risk Managment and Human Resources section of the proposal. POOL/PACT provides significant risk management services through extensive training, educational material, risk assessments, and grants that assist members navigate any challenges they may be facing. Contacts for these services can be found towards the end of the proposal. Any claims that can be avoided through the use of the risk management tools, will hopefully keep costs down in the future.

As was discussed in the annual meeting last month, the overall premiums for the memberships have increased for the 2020 term. Contributing factors are driven by a "hard" sellers' insurance market for both property and liability markets.

We thank you for your continued support of Gregory Insurance Agency and the POOL/PACT. Should you have any questions, please contact me.

Thank you

A handwritten signature in black ink, appearing to read 'Leah Gregory', is written over the printed name.

Leah Gregory

Gregory Insurance Agency  
775-738-7103 • fax 775-738-4563 • 800-631-3366





*poolpact.com*  
**The Power of the POOL**

# **NEVADA PUBLIC AGENCY INSURANCE POOL MEMBER COVERAGE SUMMARY**

---

**Prepared For:**

**Carlin, City of**

**Prepared By:**

**Gregory Insurance**

**THANK YOU FOR  
YOUR SERVICE!**



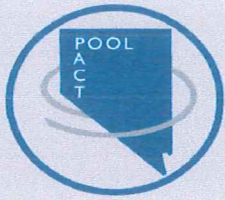

Dear POOL Member:

On behalf of all the POOL/PACT staff and Members, thank you for your continuing commitment to serving your communities. In unprecedented times your leadership and support make all of us stronger to fulfill our mission. The POOL remains committed to each Member's financial security and overall success.

We are pleased to provide this Member Coverage Summary for your review. One of the most significant changes for 2020-2021 fiscal year is the addition of a new separate POOL Cyber Risk Coverage Form and a revised POOL Coverage Form for property and liability coverage. Overall, these form changes enhance and clarify your POOL coverages.

The POOL continues to offer extensive risk management services, such as our premier POOL/PACT HR services. The POOL continually improves and increases enrollment in the Absorb eLearning program, Target Solutions Fire/EMS training, and KnowBe4 email security training. Currently, over 8,000 POOL Member's employees are enrolled in these POOL funded online training programs.

We encourage you to discuss the POOL's services with staff and your agent. Our website regularly is updated so please visit [www.poolpact.com](http://www.poolpact.com) to utilize a growing base of HR and risk management information as well as your coverage documents.

We extend our thanks to all Member volunteers who serve on our boards and committees. These volunteers do a superb job of representing the interests of the Members of your POOL.

Sincerely,

Wayne Carlson  
Executive Director  
Nevada Public Agency Insurance Pool



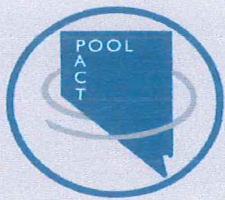

## NEVADA PUBLIC AGENCY INSURANCE POOL COVERAGE SUMMARY

RENEWAL PROPOSAL	COVERAGE PERIOD	NAMED ASSURED	MAINTENANCE DEDUCTIBLE
	07/01/2020 – 07/01/2021 Standard Time	Carlin, City of	\$ 500

### Property Coverage

Coverage	Limit per Loss	
Property	\$300,000,000	Per Schedule of Locations

The following sub-limits apply to Section V. C. Extensions of Property Coverage:

Accounts Receivable	\$5,000,000 per loss
Arson Reward	10% up to \$25,000 per loss
Debris Removal - Mold/ Asbestos	\$100,000
Earthquake	\$150,000,000 aggregate
Flood	\$150,000,000 aggregate \$25,000,000 aggregate - Flood Zone A
Equipment Breakdown	\$100,000,000 per loss
• Loss of Income & Extra Expense	included
• Hazardous Substance Coverage	\$250,000 per loss
• Spoilage Coverage	\$250,000 per loss
• Data Restoration	\$100,000 per loss
• Electrical Risk Improvements	\$10,000
Expediting Expenses	\$25,000 per loss
Unintentional Errors and Omissions	\$5,000,000 per loss
Money and Securities	\$500,000 per loss
Ordinance or Law – LEED Building	\$500,000
Agreed Value Vehicles	Per Attachment D, if applicable

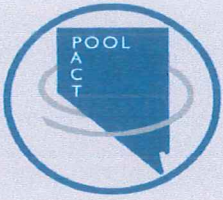

## NEVADA PUBLIC AGENCY INSURANCE POOL COVERAGE SUMMARY

### Liability Coverage

The Limits of Liability are as follows:

Coverage	Limit per Named Assured	Annual Aggregate Limit per Named Assured
<b>Per Event</b>	<b>\$10,000,000</b>	<b>\$10,000,000</b>
<i>All Sublimits are a part of and not in addition to the Limits of Liability.</i>		
<i>Liability Sublimits:</i>		
• Additional Insured (Lessors) (Section I, item 2)	\$2,000,000	
• Weed Spray Property Damage (Section IV, item 3 (B) (2) (ix))	\$250,000	\$250,000
• Emergency Response to Pollution (Section IV, item 3 (B) (2) (v))	\$1,000,000	\$1,000,000
• Criminal Defense Fees and Costs (Section VI, part C, item 4)	\$50,000	\$50,000
• Defense for Regulatory Agency Actions (Section VI, part C, item 16)	\$50,000	
<b>Sexual Abuse Sublimit</b> (Section VI, part C, item 21)	<b>\$2,500,000</b>	<b>\$2,500,000</b>
<b>Retroactive Date</b>	<i>May 1, 1987 except as shown in Attachment C</i>	



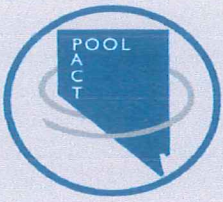

## NEVADA PUBLIC AGENCY INSURANCE POOL COVERAGE SUMMARY

### Cyber Risk Security Coverage

The Limits of Liability are as follows: Privacy or Security Liability Limits	\$3,000,000	Each Named Assured Member/Annual Member Aggregate
Security Failure/ Privacy Event Management Coverage Sublimit	\$100,000	Each Named Assured Member
Network Interruption Coverage Sublimit	\$250,000	Waiting Hours Period: 12 Hours
Proof of Loss Preparation Costs Sublimit	\$50,000	Each Named Assured Member
Retroactive Date: July 1, 2013		

### Environmental Liability Coverage

The Limits of Liability are as follows:

Coverage A	Third Party Claims for Bodily Injury, Property Damage or Remediation Expense
Coverage B	First Party Remediation Expense
Coverage C	Emergency Response Expense
Coverage D	Business Interruption

COVERAGE	DEDUCTIBLE	EACH INCIDENT LIMIT	AGGREGATE LIMIT
A,B,C	\$25,000	\$2,000,000	\$10,000,000

COVERAGE	DEDUCTIBLE	BUSINESS INTERRUPTION LIMIT (Days)	BUSINESS INTERRUPTION LIMIT (\$)
D	3 Days	365	\$2,000,000

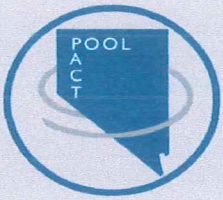

## NEVADA PUBLIC AGENCY INSURANCE POOL COVERAGE SUMMARY

### Member Contribution:

<b>Total Cost:</b>	<b>\$89,641.07</b>
<b>Agent Compensation:</b>	<b>\$6,273.54</b>
<b>Total Program Cost Including All POOL Services:</b>	<b>\$95,914.61</b>



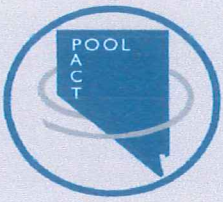

[poolpact.com](http://poolpact.com)  
**The Power of the POOL**

***NEVADA PUBLIC AGENCY INSURANCE POOL***

***Historical Member Data  
& Loss Experience***

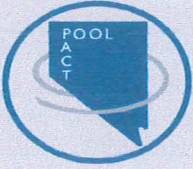

poolpact.com  
The Power of the POOL

## 2020 Member Exposure Data Carlin, City of

### 2020 NPAIP Total Program Cost

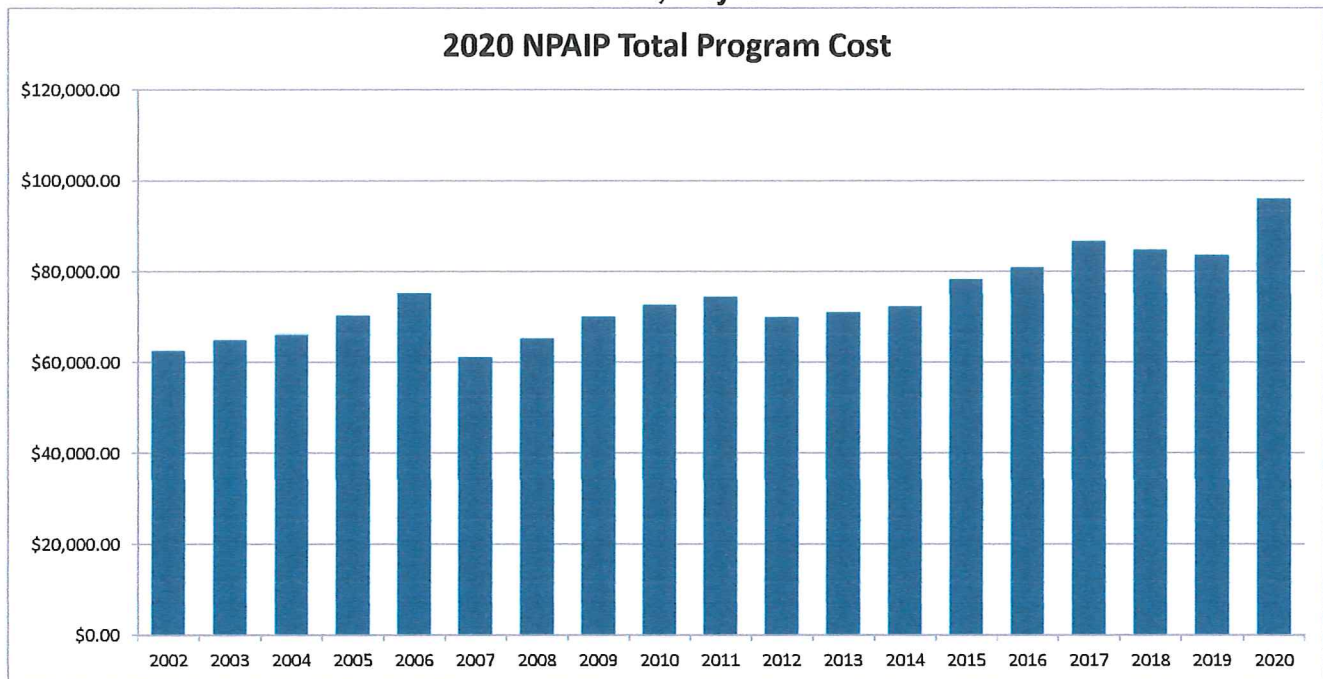

### 2020 Total Insured Values

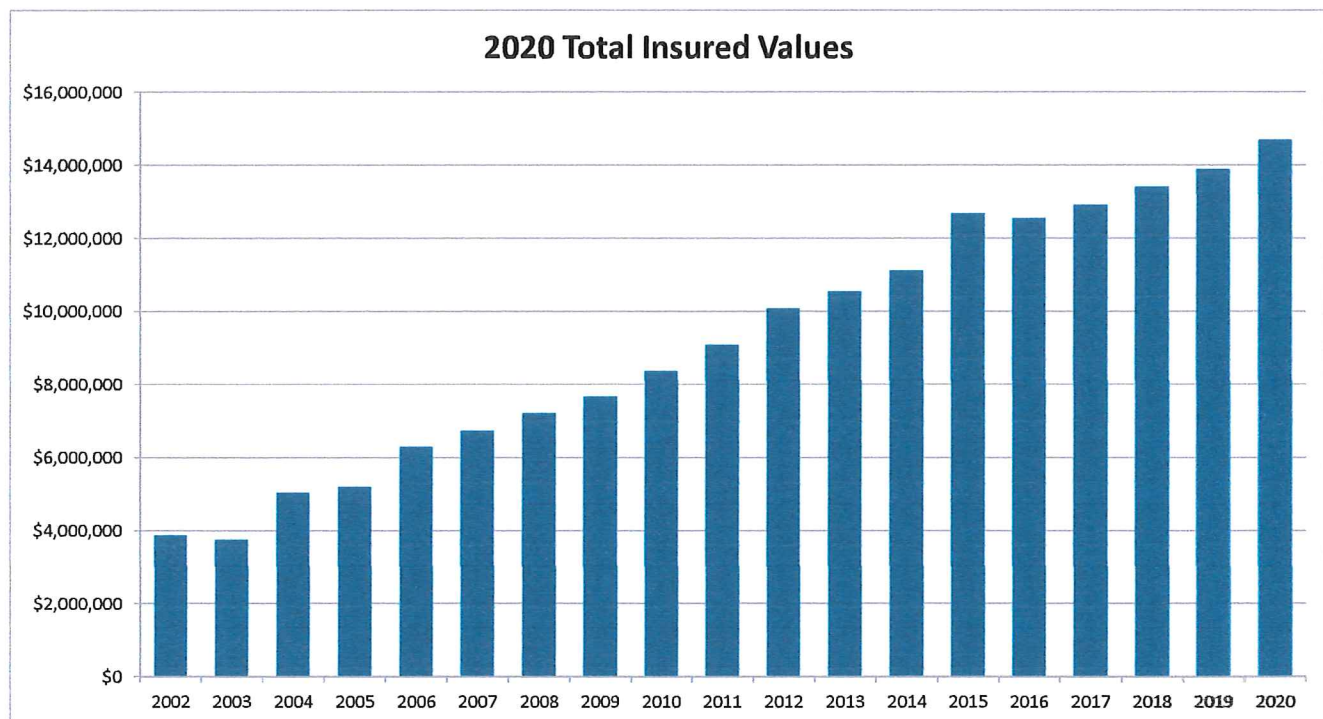



poolpact.com  
The Power of the POOL

## 2020 Member Exposure Data Carlin, City of

### 2020 Total Payroll



### 2020 Auto Count

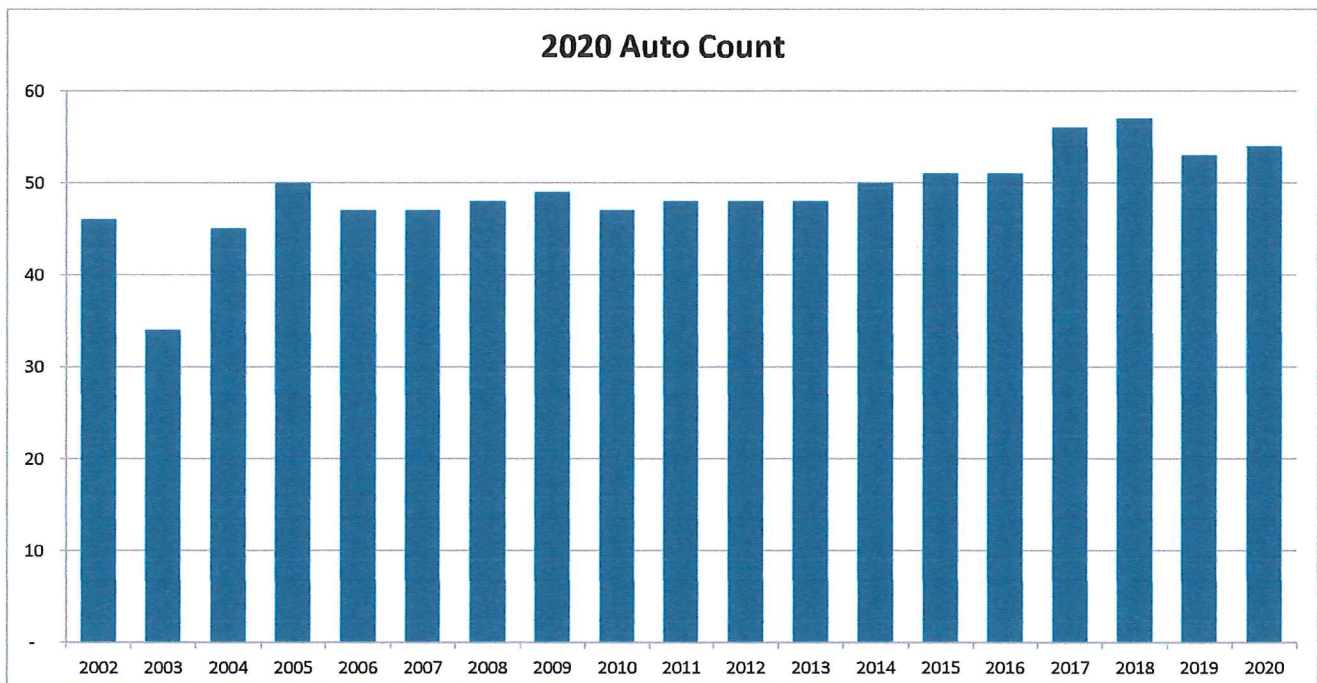





poolpact.com  
The Power of the POOL

**2020 Member Exposure Data**  
**Carlin, City of**

**2020 Officer Count**

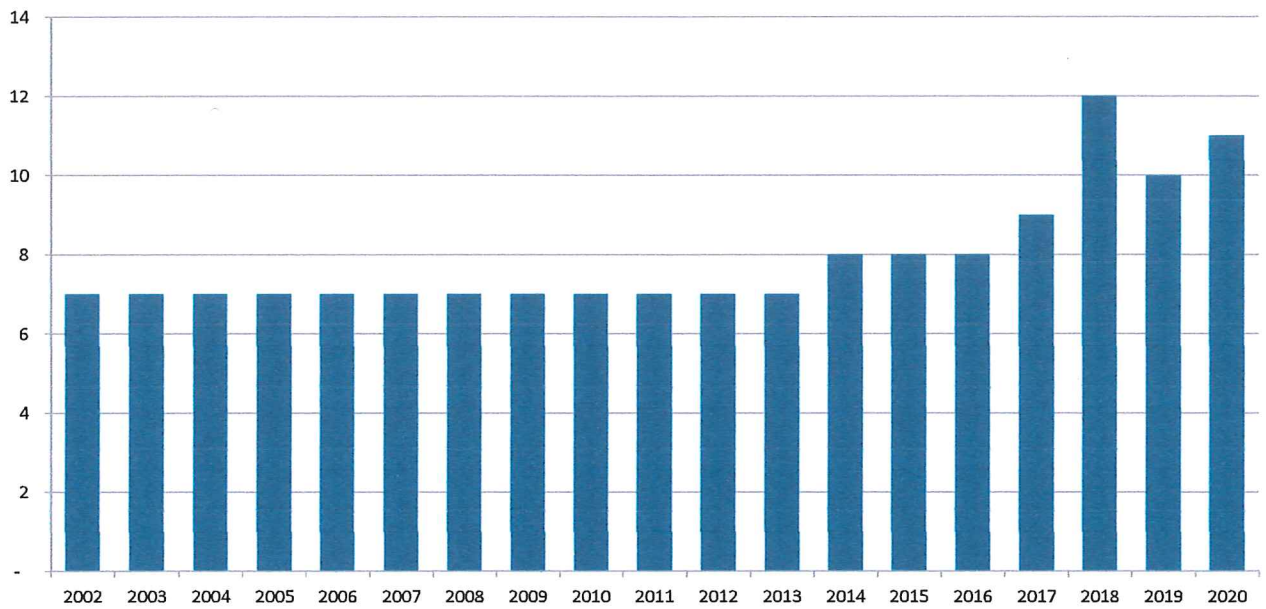





poolpact.com  
The Power of the POOL

**2020 Member Loss Data**  
**Carlin, City of**

**2020 Total Incurred Losses**

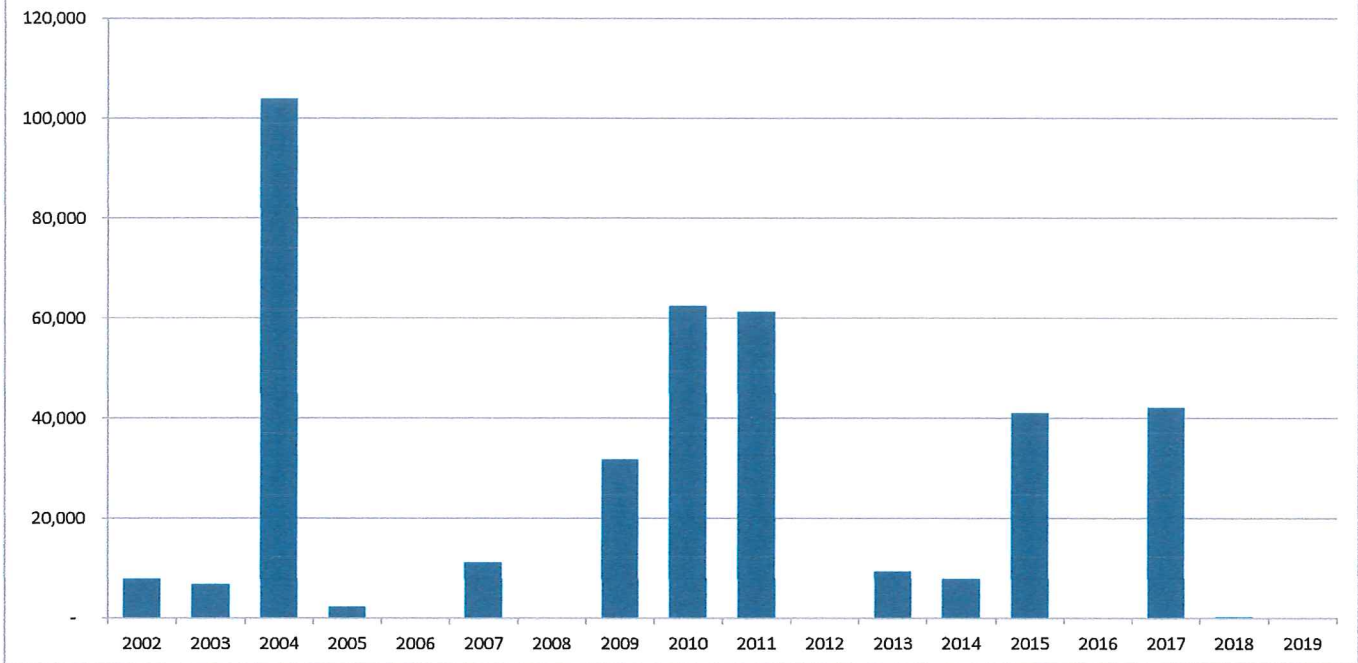

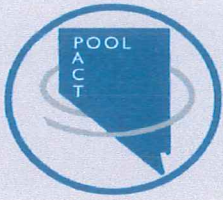

## STATE OF THE MARKET

### Property:

Two years of combined loss ratios exceeding 100%, along with the previous prolonged soft market, have driven the market correction and insurers' push to return to profitability.

The market is hardening and rate increases are accelerating with each succeeding month. Underwriters continue to take a more critical look at exposures, restricting many coverage terms previously offered in the soft market.

If we get through the next hurricane season without a major U.S. landfall one might expect that the good news for insurers would, as in the past, push the supply and demand curve eventually in the buyer's favor.

We also expect that rate increases and capacity deployment will become more predictable by the end of 2020 as most of the re-underwriting by major property insurers should be completed.

### Casualty:

The median settlement of the top 50 U.S. verdicts nearly doubled over the last four years (\$54M in 2018 vs. \$28M in 2014).

Reviver statutes that are aimed at abuse create a specter of unending litigation, legitimate and spurious, for schools, health care institutions and non-profits when statutes of limitations are abandoned or extended. Fear of the jury verdict wheel of fortune is also driving higher settlements.

Reinsurer feedback in the public entity sector largely concerns sexual abuse and molestation claims (SAM) as well as law enforcement and jail liability. Of note are exceedingly high demands and awards across the country, forcing underwriters to reevaluate both their limit and coverage offerings in risks where these exposures exist.



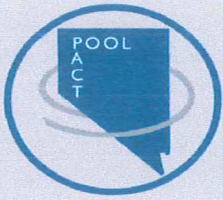

## POOL PACT – HERE FOR YOU

### Members Helping Members

In 1987, four Nevada counties formed their own risk sharing pool. Now over thirty years later, the majority of Nevada's rural public entities remain committed to each other and the mission of their risk pool organization. POOL/PACT continues to excel in providing an unparalleled level of service to our members. Our mission seeks to help members manage their risks so they can serve the public effectively.

The POOL Board is comprised of dedicated, hardworking, and ethical Member leaders focused on public risk management. They continue to do an excellent job of representing the interests of the Member-owners of POOL/PACT.

Our members continue to see great value in being part of the POOL/PACT because of extensive services, and that keeps membership retention strong. POOL/PACT encourages you to discuss the services we offer with your insurance agent – its valued partner in the POOL program.

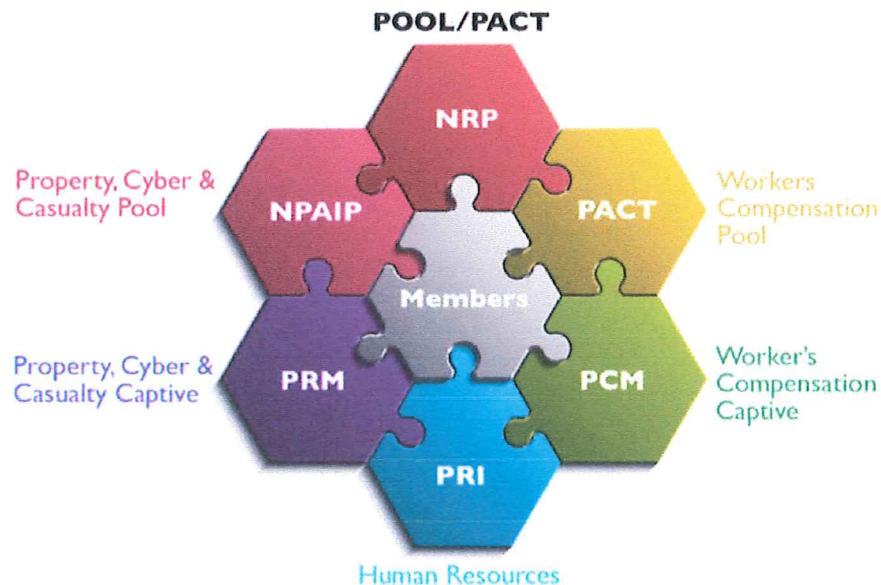

### POOL Executive Committee

Cash Minor - Chairman (Elko County)  
Josh Foli - Vice Chairman (Lyon County)  
Geoff Stark - Director (Churchill County)  
Dan Murphy - Director (Pershing Co.SD)  
Gina Rackley - Director (Humboldt Co)  
Ann Cyr - Director (Carson City SD)  
Gerry Eick - Director (Incline Village GID)

### PACT Executive Committee

Paul Johnson - Chairman (White Pine SD)  
Cash Minor - Vice Chairman (Elko County)  
Mike Giles - Director (City of Lovelock)  
Josh Foli - Director (Lyon County)  
Chris Mulkerns - Director (Town of Tonopah)  
Cindy Hixenbaugh - Director (Pershing GH)  
Elizabeth Frances - Director (White Pine County)

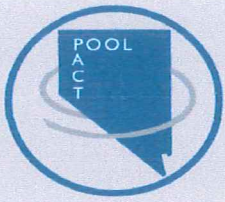

## **PROGRAMS AND SERVICES AVAILABLE TO POOL/PACT MEMBERS**

### **RISK MANAGEMENT**

#### **Training**

POOL/PACT provides extensive training. Here are some examples, visit [www.poolpact.com](http://www.poolpact.com) for more: Safe Driving Techniques • Blood Borne Pathogens • Ethics • Nevada Open Meeting Law • POOL/PACT 101 • Positive Governance

#### **eLearning**

POOL/PACT provides a dynamic eLearning platform, ongoing and timely learning courses, and support for:  
• Human Resources • Employee Safety • Cyber Security • Risk Management • Health and Wellness and more. • Emergency Medical Services • Fire Safety

#### **Risk Management On-Site Programs**

Risk Control Program Analysis • Infrared Thermography (IRT) • Safety Policies and Procedures Review • Site Surveys • OSHA Compliance Assistance • Safety and Loss Control Committees Review and Development • Traffic Safety Cones • Improved Security Systems • On-site Respirator Fit and Fire Extinguisher Training • Swimming Pool Safety Training and Inspections • School and Bus Safety Training. • Accident Investigation Claims Analysis • Hazard Communication Program Review and Development

#### **Law Enforcement and Fire Protection**

On-line Law Enforcement training, policies, and best practices from the Legal Liability Risk Management Institute • Fire and EMS training, policies, and best practices from TargetSolutions. Jail safety and best practice review is being provided to all members operating correction facilities.

#### **Risk Management Grant Program**

POOL/PACT provides Loss Control grants to help mitigate or eliminate risk to employees and liability exposure. Five, \$2,000 risk management grants are available to each member each year.

#### **24-7-365 Workers Comp Nurse Triage Program**

PACT members are eligible to use our innovative and streamed lined WC information and reporting system for non-life-threatening on-the-job injuries

#### **Cyber-Security**

All POOL members are provided a KnowBe4 online account subscription. Ongoing and updated Cyber Security training • Best Practices • Practice guidelines • Network assessments • Virtual Risk Officer

#### **MSDSonline**

OSHA and state compliance with safety data sheet management and updates are available online to ensure compliance and updated information.

For additional information contact Marshall Smith, POOL/PACT Risk Manager,  
(775) 885-7475 email: [marshallsmith@poolpact.com](mailto:marshallsmith@poolpact.com) website: [www.poolpact.com](http://www.poolpact.com)



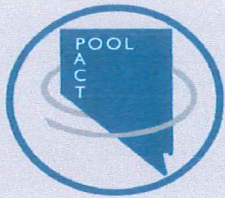

## **PROGRAMS AND SERVICES AVAILABLE TO POOL/PACT MEMBERS**

### **HUMAN RESOURCES**

A variety of services are offered through POOL/PACT HR. We work with each member individually to address their specific HR-related needs and reduce liability. The basic services include:

- Consultation with members to manage and resolve critical employment-related issues to include identifying options, providing step-by-step guidance, monitoring progress, and answering questions.
- Instructor-led training courses, workshops, and certificate programs.
- eLearning and live online training courses.
- Webinars on HR-related topics.
- On-site assessments of members' HR practices with recommendations.
- Communication issued as "Alerts" to notify members when a significant HR-related law or practice has changed.
- On-site HR Briefings tailored to specific needs/requests of members.
- Sample personnel policies which may be adopted for use by members.
- Sample job description templates and numerous HR forms that can be tailored for use by members.
- Salary schedule database available on our website for member reference.
- Summary of HR-related legislation produced each legislative session.
- HR Scholarships to assist member HR representatives in attaining nationally recognized HR certifications.
- Annual HR Conference providing HR representatives and CEOs valuable information on communication, leadership, and legal compliance.

For additional information contact Stacy Norbeck, POOL/PACT Human Resources Manager,  
(775) 885-7475 email: [stacynorbeck@poolpact.com](mailto:stacynorbeck@poolpact.com) website: [www.poolpact.com](http://www.poolpact.com)



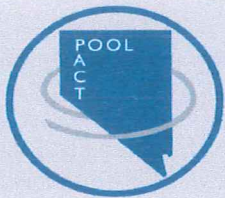

poolpact.com  
The Power of the POOL

## POOL PACT CONTACTS

### **Nevada Risk Pooling (NRP)** (775) 885 7475

Wayne Carlson, Executive Director  
[waynecarlson@poolpact.com](mailto:waynecarlson@poolpact.com)

Michael Rebaleati, Chief Operations Officer  
[mikerebaleati@poolpact.com](mailto:mikerebaleati@poolpact.com)

Alan Kalt, Chief Financial Officer  
[akalt@poolpact.com](mailto:akalt@poolpact.com)

Marshall Smith, Risk Manager  
[marshallsmith@poolpact.com](mailto:marshallsmith@poolpact.com)

Mike Van Houten, eLearning Administrator  
[eLearning@poolpact.com](mailto:eLearning@poolpact.com)

### **Willis Re Pooling**

Mary Wray, Executive Vice President  
(312) 288 7081  
[Mary.wray@willistowerswatson.com](mailto:Mary.wray@willistowerswatson.com)

Stephen Romero, Vice Preseident  
(775) 834 0201  
[Stephen.romero@willistowerswatson.com](mailto:Stephen.romero@willistowerswatson.com)

Amalia Lyons, Account Executive  
(614) 326 4944  
[Amalia.lyons@willistowerswatson.com](mailto:Amalia.lyons@willistowerswatson.com)

Courtney Giesseman, Vice President  
(614) 326 4739  
[Courtney.giesseman@willistowerswatson.com](mailto:Courtney.giesseman@willistowerswatson.com)

### **Davies Claims Solutions**

Donna Squires – Claims Manager  
(775) 329 1181  
[Donna.squires@ascrisk.com](mailto:Donna.squires@ascrisk.com)

Margaret Malzahn – WC Claims Supervisor  
(775) 329 1181  
[Margaret.malzahn@ascrisk.com](mailto:Margaret.malzahn@ascrisk.com)

### **Pooling Resources, Inc. (PRI)** (775) 887 2240

Stacy Norbeck, General Manager  
[stacynorbeck@poolpact.com](mailto:stacynorbeck@poolpact.com)

Jeff Coulam – Sr. HR Business Partner  
[jeffcoulam@poolpact.com](mailto:jeffcoulam@poolpact.com)



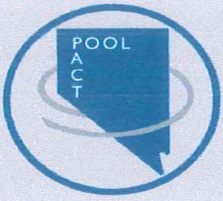

## NPAIP MEMBERSHIP

### Counties:

Churchill County  
Douglas County  
Elko County  
Esmeralda County  
Eureka County  
Humboldt County  
Lander County  
Lincoln County  
Lyon County  
Mineral County  
Nye County  
Pershing County  
Storey County  
White Pine County

### Towns:

Town of Gardnerville  
Town of Genoa  
Town of Minden  
Town of Pahrump  
Town of Round Mountain  
Town of Tonopah

### School Districts:

Carson City School District  
Churchill County School District  
Douglas County School District  
Elko County School District  
Esmeralda County School District  
Eureka County School District  
Humboldt County School District  
Lander County School District  
Lincoln County School District  
Lyon County School District  
Mineral County School District  
Nye County School District  
Pershing County School District  
Storey County School District  
White Pine County School District

### Cities:

Boulder City  
City of Caliente  
City of Carlin  
City of Elko  
City of Ely  
City of Fernley  
City of Lovelock  
City of Wells  
City of West Wendover  
City of Winnemucca  
City of Yerington

### Fire Districts:

Mt. Charleston Fire Protection District  
North Lake Tahoe Fire Protection District  
North Lyon County Fire Protection District  
Pahranagat Valley Fire District  
Tahoe Douglas Fire Protection District  
Washoe County Fire Suppression  
White Pine Fire District

### Others:

Central Nevada Historical Society  
Central Nevada Regional Water Authority  
County Fiscal Officers Association of Nevada  
Douglas County Redevelopment Agency  
Elko Central Dispatch  
Elko Convention & Visitors Authority  
Humboldt River Basin Water Authority  
Mineral County Housing Authority  
Nevada Association of Counties  
Nevada Commission for the Reconstruction of the V & T Railway  
Nevada League of Cities  
Nevada Risk Pooling, Inc.  
Nevada Rural Housing Authority  
Pooling Resources, Inc.  
Regional Transportation Commission of Washoe County  
Truckee Meadows Regional Planning Agency  
U.S. Board of Water Commissioners  
Virginia City Tourism Convention  
Western Nevada Regional Youth Center  
White Pine County Tourism

### Special Districts:

Alamo Water & Sewer District  
Amargosa Library District  
Beatty Library District  
Beatty Water & Sanitation District  
Canyon General Improvement District  
Carson-Truckee Water Conservancy District  
Carson Water Subconservancy District  
Churchill County Mosquito, Vector and Weed Control District  
Coyote Springs General Improvement District  
Douglas County Mosquito District  
Douglas County Sewer  
East Fork Swimming Pool District  
Elko County Agricultural Association  
Elko TV District  
Fernley Swimming Pool District  
Gardnerville Ranchos General Improvement District  
Gerlach General Improvement District  
Humboldt General Hospital  
Incline Village General Improvement District  
Indian Hills General Improvement District  
Kingsbury General Improvement District  
Lakeridge General Improvement District  
Lincoln County Water District  
Logan Creek Estates General Improvement District  
Lovelock Meadows Water District  
Marla Bay General Improvement District  
Mason Valley Swimming Pool District  
Minden Gardnerville Sanitation District  
Moapa Valley Water District  
Nevada Association of Conservation Districts  
Nevada Association of School Boards  
Nevada Association of School Superintendents  
Nevada Tahoe Conservation District  
Northern Nye County Hospital District  
Pahrump Library District  
Palomino Valley General Improvement District  
Pershing County Water Conservation District  
Sierra Estates General Improvement District  
Silver Springs General Improvement District  
Silver Springs Stagecoach Hospital  
Skyland General Improvement District  
Smoky Valley Library District  
Southern Nevada Area Communication Council  
Southern Nevada Health District  
Stagecoach General Improvement District  
Sun Valley General Improvement District  
Tahoe Douglas District  
Topaz Ranch General Improvement District  
Tahoe Reno Industrial General Improvement District  
Tonopah Library District  
Walker Basin Conservancy  
Walker River Irrigation District  
Washoe County Water Conservation District  
West Wendover Recreation District  
Western Nevada Development District  
White Pine Television District #1  
Zephyr Cove General Improvement District  
Zephyr Heights General Improvement District

**THANK YOU  
FOR YOUR  
MEMBERSHIP!**



**3. Law Enforcement Services (For Possible Action):**

- A) Review, discussion, and possible consideration of hiring a full-time Chief of Police and maintaining the Carlin Police Department, or contracting law enforcement services with Elko County, and all related matters.



## Occupational Employment Statistics

## Occupational Employment and Wages, May 2019 \* National, not State

## 33-1012 First-Line Supervisors of Police and Detectives

Directly supervise and coordinate activities of members of police force.

[National estimates for this occupation](#)

[Industry profile for this occupation](#)

[Geographic profile for this occupation](#)

**National estimates for this occupation: [Top](#)**

Employment estimate and mean wage estimates for this occupation:

Employment <a href="#">(1)</a>	Employment RSE <a href="#">(3)</a>	Mean hourly wage	Mean annual wage <a href="#">(2)</a>	Wage RSE <a href="#">(3)</a>
121,340	0.5 %	\$45.65	\$94,950	0.6 %

Percentile wage estimates for this occupation:

Percentile	10%	25%	50% (Median)	75%	90%
Hourly Wage	\$25.15	\$32.77	\$43.79	\$57.20	\$70.47
Annual Wage <a href="#">(2)</a>	\$52,320	\$68,170	\$91,090	\$118,970	\$146,580

**Industry profile for this occupation: [Top](#)**

Industries with the highest published employment and wages for this occupation are provided. For a list of all industries with employment in this occupation, see the [Create Customized Tables](#) function.

Industries with the highest levels of employment in this occupation:

Industry	Employment <a href="#">(1)</a>	Percent of industry employment	Hourly mean wage	Annual mean wage <a href="#">(2)</a>
<a href="#">Local Government, excluding schools and hospitals (OES Designation)</a>	97,490	1.76	\$44.57	\$92,710
<a href="#">State Government, excluding schools and hospitals (OES Designation)</a>	13,180	0.61	\$48.30	\$100,470
<a href="#">Federal Executive Branch (OES Designation)</a>	5,980	0.30	\$61.89	\$128,720
<a href="#">Colleges, Universities, and Professional Schools</a>	3,320	0.11	\$39.98	\$83,160
<a href="#">Junior Colleges</a>	620	0.09	\$39.33	\$81,810

Industries with the highest concentration of employment in this occupation:

Industry	Employment <a href="#">(1)</a>	Percent of industry employment	Hourly mean wage	Annual mean wage <a href="#">(2)</a>
<a href="#">Local Government, excluding schools and hospitals (OES Designation)</a>	97,490	1.76	\$44.57	\$92,710
<a href="#">State Government, excluding schools and hospitals (OES Designation)</a>	13,180	0.61	\$48.30	\$100,470
<a href="#">Federal Executive Branch (OES Designation)</a>	5,980	0.30	\$61.89	\$128,720
<a href="#">Colleges, Universities, and Professional Schools</a>	3,320	0.11	\$39.98	\$83,160
<a href="#">Junior Colleges</a>	620	0.09	\$39.33	\$81,810

Top paying industries for this occupation:

Industry	Employment <a href="#">(1)</a>	Percent of industry employment	Hourly mean wage	Annual mean wage <a href="#">(2)</a>
<a href="#">Federal Executive Branch (OES Designation)</a>	5,980	0.30	\$61.89	\$128,720
<a href="#">State Government, excluding schools and hospitals (OES Designation)</a>	13,180	0.61	\$48.30	\$100,470
<a href="#">Local Government, excluding schools and hospitals (OES Designation)</a>	97,490	1.76	\$44.57	\$92,710
<a href="#">Specialty (except Psychiatric and Substance Abuse) Hospitals</a>	40	0.01	\$43.42	\$90,300
<a href="#">Postal Service (federal government)</a>	170	0.03	\$42.28	\$87,930





## Occupational Employment Statistics Query System



## Occupational Employment Statistics

[\(For more information or help\)](#)

## Multiple occupations for one geographical area

[Back to Inputs](#)Area: Nevada  
Period: May 2019

Occupation (SOC code)	Employment <sup>(1)</sup>	Employment percent relative standard error <sup>(3)</sup>	Hourly mean wage	Annual mean wage <sup>(2)</sup>	Wage percent relative standard error <sup>(3)</sup>	Hourly 10th percentile wage	Hourly 25th percentile wage	Hourly median wage	Hourly 75th percentile wage	Hourly 90th percentile wage	Annual 10th percentile wage <sup>(2)</sup>	Annual 25th percentile wage <sup>(2)</sup>	Annual median wage <sup>(2)</sup>	Annual 75th percentile wage <sup>(2)</sup>	Annual 90th percentile wage <sup>(2)</sup>	Employment per 1,000 jobs	Location Quotient
First-Line Supervisors of Police and Detectives(331012)	970	0.8	50.72	105500	1.7	36.73	42.98	50.38	59.36	67.08	76400	89390	104800	123460	139530	0.700	0.85
Police and Sheriff's Patrol Officers(333051)	5250	0.6	35.41	73660	2.6	25.85	28.70	34.94	42.91	47.70	53760	59690	72660	89250	99210	3.768	0.83

## Footnotes:

(1) Estimates for detailed occupations do not sum to the totals because the totals include occupations not shown separately. Estimates do not include self-employed workers.

(2) Annual wages have been calculated by multiplying the corresponding hourly wage by 2,080 hours.

(3) The relative standard error (RSE) is a measure of the reliability of a survey statistic. The smaller the relative standard error, the more precise the estimate.

SOC code: Standard Occupational Classification code -- see <http://www.bls.gov/soc/home.htm>

Data extracted on June 03, 2020



## Occupational Employment Statistics

## May 2019 State Occupational Employment and Wage Estimates

## Nevada

These occupational employment and wage estimates are calculated with data collected from employers in all industry sectors in metropolitan and nonmetropolitan areas in Nevada.

Additional information, including the hourly and annual 10th, 25th, 75th, and 90th percentile wages and the employment percent relative standard error, is available in the [downloadable XLS file](#).

[Links to OES estimates for other areas and States](#)

Major Occupational Groups in Nevada (**Note**--clicking a link will scroll the page to the occupational group):

- 00-0000 [All Occupations](#)
- 11-0000 [Management Occupations](#)
- 13-0000 [Business and Financial Operations Occupations](#)
- 15-0000 [Computer and Mathematical Occupations](#)
- 17-0000 [Architecture and Engineering Occupations](#)
- 19-0000 [Life, Physical, and Social Science Occupations](#)
- 21-0000 [Community and Social Service Occupations](#)
- 23-0000 [Legal Occupations](#)
- 25-0000 [Educational Instruction and Library Occupations](#)
- 27-0000 [Arts, Design, Entertainment, Sports, and Media Occupations](#)
- 29-0000 [Healthcare Practitioners and Technical Occupations](#)
- 31-0000 [Healthcare Support Occupations](#)
- 33-0000 [Protective Service Occupations](#)
- 35-0000 [Food Preparation and Serving Related Occupations](#)
- 37-0000 [Building and Grounds Cleaning and Maintenance Occupations](#)
- 39-0000 [Personal Care and Service Occupations](#)
- 41-0000 [Sales and Related Occupations](#)
- 43-0000 [Office and Administrative Support Occupations](#)
- 45-0000 [Farming, Fishing, and Forestry Occupations](#)
- 47-0000 [Construction and Extraction Occupations](#)
- 49-0000 [Installation, Maintenance, and Repair Occupations](#)
- 51-0000 [Production Occupations](#)
- 53-0000 [Transportation and Material Moving Occupations](#)



To sort this table by a different column, click on the column header

Display All records

Filter Table by Text: Text search table: police

Occupation code	Occupation title (click on the occupation title to view its profile)	Level	Employment	Employment RSE	Employment per 1,000 jobs	Location quotient	Median hourly wage	Mean hourly wage	Annual mean wage	Mean wage RSE
33-1012	<a href="#">First-Line Supervisors of Police and Detectives</a>	detail	970	0.8%	0.700	0.85	\$50.38	\$50.72	\$105,500	1.7%
33-3051	<a href="#">Police and Sheriff's Patrol Officers</a>	detail	5,250	0.6%	3.768	0.83	\$34.94	\$35.41	\$73,660	2.6%
33-3052	<a href="#">Transit and Railroad Police</a>	detail	(8)	(8)	(8)	(8)	\$35.90	\$36.04	\$74,970	2.7%
43-5032	<a href="#">Dispatchers, Except Police, Fire, and Ambulance</a>	detail	2,390	7.7%	1.718	1.27	\$16.84	\$18.26	\$37,980	2.5%

Showing 1 to 4 of 4 entries (filtered from 674 total entries)

[About May 2019 National, State, Metropolitan, and Nonmetropolitan Area Occupational Employment and Wage Estimates](#)

(1) Estimates for detailed occupations do not sum to the totals because the totals include occupations not shown separately. Estimates do not include self-employed workers.

(2) Annual wages have been calculated by multiplying the hourly mean wage by a "year-round, full-time" hours figure of 2,080 hours; for those occupations where there is not an hourly wage published, the annual wage has been directly calculated from the reported survey data.

(3) The relative standard error (RSE) is a measure of the reliability of a survey statistic. The smaller the relative standard error, the more precise the estimate.

(4) Wages for some occupations that do not generally work year-round, full time, are reported either as hourly wages or annual salaries depending on how they are typically paid.

(5) This wage is equal to or greater than \$100.00 per hour or \$208,000 per year.

(8) Estimates not released.



(9) The location quotient is the ratio of the area concentration of occupational employment to the national average concentration. A location quotient greater than one indicates the occupation has a higher share of employment than average, and a location quotient less than one indicates the occupation is less prevalent in the area than average.

[top](#)

Nevada's metropolitan and nonmetropolitan area estimates:

- [Carson City, NV](#)
- [Las Vegas-Henderson-Paradise, NV](#)
- [Reno, NV](#)
- [Nevada nonmetropolitan area](#)

[May 2019 National Occupational Employment and Wage Estimates](#)

[May 2019 State Occupational Employment and Wage Estimates](#)

[May 2019 Metropolitan and Nonmetropolitan Area Occupational Employment and Wage Estimates](#)

[May 2019 National Industry-Specific Occupational Employment and Wage Estimates](#)

[May 2019 Occupation Profiles](#)

[Technical notes](#)

**Last Modified Date:** March 31, 2020

U.S. BUREAU OF LABOR STATISTICS Division of Occupational Employment Statistics PSB Suite 2135 2 Massachusetts Avenue NE Washington, DC 20212-0001

Telephone: 1-202-691-6569 [www.bls.gov/OES](http://www.bls.gov/OES) [Contact OES](#)

[Find jobs](#)[Company reviews](#)[Find salaries](#)[Upload your resume](#)[Sign in](#)[Employers / Post Job](#)

## Chief of Police

[League of Minnesota Cities](#) - Oak Park Heights, MN

\$81,904 - \$117,006 a year

### League of Minnesota Cities

4 reviews

Read what people are saying about working here.

Apply Now

♡ Save this job

📄 Copy link

#### Job Posting

##### General Duties:

The City is initiating a search process for a new Chief of Police. The current Chief is retiring after 25+ years of continual service to the City and thirteen years as the Chief. The position is expected to lead the Police Department in its continual pursuit of excellence in law enforcement and public service.

The City's Police Department consists of 11 full time staff with 10 sworn officers and 1 records / reception. The rank structure of the department is Chief of Police with 2 sergeants; with an Annual Budget of \$1.5+/- million. The Department is a well-trained and seasoned staff that is strongly supported by a stable City Council.

The City is accepting applications and seeking interested candidates from both internal and external sources so as to develop comprehensive pool candidates. It is desired that the new Chief would assume duties on or about November 30th, 2020.

##### Contact Information:

Eric Johnson, City Administrator

[eajohnson@cityofoakparkheights.com](mailto:eajohnson@cityofoakparkheights.com)

Full Announcement Information can be found: [www.cityofoakparkheights.com](http://www.cityofoakparkheights.com)

League of Minnesota Cities - Today - [report job](#)

- [original job](#)

[Chief of Police jobs in Oak Park Heights, MN](#)

[Jobs at League of Minnesota Cities in Oak Park Heights, MN](#)

[Chief of Police salaries in Oak Park Heights, MN](#)



# Oak Park Heights, Minnesota

**Oak Park Heights** is a city in Washington County, Minnesota, United States. The population was 4,339 at the 2010 census.<sup>[5]</sup>

# Contents

## History

## Geography

## Demographics

2010 census

2000 census

## References

## History

Formerly called simply Oak Park, the city was platted in 1857.<sup>[6][7]</sup> The 1932 Log Cabin restaurant and 1939 Stillwater Overlook are listed on the National Register of Historic Places.<sup>[8]</sup>

# Geography

According to the United States Census Bureau, the city has a total area of 3.03 square miles (7.85 km<sup>2</sup>); 2.98 square miles (7.72 km<sup>2</sup>) is land and 0.05 square miles (0.13 km<sup>2</sup>) is water.<sup>[9]</sup>

Oak Park Heights is located adjacent to the city of Stillwater. Minnesota State Highways 5, 36 and 95 are three of the main routes in the community.

## Demographics

## 2010 census

As of the census<sup>[2]</sup> of 2010, there were 4,339 people, 1,842 households, and 980 families living in the city. The population density was 1,456.0 inhabitants per square mile (562.2/km<sup>2</sup>). There were 2,039 housing units at an average density

## Oak Park Heights

## City

Motto(s): "Tree City USA"

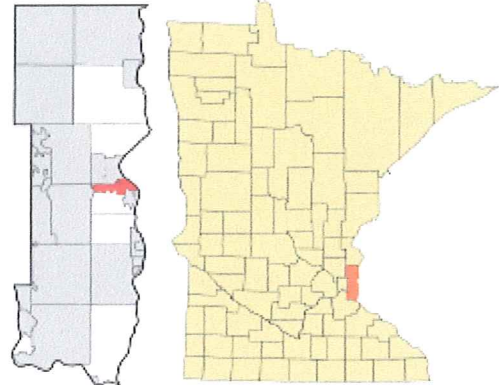

Location of the city of Oak Park Heights  
within Washington County, Minnesota

Coordinates: 45°2'6"N 92°48'38"W

<b>Country</b>	United States
<b>State</b>	Minnesota
<b>County</b>	Washington
<b>Area</b> <sup>[1]</sup>	
• <b>Total</b>	3.31 sq mi (8.58 km <sup>2</sup> )
• <b>Land</b>	2.90 sq mi (7.50 km <sup>2</sup> )
• <b>Water</b>	0.42 sq mi (1.08 km <sup>2</sup> )
<b>Elevation</b>	784 ft (239 m)
<b>Population</b> (2010) <sup>[2]</sup>	
• <b>Total</b>	4,339
• <b>Estimate</b> (2018) <sup>[3]</sup>	4,910
• <b>Density</b>	1,698.20/sq mi (655.79/km <sup>2</sup> )
<b>Time zone</b>	UTC-6 (Central (CST))
• <b>Summer (DST)</b>	UTC-5 (CDT)
<b>ZIP code</b>	55082
<b>Area code(s)</b>	651
<b>FIPS code</b>	27-47914
<b>GNIS feature ID</b>	0648850 <sup>[4]</sup>
<b>Website</b>	<a href="http://www.cityofoakparkheights.com">www.cityofoakparkheights.com</a> ( <a href="http://www.cityofoakparkheights.com/">http://www.cityofoakparkheights.com/</a> )

## Historical population

Census	Pop.	%±
--------	------	----

[Find jobs](#)[Company reviews](#)[Find salaries](#)[Upload your resume](#)[Sign in](#)[Employers / Post Job](#)

## City of Blair Police Captain

City of Blair, Nebraska - Blair, NE

\$35.74 - \$40.89 an hour

\$68,xxx - \$81,780

Apply Now

♡ Save this job

Copy link

### Captain

**Reports to:** Chief of Police

**Department:** Police Department

**Updated:** August 31, 2018

**Job Code:**

**FLSA Status:** Exempt

**EEOC Class:** Service Workers

**Please note:** In order to be considered for this position, you must complete an application on our website directly at <http://blairnebraska.org/jobs.aspx>

### Job Summary

The Captain is responsible for executing on the strategies and directives established by the Chief of Police in accordance with departmental policies and procedures. This includes managing the day-to-day operations of the Police Department to include Officers, Sergeants, Detectives, Administrative Personnel, Animal Control, etc.

### Essential Job Responsibilities

- Manage the day-to-day operations of the police department
- Review schedules and ensure adequate coverage is available for 24/7 operations.
- Review daily activity to include reports, logs and other activity and submit to the Chief of Police for final review.
- Act as a Subject-Matter-Expert (SME) and serve as an escalation point for staff and field supervisors.
- Maintain training records for all staff and ensure compliance with state and federal regulations.
- Review and participate in the interviewing of candidates as part of the hiring process.
- Review ongoing investigations and coordinate with assigned detectives for courses of action.
- Act in the Chief's capacity when the Chief of Police is not available.
- Conduct in-field reviews of staff ensuring their duties are being performed within the standards established by the department.
- Identify opportunities for process improvement and make recommendations to the Chief of Police for policy changes.
- Act as a liaison between the City of Blair Police Department and the community
- Coordinate the activities of various community outreach programs (e.g., citizen's police academy, bicycle rodeo, etc.).
- Promote a positive interaction when the department is interacting with the community.
- Engage with community members on a regular basis to promote an active presence of the Police Department.
- Lead and participate in donation drives to help offset costs of departmental operations.
- Performs other duties as needed

**Education**

- Minimum of a Bachelor's degree in Criminal Justice or related degree required.

**Experience**

- Minimum seven years of progressively responsible experience in law enforcement to include a minimum of three years as a field supervisor.
- An equivalent combination of education and experience sufficient to successfully perform the job duties and responsibilities.

**Certifications and Licenses**

- Nebraska Law Enforcement Certification is required.
- Nebraska Law Enforcement Management Certification is required.
- Nebraska Law Enforcement Supervision Certification is required.

**Work Environment**

- Work is performed in both a casual, open office environment geared towards collaboration, and outside. Exposure to heat, cold, dust, dirt, wetness, or other elements may be required.

**Travel**

- Less than 5% travel is required.

Job Type: Full-time

Pay: \$35.74 - \$40.89 per hour

- 28 days ago - [report job](#)

If you require alternative methods of application or screening, you must approach the employer directly to request this as Indeed is not responsible for the employer's application process.

[Police Captain jobs in Blair, NE](#)

[Jobs at City of Blair in Blair, NE](#)

[Police Captain salaries in Blair, NE](#)



# Blair, Nebraska

**Blair** is a city in and the county seat of Washington County, Nebraska, United States.<sup>[5]</sup> The population was 7,990 at the 2010 census. Blair is a part of the Omaha-Council Bluffs Metropolitan Statistical Area.

## Contents

- History
- Geography
- Demographics
  - 2010 census
  - 2000 census
- Media
- Points of interest
- Education
- Notable people
- See also
- References
- External links

## History

Blair was platted in 1869 when the Sioux City and Pacific Railroad was extended to that point.<sup>[6]</sup> It was named for railroad magnate John Insley Blair, who was credited with bringing the railroad to town.<sup>[7]</sup> Blair was incorporated as a city in 1872.<sup>[8]</sup> Within its first year, Blair was designated county seat.<sup>[6]</sup>

In March 1869, a small child playing on a railroad turntable in town was injured on the turntable. The father sued the railway for damages, leading all the way up to the Supreme Court of the United States in the 1873 case Sioux City & Pacific Railroad Co. v. Stout.

In 1874, during the Panic of 1873, a grasshopper storm enveloped the region. Many Nebraskans were faced with starvation. An organization, the Nebraska Relief and Aid Society was formed in order to help affected persons. A law was passed by congress awarding \$100,000 relief, and many

### Blair, Nebraska

City



Washington Street

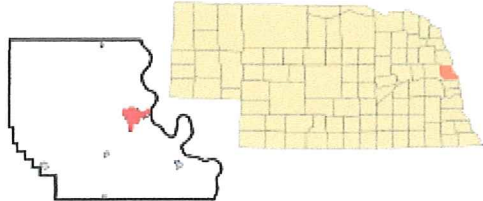

Location of Blair within Washington County and Nebraska

Coordinates: 41°32′44″N 96°8′4″W

<b>Country</b>	United States
<b>State</b>	Nebraska
<b>County</b>	Washington
<b>Government</b>	
<span> </span> • <b>Type</b>	Mayor-council government
<span> </span> • <b>Mayor</b>	Rich Hansen
<b>Area</b> <sup>[1]</sup>	
<span> </span> • <b>Total</b>	5.53 <span> </span> sq <span> </span> mi (14.31 <span> </span> km <sup>2</sup> )
<span> </span> • <b>Land</b>	5.51 <span> </span> sq <span> </span> mi (14.27 <span> </span> km <sup>2</sup> )
<span> </span> • <b>Water</b>	0.02 <span> </span> sq <span> </span> mi (0.04 <span> </span> km <sup>2</sup> )
<b>Elevation</b>	1,070 <span> </span> ft (326 <span> </span> m)
<b>Population</b> (2010) <sup>[2]</sup>	
<span> </span> • <b>Total</b>	7,990
<span> </span> • <b>Estimate</b> (2018) <sup>[3]</sup>	7,815
<span> </span> • <b>Density</b>	1,468.69/sq <span> </span> mi (567.03/km <sup>2</sup> )
<b>Time zone</b>	UTC-6 (Central (CST))
<span> </span> • <b>Summer (DST)</b>	UTC-5 (CDT)

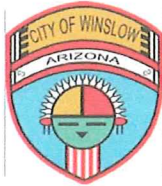

## Police Chief

City of Winslow | Winslow, Arizona, United States  
27 days ago

APPLY NOW



### Description

#### SUMMARY

Under administrative direction, the Police Chief performs a variety of complex administrative, supervisory and professional work in planning, coordinating, and directing the activities of the Police Department. Performs primary and exclusive responsibility over all administrative and internal affairs, command, and supervision over all police personnel, dispatching functions, and enforcement of all State laws and City ordinances.

This position is an at-will employment position per the Winslow Municipal Code Section 3.16.020. Application period ends June 12, 2020.

**ESSENTIAL FUNCTIONS** -- *Essential functions, as defined under the Americans with Disabilities Act, may include any of the following representative duties, knowledge, and skills. This list is ILLUSTRATIVE ONLY and is not a comprehensive listing of all functions and duties performed by incumbents of this class. Employees are required to be in attendance and prepared to begin work at their assigned work location on the specified days and hours. Factors such as regular attendance at the job are not routinely listed in job descriptions but are an essential function. Essential duties and responsibilities may include, but are not limited to, the following:*

- Plans, organizes, and directs the activities of professional, technical, and clerical personnel engaged in police department operations; coordinates, supervises, and evaluates police department operations.
- Develops and establishes policies and procedures for the department in order to implement directives from the City Council or City Manager.
- Plans and implements law enforcement programs for the City in order to better carry out the policies and goals of City management and Council; reviews department performance and effectiveness; formulates programs or policies to alleviate deficiencies.
- Coordinates the information gathered and work accomplished by various officers; assigns Officers to special investigations as needed.
- Ensures that personnel are assigned to shifts or working units which provide optimum effectiveness in terms of current situations and circumstances governing deployment.
- Evaluates evidence, witnesses, and suspects in criminal cases to correlate all aspects and to assess for trends, similarities or for associations with other cases.
- Supervises and coordinates the preparation and presentation of an annual budget for the department, directs the implementation of the department's budget, plans, for and reviews specifications for new or replaced equipment.
- Directs the development and maintenance of systems, records, and legal documents that provide for the proper evaluation, control, and documentation of police department operations.
- Trains and develops departmental personnel; addresses grievances; maintains departmental discipline and general conduct and behavior of assigned personnel.
- Prepares and submits periodic reports to the City Manager regarding the department's activities and prepares a variety of other reports as appropriate.
- Meets with elected and appointed officials, other law enforcement officials, community and business representatives, and the public on all aspects of the department's activities.
- Attends conferences, seminars, and meetings to keep abreast of current trends in the field; represents the City Police Department in a variety of local, County, State, and other meetings.
- Interviews and hires candidates for positions within the department.
- Cooperates with County, State, and Federal law enforcement officers as appropriate where activities of the police department are involved.
- Ensures that laws and ordinances are enforced and that the public peace and safety is maintained.
- Performs related duties as assigned or required.

### Job Information

Job ID: 53987355

#### Location:

Winslow, Arizona, United States

Position Title: Police Chief

Company Name: City of Winslow

Agency Type: Local Law Enforcement  
(municipal/county/regional)

Job Function: Law Enforcement - Chief Executive

Min Education: BA/BS/Undergraduate

Min Experience: Over 10 Years

Required Travel: 0-10%

Salary: \$80,070.00 - \$100,953.00 (Yearly Salary)

years or progressively responsible law enforcement experience, which includes three (3) years at a Lieutenant or higher rank; OR an equivalent combination of education, training, or experience.

**Knowledge of:**

- Applicable local, State, and Federal laws, codes, regulations, and ordinances.
- Modern law enforcement principles, procedures, techniques, and equipment.
- Leadership and management principles and practices.
- Budget development, forecasting, and implementation practices, procedures, and methods.
- Police department operations and emergency dispatch functions.

**Skill in:**

- Preparing clear and concise reports.
- Developing and implementing effective policies and procedures.
- Interacting tactfully and professionally with City staff, outside agencies, and the public.
- Providing effective supervision, leadership, and direction to assigned personnel.
- Developing and administering budgets.
- Exercising sound judgment in evaluating situations and in making decisions.
- Establishing and maintaining effective working relationships.
- Communicating effectively both verbally and in writing.

**LICENSE AND CERTIFICATION REQUIREMENTS**

**Must possess a valid Arizona driver's license.**

Must possess an Arizona Peace Officer Standards and Training (POST) Board Peace Officer certification.

**PHYSICAL DEMANDS AND WORKING ENVIRONMENT**

Work is performed in a standard office environment. Some occasional field work may be required, which includes exposure to various outdoor weather conditions, firearms, airborne particles, and caustic chemicals.

The work environment and physical demands described here are representative of those an employee encounters while performing the essential functions of this job. Reasonable accommodations may be made to enable individuals with disabilities to perform the essential functions



**City of Winslow**  
Government  
Winslow, AZ, US

The mission of the Winslow city government is to provide leadership and services that foster a healthy community, while striving for customer satisfaction. The Winslow Police Department has a FY17 operational budget of approximately \$3,600,000. The personnel of the Police Department consists of the Chief, 2 Lieutenants, 5 Sergeants, 15 Police Officers and support staff of 10 in communications and other support units. The Department also consists of Animal Control which includes 1 Animal Control Officer, 1 full-time and 1 p...

[View Full Profile](#)

**Jobs You May Like**



**Police Officer: Recruits and Late...**  
Northern Arizona University...  
Flagstaff, AZ, United States

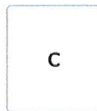

**Chief of Police**  
City of Arlington  
Arlington, TX, United States



**Director**  
The Uni  
Martin,



# Winslow, Arizona

**Winslow** (Navajo: *Béésh Sinil*) is a city in Navajo County, Arizona, in the United States. According to the 2010 census, the population of the city is 9,655.<sup>[2]</sup> It is approximately 57 miles (92 km) SE of Flagstaff, 240 miles (390 km) W of Albuquerque, New Mexico, and 329 miles (529 km) SE of Las Vegas.

## Contents

### History

### Demographics

### Geography and climate

### Education

### Transportation

### Main sights

### Historical events

9-11 Remembrance Gardens

### In popular culture

### Media

Radio

Television

### Notable people

### See also

### Additional Reading

### References

### External links

## History

Winslow was named for either Edward F. Winslow, president of St. Louis and San Francisco Rail Road, which owned half of the old Atlantic and Pacific Railroad, or Tom Winslow, a prospector who lived in the area.<sup>[4]</sup>

The last Harvey House (La Posada Hotel), designed by Mary Colter, opened in 1930. The hotel closed in 1957 and was used by the Santa Fe Railway for offices. The railroad abandoned La Posada in 1994 and announced plans to tear it down. It was bought and restored by Allan Affeldt<sup>[5]</sup> and it serves as a hotel.<sup>[6]</sup>

U.S. Route 66 was originally routed through the city. A contract to build Interstate 40 as a bypass north of Winslow was awarded at the end of 1977. I-40 replaced U.S. Route 66 in Arizona in its entirety.

### Winslow

#### City

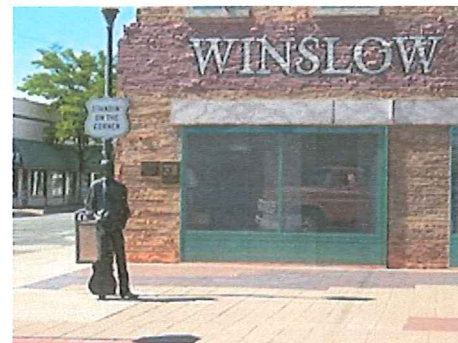

Standin' on the Corner Park and mural

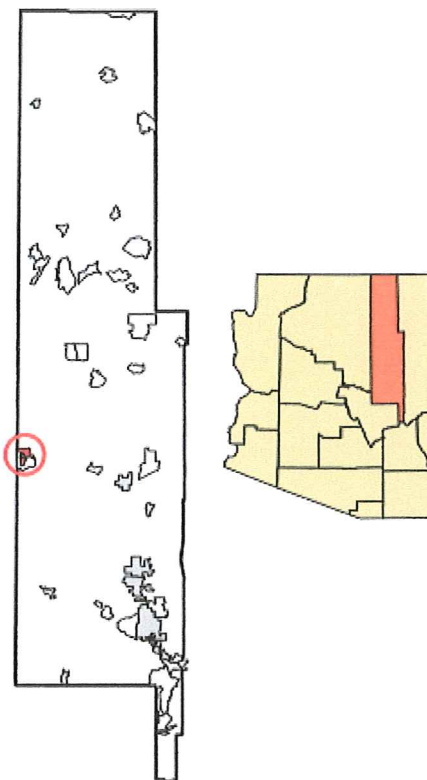

Location of Winslow in Navajo County, Arizona.

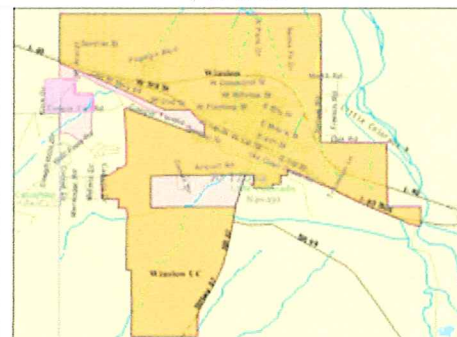

U.S. Census Map

**4. Parcel Map Approval (For Possible Action):**

- A) Review, discussion, and possible approval of the Parcel Map Application for 1120 Green Street, Carlin, Nevada, Parcel # 002-210-057, and all related matters.



## **CITY OF CARLIN**

**151 S. 8<sup>th</sup> Street**  
**PO Box 787**  
**Carlin, Nevada 89822**  
**775-754-6354**  
**775-754-6912 FAX**  
**[www.cityofcarlin.com](http://www.cityofcarlin.com)**

May 21, 2020

Madison,

At the special Carlin Planning Board meeting on May 20, 2020, the Board unanimously voted to approve the Parcel Map Application for Parcel # 002-210-057. Please put this on the next Carlin City Agenda.

Thank you,

Melinda Harris

Planning Board Secretary

Assistant City Clerk





CITY OF CARLIN

151 S 8TH ST  
CARLIN, NV 89822  
+1 775-754-6354

*parcel  
map*

Subtotal \$225.00

Total \$ 225<sup>00</sup>

PAYMENT ID:

Hide Details

Card:

Method: INTERNET TRANSACTION

Authorization Code:

Authorizing Network:

DATE

MAR 24 PAID



MAR 25 PAID



**CITY OF CARLIN,  
NEVADA**

P.O. Box 787, 151 South 8<sup>th</sup> Street, Carlin, NV 89822  
Phone (775) 754-6354 Fax (775) 754-6912

**APPLICATION FOR  
PARCEL MAP APPROVAL**

**ASSESSOR'S PARCEL NUMBER:** APN 002-210-057

**APPLICANT(s):** RH Construction Services

**APPLICANT(s) ADDRESS:** 3427 Jennings Way

**City, State, Zip** Elko Nevada 89801

**APPLICANT(s) PHONE:** 1-775-778-9205  
Home Business Fax

**LEGAL OWNER:** DFA, LLC

**OWNER'S ADDRESS:** P.O. Box 270665

**City, State, Zip** Las Vegas Nevada 89127

**OWNER'S PHONE:** Home Business Fax

**APPLICANT'S SURVEYOR:** Robert E. Morley 6203  
NV License #

**SURVEYOR'S ADDRESS:** 640 Idaho Street

**City, State, Zip** Elko Nevada 89801

**SURVEYOR'S PHONE:** 738-4053  
Home Business Fax

Note: If legal owner is different from the applicant, legal owner consent, in writing, must be provided.

**LEGAL DESCRIPTION OF PROPERTY (attach if necessary):** \_\_\_\_\_

Parcel 1, Parcel Map, File No. 739518.



**CITY OF CARLIN, NEVADA**  
**APPLICATION FOR PARCEL MAP APPROVAL**

1. Identify the existing zoning of the property: LI
2. Identify the type and nature of the use proposed on each parcel: Uses allowed within LI zoning
3. Identify the source of water supply and proposed method of sewage disposal for each parcel: City of Carlin sewer and water

I, the applicant(s) (or authorized agent or employer of the applicant) being first duly sworn, deposes and says that all of the statements contained in this document are true.

Signature: \_\_\_\_\_

**FILING REQUIREMENTS:**

1. Completed application form.
2. One (1) mylar, Four (4) 24"x32" copy and one (1) 8 1/2"x11" or 11"x17" copy of the proposed parcel map, completed in accordance with Nevada Revised Statutes and local ordinances. Parcel map to include a vicinity map.
3. Copy of survey computations.
4. If the property is improved, Four (4) 24"x36" copy and one (1) 8 1/2"x11" or 11"x17" copy of a plot plan showing proposed property lines, existing buildings, building setbacks, parking and loading areas and any other pertinent information.
5. The applicant is encouraged to provide other information and documentation supporting the approval of the parcel map.
6. Filing fee calculated as follows: \$200.00 plus \$25.00 per lot.
7. All information to be provided a minimum of fifteen (15) calendar days prior to a regularly scheduled Planning Commission meeting.

**OFFICE USE ONLY**

Date Filed: 5/8/2020 Fee Paid: \_\_\_\_\_ Pmt Type: \_\_\_\_\_ Rec'd by: MA

KNOWN OF ALL MEN BY THESE PRESENTS THAT THE UNDERSIGNED, DON ALFONSO, MANAGER OF D.F.A. LLC, BEING THE OWNER OF THOSE PARCELS AS SHOWN ON THIS MAP, DOES HEREBY CONSENT TO THE PREPARATION AND RECORRATION OF THIS MAP AND GIVE CONSENT TO THE DEDICATION OF THE STREETS AND EASEMENTS FOR PUBLIC ACCESS AND PUBLIC UTILITY PURPOSES AS DESIGNATED HEREON. IN WITNESS WHEREOF, THE OWNER, SET MY HAND ON THE DATE SHOWN.

DFA, LLC

STATE OF NEVADA  
COUNTY OF ELKO

THIS INSTRUMENT WAS ACKNOWLEDGED BEFORE ME ON THE \_\_\_\_\_ DAY  
OF \_\_\_\_\_, 2020, BY DON AHERN, MANAGER OF DFA, LLC.

SURVEYOR'S CERTIFICATE

1. ROBERT E. WOLEY, A PROFESSIONAL LAND SURVEYOR LICENSED IN THE STATE OF NEVADA, CERTIFY THAT:

1. THIS PLAT REPRESENTS THE RESULTS OF A SURVEY CONDUCTED UNDER MY DIRECT SUPERVISION AT THE INSTANCE OF DON AHERN, MANAGER OF DTA, LLC.

2. THE LANDS SURVEYED LIE WITHIN SECTION 32, T.33 N., R. 52 E., S.20. N. & W., AND THE SURVEY WAS COMPLETED ON MARCH 6, 1935.

3. THIS PLAT COMPLIES WITH THE APPLICABLE STATE STATUTES AND ANY FEDERAL LAWS IN EFFECT ON THE DATE THAT THE GOVERNING BODY GAVE ITS FINAL APPROVAL.

4. THE MONUMENTS DEPICTED ON THE PLAT ARE OF THE CHARACTER SHOWN, IN POSITION, POSITIONED AND ARE OF SUFFICIENT NUMBER AND DURABILITY TO PERMANENTLY MARK THE CORNERS.



ROBERT S. MONLEY, P.L.S. 0203

APPROVAL – CITY OF CARLIN  
PLANNING COMMISSION

AT A REGULAR MEETING OF THE PLANNING COMMISSION OF THE CITY OF CARLIN, STATE OF NEVADA, HELD ON THE DAY OF, 2020, THIS MAP WAS APPROVED FOR SUBDIVISION PURPOSES PURSUANT TO N.R.S. 278.461 - 278.489 INCLUSIVE AND ALL APPLICABLE LOCAL ORDINANCES.

**CHAIRMAN**

APPROVAL – CITY OF CARLIN  
BOARD OF COUNCILMEN

AT A REGULAR MEETING OF THE BOARD OF COUNCILMEN OF THE CITY OF CARLIN, STATE OF NEVADA, HELD ON THE        DAY OF        2020, THIS MAP WAS APPROVED FOR SUBDIVISION PURPOSES PURSUANT TO N.R.S. 278.481 - 278.488 INCLUSIVE AND ANY LOCAL ORDINANCES APPLICABLE AT THE TIME OF APPROVAL, AND ANY OFFERS OF DEDICATION SHOWN HEREON WERE ACCEPTED FOR PUBLIC USE.

MAYOR, CITY OF CARLIN, NEVADA

CLOCK: ATTEST

## CITY SURVEYOR'S CERTIFICATE

I, \_\_\_\_\_, CITY SURVEYOR FOR THE CITY OF CARLIN, NEVADA, DO HEREBY CERTIFY THAT I HAVE EXAMINED THIS MAP AND FIND THAT ALL PROVISIONS OF N.R.S. 278.010 - 278.030, INCLUSIVE, AND ALL LOCAL ORDINANCES APPLICABLE AT THE TIME OF APPROVAL HAVE BEEN COMPLIED WITH, AND THAT I AM SATISFIED THAT THIS MAP IS TECHNICALLY CORRECT.

DATE \_\_\_\_\_



13 JUL 1975

PARCEL MAP  
FOR  
DEA LLC

SECTION 22, T.33 N., R.52 E., M.D.B.& M.  
ELKO COUNTY, NEVADA

 **HIGH DESERT  
ENGINEERING,  
LLC** 640 IDAHO STREET  
ELKO, NEVADA 89801  
(775) 738-4053 **220014**

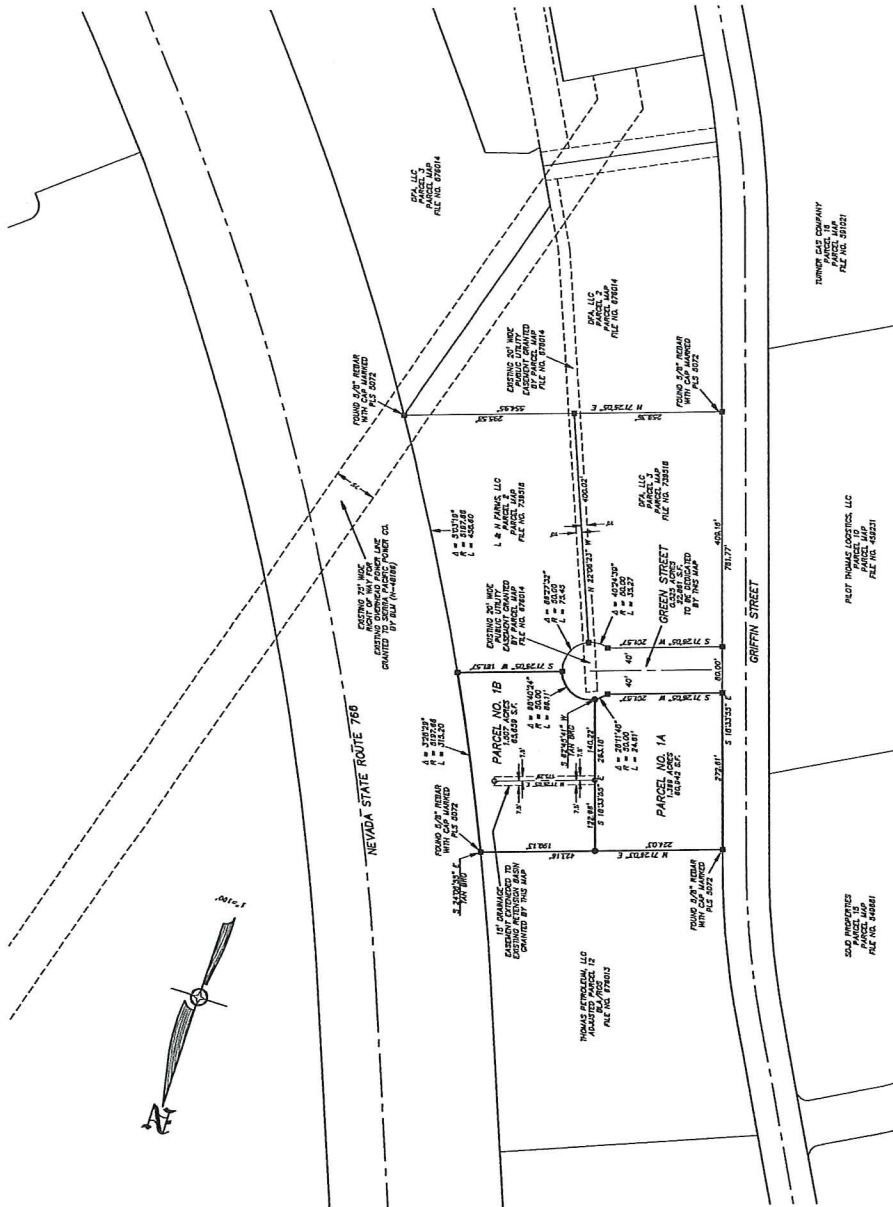

## LEGEND

- = FOUND 8/8" WITH CAP MARKED PLS 6203 UNLESS OTHERWISE NOTED.
- = SET 8/8" RECAR WITH CAP MARKED PLS 6203.
- = CALCULATED POINT, NOTHING FOUND, NOTHING SET.

## FILED DATA

FILE NO. \_\_\_\_\_  
FILED AT THE REQUEST OF  
HIGH DECENT ENGINEERING.  
DATE \_\_\_\_\_, 2020  
TIME \_\_\_\_\_, P.M.  
D. MIKE SMITH  
ELKO COUNTY RECORDER

## APPROVAL - PUBLIC UTILITIES

THE PUBLIC UTILITY EASEMENTS, AS DESIGNATED HEREON, ARE APPROVED BY THE RESPECTIVE UTILITIES EXECUTING BELOW.

## COUNTY TREASURER'S CERTIFICATE

I, CHERYL PAUL, CERTIFY THAT ALL PROPERTY TAXES ON PARCEL NO. 062-210-037 HAVE BEEN PAID FOR THIS FISCAL YEAR.

## COUNTY ASSESSOR'S CERTIFICATE

I, KATRINKA S. RUSSELL, HEREBY CERTIFY THAT THE ASSessor's PARCEL NUMBERS SHOWN ON THIS PLAN ARE CORRECT AND THAT THE PROPOSED PARCELS ARE A DIVISION OF SAID ASSessor'S PARCEL NO 002-210-037.

ELKO COUNTY ASSESSOR	DATE
----------------------	------

## NOTES:

- [illegible]

Parcels 1A-1B.txt

-----  
Parcel name: Parcel No. 1A

North: 12246.753 East : 15866.671  
Line Course: N 71-26-03 E Length: 224.03  
North: 12318.083 East : 16079.042  
Line Course: S 18-33-55 E Length: 263.18  
North: 12068.598 East : 16162.835  
Curve Length: 24.61 Radius: 50.00  
Delta: 28-11-48 Tangent: 12.56  
Chord: 24.36 Course: S 48-39-47 W  
Course In: S 27-14-19 E Course Out: N 55-26-07 W  
RP North: 12024.143 East : 16185.720  
End North: 12052.510 East : 16144.545  
Line Course: S 71-26-05 W Length: 201.57  
North: 11988.333 East : 15953.465  
Line Course: N 18-33-55 W Length: 272.61  
North: 12246.757 East : 15866.670

Perimeter: 986.00 Area: 60,942 S.F. 1.399 acres

Mapcheck Closure - (Uses listed courses, radii, and deltas)

Error Closure: 0.004 Course: N 19-04-19 W  
Error North: 0.0037 East : -0.0013  
Precision 1: 246,500.00

-----  
Parcel name: Parcel No. 1B

North: 12318.083 East : 16079.042  
Line Course: N 71-26-03 E Length: 199.13  
North: 12381.484 East : 16267.809  
Curve Length: 315.19 Radius: 5197.66  
Delta: 3-28-28 Tangent: 157.65  
Chord: 315.16 Course: S 25-51-09 E  
Course In: N 65-53-05 E Course Out: S 62-24-37 W  
RP North: 14505.112 East : 21011.845  
End North: 12097.883 East : 16405.228  
Line Course: S 71-26-05 W Length: 181.57  
North: 12040.074 East : 16233.107  
Curve Length: 86.11 Radius: 50.00  
Delta: 98-40-24 Tangent: 58.21  
Chord: 75.86 Course: N 67-54-07 W  
Course In: S 71-26-05 W Course Out: N 27-14-19 W  
RP North: 12024.155 East : 16185.709  
End North: 12068.610 East : 16162.824  
Line Course: N 18-33-55 W Length: 263.18  
North: 12318.095 East : 16079.031



Parcels 1A-1B.txt

Perimeter: 1045.20 Area: 65,659 S.F. 1.507 acres

Mapcheck Closure - (Uses listed courses, radii, and deltas)

Error Closure: 0.017 Course: N 41-52-45 W

Error North: 0.0123 East : -0.0111

Precision 1: 61,481.18

-----  
Parcel name: Total

North: 12381.486 East : 16267.813

Line Course: S 71-26-03 W Length: 191.59

North: 12320.484 East : 16086.194

Line Course: S 71-26-03 W Length: 231.57

North: 12246.754 East : 15866.675

Line Course: S 18-33-55 E Length: 272.61

North: 11988.330 East : 15953.470

Line Course: N 71-26-05 E Length: 201.57

North: 12052.507 East : 16144.551

Curve Length: 32.18 Radius: 50.00

Delta: 36-52-12 Tangent: 16.67

Chord: 31.62 Course: N 52-59-59 E

Course In: S 55-26-07 E Course Out: N 18-33-55 W

RP North: 12024.140 East : 16185.725

End North: 12071.538 East : 16169.806

Curve Length: 78.54 Radius: 50.00

Delta: 90-00-00 Tangent: 50.00

Chord: 70.71 Course: S 63-33-55 E

Course In: S 18-33-55 E Course Out: N 71-26-05 E

RP North: 12024.140 East : 16185.725

End North: 12040.059 East : 16233.123

Line Course: N 71-26-05 E Length: 181.57

North: 12097.869 East : 16405.244

Curve Length: 315.19 Radius: 5197.66

Delta: 3-28-28 Tangent: 157.65

Chord: 315.16 Course: N 25-51-09 W

Course In: N 62-24-37 E Course Out: S 65-53-05 W

RP North: 14505.098 East : 21011.861

End North: 12381.470 East : 16267.826

Perimeter: 1504.83 Area: 126,601 S.F. 2.906 acres

Mapcheck Closure - (Uses listed courses, radii, and deltas)

Error Closure: 0.020 Course: S 37-35-02 E

Error North: -0.0160 East : 0.0123

Precision 1: 75,241.00

## CHAPTER 5

### DIMENSIONAL REGULATIONS

## SECTION:

## 3-5-1: Table Of Dimensional Controls

3-5-1: TABLE OF DIMENSIONAL CONTROLS <sup>1</sup> :

Zoning District	Minimum Lot Size	Minimum Lot Frontage	Front Yard	Each Side Yard	Rear Yard	Floor Area Ratio
Rural residence and farming	2 acres	200 feet	40 feet	25 feet**	35 feet	—
Neighborhood residence	7,500 square feet	75 feet	12 feet	5 feet	5 feet	—
Intermediate residence	5,000 square feet***	50 feet	12 feet	5 feet	5 feet	—
Tourist commercial	—	—	—	—	—	0.25*
Commercial	—	—	—	—	—	0.5
Light industrial	—	—	40 feet	35 feet	40 feet	0.5
* Floor area ratio – the ratio of <u>Total floor space in building</u> Total land area on lot						
** Permitted institutional uses in residence districts must have 25 foot side yards.						
*** 1,200 square feet per additional unit.						

(Ord. 172, 3-11-1992)

## Notes

- <sup>1</sup> 1. See illustrated examples in section 3-1-3 of this title.

**5. Upcoming Events (For Possible Action):**

- A) Review, discussion, and possible action to approve or deny the purchasing of fireworks for the City of Carlin's July 4, 2020 celebration, and all related matters.
- B) Review, discussion, and possible approval of a memorandum regarding upcoming City events and how they may operate under Phase 2 and future Phase directives, and all related matters.





City of Carlin  
151 S. 8<sup>th</sup> Street  
Carlin, NV 89822

---

**June 3, 2020**

**To:** City of Carlin Equestrian Board, Parks and Recreation Board, and all interested parties

**From:** Madison Mahon, City Manager, as approved by the Carlin City Council on \_\_\_\_\_.

In light of COVID-19 and upcoming spring and summer events, all City of Carlin boards must abide by current and future directives as ordered by Governor Sisolak to limit and eliminate potential claims of liability against the City. The Silver State Stabilization Phase, also known as Phase 2, allows for recreational activities to resume, so long as they are in accordance with local, state, and federal guidance. Should City Boards decide to pursue event planning during Phase 2 and future Phases as directed by the Governor, they must keep the following in mind:

1. **REQUIRED:** 50 people or less
2. **REQUIRED:** 6-Foot social distancing, including staggered seating
3. **REQUIRED:** Sanitization of high-touch surfaces
4. **PREFERRED:** Open-air spaces, outdoor events
5. **PREFERRED:** Face coverings



City of Carlin  
151 S. 8<sup>th</sup> Street  
Carlin, NV 89822



Steve Sisolak  
Governor of Nevada

# Phase 2

## Statewide Standards: Individuals

**FACE COVERINGS** are strongly encouraged in public and when around persons from other households

All Nevadans are encouraged to continue **STAYING AT HOME** and limit trips outside of their homes as much as practicable to mitigate the spread of COVID-19

Maintain at least **SIX FEET OF SOCIAL DISTANCING** per person for non-household members at all times

**ALL VULNERABLE INDIVIDUALS** should continue to shelter in place. Members of households with vulnerable residents should be aware that by returning to work or other environments where distancing is not practical, they could carry the virus back home. Precautions should be taken to isolate from vulnerable residents

**PUBLIC & PRIVATE GATHERINGS** are limited to **50 or fewer people at a given time**. Face coverings should be worn by all individuals

Avoid **SOCIALIZING** in groups of more than 10 people in circumstances that do not readily allow for appropriate physical distancing

**VISITS TO SENIOR LIVING FACILITIES**, long-term care facilities, and nursing homes should continue to be prohibited

An individual who tests positive for COVID-19 must **QUARANTINE** and stay at home for two weeks

If determined to be a **CONTACT OF AN INDIVIDUAL** who tested positive for COVID-19, an individual must quarantine and stay at home for two weeks, or until a negative test result has been received

**UNSAFE HOMES:** Individuals whose homes/residences are unsafe or become unsafe, such as victims of domestic violence, are expressly permitted and urged to leave their homes and stay at a safe alternative location

**6. APPROVAL of Expenditures (For Possible Action):**

- A) Review, discussion, and possible approval of City expenditures for the period of 05/23/2020-06/05/2020, and all related matters. The expenditure list can be requested by emailing City Manager Madison Mahon, [mmahon@cityofcarlin.com](mailto:mmahon@cityofcarlin.com),



## Report Criteria:

Detail report.

Invoices with totals above \$0.00 included.

Paid and unpaid invoices included.

Vendor	Vendor Name	Invoice Number	Description	GL Account and Title	Invoice Date	Net Invoice Amount	Amount Paid	Date Paid
<b>10-22750</b>								
3007	WELLS FARGO BANK BY MAIL	PR0510201	Retirement Police Pay Period: 5/	10-22750 RETIREMENT PAYABLE	06/02/2020	2,734.21	.00	
3007	WELLS FARGO BANK BY MAIL	PR0510201	Retire Reg - Employee Pd Pay P	10-22750 RETIREMENT PAYABLE	06/02/2020	1,037.14	.00	
3007	WELLS FARGO BANK BY MAIL	PR0510201	Retire Reg - Employee Pd Pay P	10-22750 RETIREMENT PAYABLE	06/02/2020	1,037.14	.00	
3007	WELLS FARGO BANK BY MAIL	PR0510201	Retire Reg Employer Paid Pay P	10-22750 RETIREMENT PAYABLE	06/02/2020	7,511.15	.00	
3007	WELLS FARGO BANK BY MAIL	PR0510201	Retirement Legislative Pay Perio	10-22750 RETIREMENT PAYABLE	06/02/2020	317.38	.00	
3007	WELLS FARGO BANK BY MAIL	PR0524201	Retirement Police Pay Period: 5/	10-22750 RETIREMENT PAYABLE	06/03/2020	2,734.21	.00	
3007	WELLS FARGO BANK BY MAIL	PR0524201	Retire Reg - Employee Pd Pay P	10-22750 RETIREMENT PAYABLE	06/03/2020	1,042.54	.00	
3007	WELLS FARGO BANK BY MAIL	PR0524201	Retire Reg - Employee Pd Pay P	10-22750 RETIREMENT PAYABLE	06/03/2020	1,042.54	.00	
3007	WELLS FARGO BANK BY MAIL	PR0524201	Retire Reg Employer Paid Pay P	10-22750 RETIREMENT PAYABLE	06/03/2020	6,912.38	.00	
Total 10-22750:						24,368.69	.00	
<b>10-22755</b>								
1793	GREAT AMERICAN FINANCIAL	PR0510201	457 Pay Period: 5/10/2020	10-22755 457 PAYABLE	06/02/2020	1,400.00	.00	
1793	GREAT AMERICAN FINANCIAL	PR0524201	457 Pay Period: 5/24/2020	10-22755 457 PAYABLE	06/03/2020	100.00	.00	
Total 10-22755:						1,500.00	.00	
<b>10-22760</b>								
2193	METLIFE SMALL BUSINESS CE	PR0510201	DENTAL AND LIFE INSURANCE	10-22760 HEALTH INSURANCE PAYAB	06/02/2020	1,188.66	.00	
2193	METLIFE SMALL BUSINESS CE	PR0510201	DENTAL AND LIFE INSURANCE	10-22760 HEALTH INSURANCE PAYAB	06/02/2020	1.23	.00	
2193	METLIFE SMALL BUSINESS CE	PR0510201	DENTAL AND LIFE INSURANCE	10-22760 HEALTH INSURANCE PAYAB	06/02/2020	81.90	.00	
2193	METLIFE SMALL BUSINESS CE	PR0510201	DENTAL AND LIFE INSURANCE	10-22760 HEALTH INSURANCE PAYAB	06/02/2020	130.36	.00	
3544	SIERRA HEALTH AND LIFE	PR0510201	Health Ins. Pay Period: 5/10/2020	10-22760 HEALTH INSURANCE PAYAB	06/02/2020	14,786.76	.00	
3544	SIERRA HEALTH AND LIFE	PR0510201	Health Ins. Pay Period: 5/10/2020	10-22760 HEALTH INSURANCE PAYAB	06/02/2020	715.63	.00	
2969	VISION SERVICE PLAN, NV	PR0510201	Vision Ins Pay Period: 5/10/2020	10-22760 HEALTH INSURANCE PAYAB	06/02/2020	218.68	.00	
2969	VISION SERVICE PLAN, NV	PR0510201	Vision Ins Pay Period: 5/10/2020	10-22760 HEALTH INSURANCE PAYAB	06/02/2020	25.39	.00	
Total 10-22760:						17,148.61	.00	
<b>10-22770</b>								
1053	AMERICAN FAMILY LIFE ASSUR	PR0510201	AFLAC Pre-tax Pay Period: 5/10/	10-22770 INSURANCE PAYABLE	06/02/2020	184.13	.00	
1053	AMERICAN FAMILY LIFE ASSUR	PR0510201	AFLAC/Tax Pay Period: 5/10/202	10-22770 INSURANCE PAYABLE	06/02/2020	85.14	.00	
3557	CONNECTYOURCARE	PR0510201	ConnectYourCare HSA Pay Perio	10-22770 INSURANCE PAYABLE	06/02/2020	350.00	.00	
3557	CONNECTYOURCARE	PR0524201	ConnectYourCare HSA Pay Perio	10-22770 INSURANCE PAYABLE	06/03/2020	350.00	.00	



## CITY OF CARLIN

Payment Approval Report - With Description  
Report dates: 5/22/2020-6/5/2020Page: 3  
Jun 08, 2020 09:56AM

Vendor	Vendor Name	Invoice Number	Description	GL Account and Title	Invoice Date	Net Invoice Amount	Amount Paid	Date Paid
10-55-435								
1303	CARLIN TIRE CENTER	23833	FLAT REPAIR #2616	10-55-435 AUTO EXPENSE	05/18/2020	25.00	.00	
Total 10-55-435:								
						25.00	.00	
10-55-610								
1273	CARLIN ACE HARDWARE	6333-20	fd materials & supplies	10-55-610 MATERIALS & SUPPLIES	04/27/2020	28.96	.00	
Total 10-55-610:								
						28.96	.00	
10-60-430								
1273	CARLIN ACE HARDWARE	6330-20	water truck parts	10-60-430 EQUIPMENT REPAIRS	04/16/2020	55.96	.00	
1385	CNH CAPITAL PRODUCTIVITY P	IV04206	sight glass	10-60-430 EQUIPMENT REPAIRS	05/18/2020	171.09	.00	
1660	FAIRMONT SUPPLY COMPANY	5295331-00	v belt	10-60-430 EQUIPMENT REPAIRS	05/28/2020	46.02	.00	
2305	NORCO, INC	29390748	may 2020 rental	10-60-430 EQUIPMENT REPAIRS	05/31/2020	112.22	.00	
Total 10-60-430:								
						385.29	.00	
10-60-432								
1273	CARLIN ACE HARDWARE	6332-20	fence post mix	10-60-432 STREET REPAIRS	04/23/2020	10.98	.00	
3154	SILVER STATE BARRICADE & SI	113680	SIGN POSTS	10-60-432 STREET REPAIRS	05/29/2020	324.00	.00	
Total 10-60-432:								
						334.98	.00	
10-60-435								
1660	FAIRMONT SUPPLY COMPANY	5295292-00	filters unit #1-08	10-60-435 AUTO EXPENSE	05/27/2020	25.51	.00	
Total 10-60-435:								
						25.51	.00	
10-64-430								
1875	HOME DEPOT	9025992	trimmer & plants	10-64-430 EQUIPMENT REPAIRS	05/28/2020	59.88	.00	
Total 10-64-430:								
						59.88	.00	
10-65-430								
1273	CARLIN ACE HARDWARE	6322-20	paint rollers	10-65-430 EQUIPMENT REPAIRS	04/09/2020	25.54	.00	
1273	CARLIN ACE HARDWARE	6323-20	paint supplies	10-65-430 EQUIPMENT REPAIRS	04/10/2020	12.93	.00	
1273	CARLIN ACE HARDWARE	6324-20	trash can	10-65-430 EQUIPMENT REPAIRS	04/13/2020	24.99	.00	
1273	CARLIN ACE HARDWARE	6325-20	paint supplies	10-65-430 EQUIPMENT REPAIRS	04/13/2020	14.32	.00	
1273	CARLIN ACE HARDWARE	6334-20	bushing	10-65-430 EQUIPMENT REPAIRS	04/27/2020	9.18	.00	
1273	CARLIN ACE HARDWARE	6335-20	bushings	10-65-430 EQUIPMENT REPAIRS	04/28/2020	5.58	.00	



## CITY OF CARLIN

Payment Approval Report - With Description  
Report dates: 5/22/2020-6/5/2020Page: 4  
Jun 08, 2020 09:56AM

Vendor	Vendor Name	Invoice Number	Description	GL Account and Title	Invoice Date	Net Invoice Amount	Amount Paid	Date Paid
1827	H & E EQUIPMENT SERVICES	95182218	spray nozzles for sweeper	10-65-430 EQUIPMENT REPAIRS	05/19/2020	634.40	.00	
1875	HOME DEPOT	3020124	PAINT SPRAYER	10-65-430 EQUIPMENT REPAIRS	06/03/2020	426.97	.00	
Total 10-65-430:							1,153.91	.00
10-65-610								
2825	TERRY'S PUMPIN & POTTIES IN	52424	PARK RENTAL	10-65-610 MATERIALS & SUPPLIES	05/28/2020	87.50	.00	
Total 10-65-610:							87.50	.00
10-79-311								
1605	ELKO DAILY FREE PRESS	60908	2020-2021 Budget Hearing	10-79-311 LEGAL NOTICES	05/15/2020	84.12	.00	
Total 10-79-311:							84.12	.00
10-79-340								
1911	RICOH USA, INC	103685628	admin copier	10-79-340 CONTRACT FEES	05/19/2020	320.25	.00	
1911	RICOH USA, INC	103700589	PD COPY LEASE	10-79-340 CONTRACT FEES	05/22/2020	352.83	.00	
1911	RICOH USA, INC	103700590	copier lease	10-79-340 CONTRACT FEES	05/22/2020	188.38	.00	
Total 10-79-340:							861.46	.00
10-79-445								
1273	CARLIN ACE HARDWARE	6321-20	water old pd	10-79-445 BUILDING MAINTENANCE	04/08/2020	52.34	.00	
1273	CARLIN ACE HARDWARE	6326	water city hall	10-79-445 BUILDING MAINTENANCE	04/14/2020	7.78	.00	
1273	CARLIN ACE HARDWARE	6327-20	water city hall	10-79-445 BUILDING MAINTENANCE	04/14/2020	4.99	.00	
1273	CARLIN ACE HARDWARE	6329-20	spackle	10-79-445 BUILDING MAINTENANCE	04/15/2020	5.59	.00	
1273	CARLIN ACE HARDWARE	6336-20	nipples	10-79-445 BUILDING MAINTENANCE	04/28/2020	2.98	.00	
1273	CARLIN ACE HARDWARE	6337-20	plumbing parts	10-79-445 BUILDING MAINTENANCE	04/29/2020	106.72	.00	
2285	JOHNSON STEAM LLC	1032	HAND SANITIZER	10-79-445 BUILDING MAINTENANCE	06/01/2020	312.00	.00	
Total 10-79-445:							492.40	.00
10-79-955								
2325	STATE OF NEVADA (DETR)	05222020	UNEMPLOYMENT CLAIMS	10-79-955 UNEMPLOYMENT EXPENS	05/22/2020	385.74	.00	
Total 10-79-955:							385.74	.00
20-40-650								
1599	ELKO COUNTY RECREATION B	APRIL 2020	lodging tax	20-40-650 STATE/COUNTY PORTION-	06/04/2020	16.53	.00	
2367	NV TAX COMMISSION	APRIL2020	STATE LODGING TAX	20-40-650 STATE/COUNTY PORTION-	06/04/2020	9.92	.00	

## CITY OF CARLIN

Payment Approval Report - With Description  
Report dates: 5/22/2020-6/5/2020Page: 5  
Jun 08, 2020 09:56AM

Vendor	Vendor Name	Invoice Number	Description	GL Account and Title	Invoice Date	Net Invoice Amount	Amount Paid	Date Paid
Total 20-40-650:								
50-71-430								
3443	I&E ELECTRIC, INC	6312	WATER WELL COMMUNICATIO	50-71-430 EQUIPMENT REPAIRS	05/28/2020	400.00	.00	
Total 50-71-430:								
50-71-600								
1249	BUREAU OF SAFE DRINKING W	EL-0014- C-20	WATER SYSTEM PERMIT RENE	50-71-600 OFFICE EXPENSE	05/15/2020	895.50	.00	
Total 50-71-600:								
50-71-610								
3015	WESTERN NEVADA SUPPLY CO	28324559	water dept supplies	50-71-610 MATERIALS & SUPPLIES	05/20/2020	938.73	.00	
3015	WESTERN NEVADA SUPPLY CO	58324559-1	water dept supplies	50-71-610 MATERIALS & SUPPLIES	05/21/2020	13.95	.00	
Total 50-71-610:								
50-71-660								
2735	SPB UTILITY SERVICES, INC.	20-255	may 2020 WATER TESTING	50-71-660 TESTING - WATER	06/01/2020	1,205.43	.00	
Total 50-71-660:								
50-72-650								
1371	CITY OF ELKO	2020-0000072	may 2020 landfill	50-72-650 LANDFILL EXPENSE	05/31/2020	4,987.16	.00	
1623	ELKO SANITATION	24817620	30 YD ROLLOFF	50-72-650 LANDFILL EXPENSE	06/01/2020	5,538.02	.00	
Total 50-72-650:								
50-73-430								
1273	CARLIN ACE HARDWARE	6320-20	drill bits sprayer	50-73-430 EQUIPMENT REPAIRS	04/08/2020	21.57	.00	
2979	GRAINGER INDUSTRIAL SUPPL	9530950501	AIR FILTER KIT	50-73-430 EQUIPMENT REPAIRS	05/12/2020	301.68	.00	
3443	I&E ELECTRIC, INC	6285	water well communication issue	50-73-430 EQUIPMENT REPAIRS	05/21/2020	450.00	.00	
3443	I&E ELECTRIC, INC	6318	WATER WELL COMMUNICATIO	50-73-430 EQUIPMENT REPAIRS	05/28/2020	800.00	.00	
3443	I&E ELECTRIC, INC	6320	SCADA TROUBLESHOOT	50-73-430 EQUIPMENT REPAIRS	05/28/2020	300.00	.00	
Total 50-73-430:								
50-73-585								
2971	VOGUE LAUNDRY & CLEANERS	3001347	PW UNIFORMS	50-73-585 UNIFORMS	03/26/2020	75.24	.00	





Vendor	Vendor Name	Invoice Number	Description	GL Account and Title	Invoice Date	Net Invoice Amount	Amount Paid	Date Paid
<b>73-81-650</b>								
3612	KHOURY'S FRESH MARKET CA	01-437074	raw food	73-81-650 RAW FOOD	05/21/2020	20.04	.00	
3612	KHOURY'S FRESH MARKET CA	01-442884	raw food	73-81-650 RAW FOOD	05/28/2020	8.33	.00	
3612	KHOURY'S FRESH MARKET CA	01-443838	raw food	73-81-650 RAW FOOD	05/29/2020	14.82	.00	
3612	KHOURY'S FRESH MARKET CA	01-446447	raw food	73-81-650 RAW FOOD	06/01/2020	1.69	.00	
3612	KHOURY'S FRESH MARKET CA	02-393355	raw food	73-81-650 RAW FOOD	05/19/2020	5.56	.00	
3612	KHOURY'S FRESH MARKET CA	03-276718	raw food	73-81-650 RAW FOOD	05/20/2020	41.48	.00	
3612	KHOURY'S FRESH MARKET CA	03-280137	raw food	73-81-650 RAW FOOD	05/27/2020	66.15	.00	
2565	RUBY MOUNTAIN NATURAL SP	839745	WATER-SC	73-81-650 RAW FOOD	05/20/2020	16.50	.00	
Total 73-81-650:						174.57	.00	
<b>73-82-440</b>								
3153	SECURITY CONSULTING & SUP	49029	fire alarm certify and testing	73-82-440 FACILITY	05/19/2020	300.00	.00	
Total 73-82-440:						300.00	.00	
<b>73-82-650</b>								
1127	BAIR DISTRIBUTING, INC.	242528	milk for homebound	73-82-650 RAW FOOD	05/28/2020	42.60	.00	
3612	KHOURY'S FRESH MARKET CA	01-409170	raw food	73-82-650 RAW FOOD	04/20/2020	8.98	.00	
3612	KHOURY'S FRESH MARKET CA	01-411410	raw food	73-82-650 RAW FOOD	04/22/2020	44.41	.00	
2299	NICHOLAS & COMPANY, INC.	7233017	RAW FOOD	73-82-650 RAW FOOD	05/19/2020	481.43	.00	
Total 73-82-650:						577.42	.00	
<b>73-83-110</b>								
1061	AMERICAN STAFFING	84685	Cierra Walter	73-83-110 SALARIES AND WAGES	05/21/2020	275.74	.00	
1061	AMERICAN STAFFING	84923	Cierra Walter	73-83-110 SALARIES AND WAGES	05/28/2020	142.07	.00	
Total 73-83-110:						417.81	.00	
Grand Totals:						84,580.77	.00	

Vendor	Vendor Name	Invoice Number	Description	GL Account and Title	Invoice Date	Net Invoice Amount	Amount Paid	Date Paid
--------	-------------	----------------	-------------	----------------------	--------------	--------------------	-------------	-----------

Dated: \_\_\_\_\_

Mayor: \_\_\_\_\_

City Council: \_\_\_\_\_

\_\_\_\_\_

\_\_\_\_\_

\_\_\_\_\_

\_\_\_\_\_

\_\_\_\_\_

City Recorder: \_\_\_\_\_

Report Criteria:

Detail report.

Invoices with totals above \$0.00 included.

Paid and unpaid invoices included.

**PUBLIC COMMENTS: (Non-Action Item)**

- A) Pursuant to NRS 241.020(2)(D)(3)(I & II) this time is devoted to comments by the general public and possible discussion of those comments. No action may be taken upon a matter raised under this item until the matter has been included on a successive agenda pursuant to the required procedures at the discretion of the City in accordance with applicable law and identified as an action item.

**Adjournment (For Possible Action)**