

P.O. Box 157  
10405 Merrill Road  
Hamburg, Michigan 48139-0157

(810) 231-1000 Office  
(810) 231-4295 Fax



**Supervisor:** Pat Hohl  
**Clerk:** Mike Dolan  
**Treasurer:** Jason Negri  
**Trustees:** Bill Hahn  
Annette Koeble  
Chuck Menzies  
Jim Neilson

---

---

## HAMBURG TOWNSHIP BOARD OF TRUSTEES

### Public Hearing

Hamburg Township Hall Board Room

Tuesday, August 6, 2019

2:00 p.m.

### AGENDA

1. Call to Order
2. Pledge to the Flag
3. Roll Call of the Board
4. Call to the Public
5. Correspondence
6. Consent Agenda
7. Approval of the Agenda
8. Current Business:
  - A. 1<sup>st</sup> Public Hearing – Edgelake Burton Road SAD
9. Call to the Public
10. Public Information
11. Board Comments
12. Adjournment

# Pledge to the Flag



**No Correspondence**



10405 Merrill Road ♦ P.O. Box 157  
Hamburg, MI 48139  
Phone: 810.231.1000 ♦ Fax: 810.231.4295  
www.hamburg.mi.us

# Township Board Cover Sheet

## **Edgelake/Burton Drive – Road Maintenance S.A.D.**

### First Public Hearing to Renew S.A.D. & Resolution to Prepare Roll, Set 2<sup>nd</sup> Public Hearing

#### **Information Packet:**

The current special assessment district for Edgelake and Burton Drive will expire on October 20, 2019. Based upon property owner response, there are enough petitions to proceed with establishing the new S.A.D. The following items are included for Board review/approval.

1. **Notice of First Public Hearing:**
  - A. Affidavit of Mailing
  - A. Public Hearing Cover Letter
  - B. Notice of Improvement Hearing – per Public Act 188 requirements
  - C. Mailing List of Property Owners included in S.A.D.
  - D. Estimate of Cost to Renew S.A.D.
  
2. **Resolution to Establish S.A.D., Prepare Assessment Roll and Set 2<sup>nd</sup> Public Hearing:**
  - A. Resolution No. **2** – Resolution to Direct Preparation of Assessment Roll and Set Date of 2<sup>nd</sup> Public Hearing

This Resolution will set the date and time for the second public hearing to be held to re-establish the district. This is called the *Hearing of Necessity* and gives property owners the opportunity to object to amount of assessment for road maintenance if they wish to appeal to the Michigan Tax Tribunal. I am recommending that the second public hearing be scheduled for Tuesday, September 3<sup>rd</sup>, 2019 beginning at 2:00 p.m. to meet the necessary statutory notice requirements.

**All items must be reviewed and approved by the Township Board to stay on track with the special assessment district 2019 winter tax special assessments calculation schedule.**

*Drafted: July 24<sup>th</sup>, 2019*



FAX 810-231-4295  
PHONE 810-231-1000 Ext. 210  
DIRECT DIAL 810-222-1193



P.O. Box 157  
10405 Merrill Road  
Hamburg, Michigan 48139

July 24<sup>th</sup>, 2019

Re: **Edgelake and Burton Drive – Road Maintenance District**  
Notice of First Public Hearing

Dear Property Owner,

Enclosed is a copy of the official Notice of Improvement Hearing to re-establish the Edgelake and Burton Drive road maintenance special assessment district that will expire on October 20<sup>th</sup>, 2019. The district will have the same services as previously provided through the Township.

The Township Board has scheduled the first public hearing for Tuesday, August 6<sup>th</sup>, 2019 to begin at 2:00 p.m. here at the Township Offices located at 10405 Merrill Road. The purpose of the meeting is to discuss the district boundaries, the desire to re-establish the district, and the estimate of cost for the first year services for the district. The estimated cost is \$4,547.40 which will be split equally among the 89 parcels in an assessment of \$51.10 each. This number will change each year based upon the amount of services rendered the previous year. If there is money left in the Edgelake/Burton Drive account at the end of the fiscal year, the remaining funds will be used to off-set the amount collected to pay for the next year's services.

If after the first public hearing there is still enough support to move forward with re-establishing the special assessment district the Board will pass a resolution to schedule the 2<sup>nd</sup> public hearing which will list the actual amount of your assessment that will appear on the December 1, 2019 tax bill.

We will be happy to answer any questions you have during the public hearing, however, if you would like to discuss the project before the meeting please feel free to contact me at (810) 231-1000 Ext. 210 or via email at [bcampbell@hamburg.mi.us](mailto:bcampbell@hamburg.mi.us).

Sincerely,

A handwritten signature in blue ink that reads "Brittany K. Campbell". The signature is fluid and cursive.

Brittany K. Campbell  
Hamburg Township Utilities Coordinator



**NOTICE OF PUBLIC HEARING**

Hamburg Township  
Livingston County, Michigan

**NOTICE OF PUBLIC HEARING  
TO RE-ESTABLISH THE ROAD MAINTENANCE  
SPECIAL ASSESSMENT DISTRICT FOR  
EDGELAKE AND BURTON DRIVES**

NOTICE IS HEREBY GIVEN:

(1) The Township Board of Hamburg Township, Livingston County, Michigan, in accordance with the laws of the State of Michigan, will hold a public hearing on Tuesday, August 6<sup>th</sup>, 2019 at 2:00 p.m., at the Hamburg Township Hall, 10405 Merrill Road, Hamburg, Michigan 48139, to review the following proposed special assessment district:

**HAMBURG TOWNSHIP EDGELAKE/BURTON DRIVE  
ROAD MAINTENANCE SPECIAL ASSESSMENT DISTRICT**

and to hear any objections thereto and to the proposed Project and to the petitions filed with the Township Board requesting the Project.

(2) The project (the "Project") will consist of snow removal – up to five (5) times per year, as necessary, for the removal of three (3) inches or more of accumulation; and salting of the roadways up to three (3) times per year when icy conditions require. The Project is designed to serve those properties in the Special Assessment District, which properties are adjacent to the private portion of Edgelake Drive and Burton Drive, and which properties are identified by the following permanent parcel numbers:

15-27-100-054	15-27-100-055	15-27-100-056	15-27-100-057
15-27-103-001	15-27-103-008	15-27-103-011	15-27-103-012
15-27-103-013	15-27-103-014	15-27-103-016	15-27-103-019
15-27-103-020	15-27-103-021	15-27-103-022	15-27-103-025
15-27-103-026	15-27-103-028	15-27-103-032	15-27-103-034
15-27-103-037	15-27-103-038	15-27-103-039	15-27-103-040
15-27-104-001	15-27-104-002	15-27-104-003	15-27-104-004
15-27-104-007	15-27-104-009	15-27-104-011	15-27-104-012
15-27-104-013	15-27-104-018	15-27-104-025	15-27-104-026
15-27-104-027	15-27-104-028	15-27-104-029	15-27-104-030
15-27-104-031	15-27-104-032	15-27-104-033	15-27-104-035
15-27-104-036	15-27-104-038	15-27-104-040	15-27-104-041

15-27-104-042	15-27-104-043	15-27-104-044	15-27-104-045
15-27-104-046	15-27-104-047	15-27-104-048	15-27-104-049
15-27-107-050	15-27-104-051	15-27-105-001	15-27-105-003
15-27-105-004	15-27-105-005	15-27-105-006	15-27-105-009
15-27-105-010	15-27-105-011	15-27-105-012	15-27-105-013
15-27-105-014	15-27-105-018	15-27-105-019	15-27-105-022
15-27-105-024	15-27-105-027	15-27-105-030	15-27-105-037
15-27-105-038	15-27-105-039	15-27-105-041	15-27-105-042
15-27-105-043	15-27-105-044	15-27-105-045	15-27-105-046
15-27-105-047	15-27-105-048	15-27-105-049	15-27-105-050
15-28-200-001			

(3) The Township plans on imposing special assessments on the properties located in the Special Assessment District to pay for the costs of the Project.

(4) The plans and cost estimates for the proposed Project, the boundaries of the Special Assessment District and the petitions filed in support of the Project are now on file in the office of the Township Clerk for public inspection. Periodic redeterminations of the cost of the Project may be made, and subsequent hearings shall not be required if such cost redeterminations do not increase the estimated cost of the Project by more than 10%. Any person objecting to the proposed Project, the petitions for the Project or the proposed Special Assessment District shall file an objection in writing with the Township Clerk before the close of the August 6<sup>th</sup>, 2019, hearing or within such further time the Township Board may grant.

This notice is given by order of the Hamburg Township Board.

Dated: July 24<sup>th</sup>, 2019

Michael Dolan  
Hamburg Township Clerk  
10405 Merrill Rd. P.O. Box 157  
Hamburg, MI 48139



**EDGELAKE/BURTON ROAD MAINTENANCE SPECIAL ASSESSMENT DISTRICT**

- Hamburg Township, Livingston County, Michigan

The general service area in which a proposed special assessment district is to be designated. The Hamburg Township Board of Trustees may adjust the district boundaries based upon property owner response in support of re-establishing the road maintenance special assessment district.

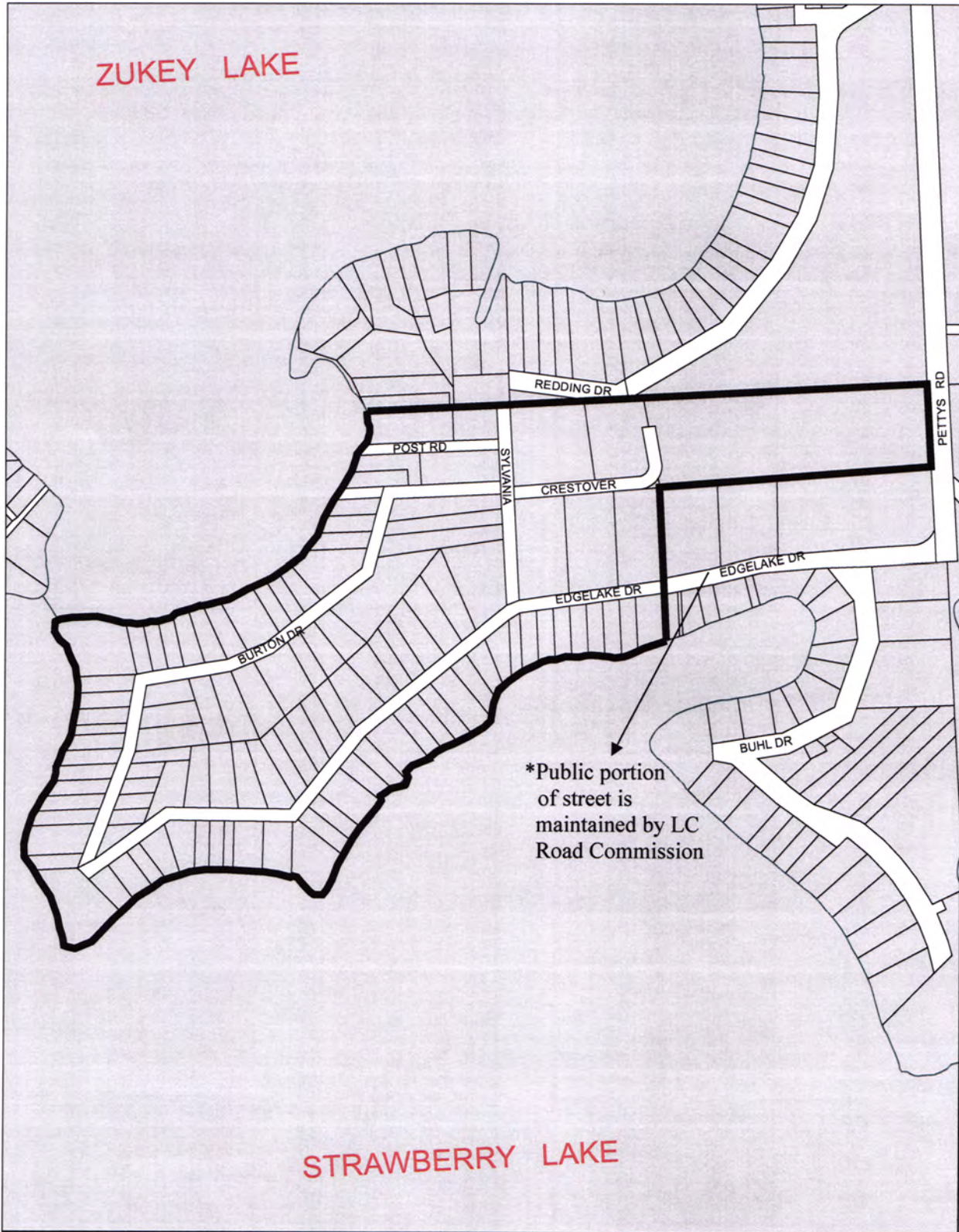

**Proposed special assessment district boundary shown within thick black-lined area.**

15-27-100-054  
John B. & Jane S. Voorhorst  
10020 Sylvania Rd.  
Pinckney, MI 48169

15-27-100-055  
Steven C. & Heather M. Kirn  
5261 Crestover Rd.  
Pinckney, MI 48169

15-27-100-056  
Richard Carbonneau  
5295 Crestover Rd.  
Pinckney, MI 48169

15-27-100-057  
Terrance L. Jr. & Nichole K. Serman  
5280 Crestover Rd.  
Pinckney, MI 48169

15-27-103-001  
Jason M. Newton  
5254 Edgelake Dr.  
Pinckney, MI 48169

15-27-103-008  
Ronald & Beth Mersman  
5162 Edgelake Dr.  
Pinckney, MI 48169

15-27-103-011  
Karl F. & Marian J. Kopp Trust  
4849 Gallagher Blvd.  
Whitmore Lake, MI 48189

15-27-103-012  
Karl F. & Marian J. Kopp Trust  
4849 Gallagher Blvd.  
Whitmore Lake, MI 48189

15-27-103-013  
Michael J., Anita S. & Chris Barger  
P.O. Box 372  
Hamburg, MI 48139

15-27-103-014  
Kenneth M. & Audrey Murawski  
15971 Penn Dr.  
Livonia, MI 48154

15-27-103-016  
Dennis G. Doyle  
30895 Jasper Ridge  
Novi, MI 48377

15-27-103-019  
Benjamin & Kayla Heilner  
5013 Burton Dr.  
Pinckney, MI 48169

15-27-103-020  
Gary D. Banas  
5017 Burton Dr.  
Pinckney, MI 48169

15-27-103-021  
Rexford W. & Marion Lockwood  
47309 Hunters Park Dr.  
Plymouth, MI 48170

15-27-103-022  
Phillip C. & Pamela J. Koester  
828 Continental Dr.  
Waterville, OH 43566

15-27-103-025  
Rebecca & Roscoe G. Porter  
5039 Burton Dr.  
Pinckney, MI 48169

15-27-103-026  
John Blasé & Jennifer Kaiser-Blasé  
27 Oxford Blvd.  
Pleasant Ridge, MI 48069

15-27-103-028  
Seventh Street Investment LLC  
13001 23 Mile Rd. Suite 200  
Utica, MI 48315

15-27-103-032  
Donna J. Kroll  
P.O. Box 610  
Lakeland, MI 48143

15-27-103-034  
James M. Boyles  
13426 Cantaberry Ct.  
South Lyon, MI 48178

15-27-103-037  
Steven & Joyce Janiga  
5187 Burton Dr.  
Pinckney, MI 48169

15-27-103-038  
Dennis & Karen Benefield  
5191 Burton  
Pinckney, MI 48169

15-27-103-039  
Kirk A. & Suzanne Beadle  
P.O. Box 748  
Lakeland, MI 48143

15-27-103-040  
Frank & Candace Reaume  
5105 Burton Dr.  
Pinckney, MI 48169

15-27-104-001  
Steven J. & Mary B. Dinobile  
5010 Edgelake, Dr. P.O. Box 669  
Lakeland, MI 48143

15-27-104-002  
Todd M. & Tracy L. McNeilly  
5022 Edgelake Dr.  
Pinckney, MI 48169

15-27-104-003  
George & Janet Zampas  
25017 Avon Ct.  
Novi, MI 48374

15-27-104-004  
Sally H. Crouch  
5050 Edgelake Dr., P.O. Box 723  
Lakeland, MI 48143

15-27-104-007  
Dennis G. Doyle  
30895 Jasper Ridge  
Novi, MI 48377

15-27-104-009  
Greg & Kimberly Attwood  
8015 Sharon Rd.  
Leander, TX 78641

15-27-104-011  
Estate of Audrey Murawski  
15971 Penn Dr.  
Livonia, MI 48154

15-27-104-012  
Michael J., Anita S. & Chris Barger  
5116 Edgelake, P.O. Box 372  
Hamburg, MI 48139

15-27-104-013  
Patrick J. & Kristin C. Finn  
1952 Cambridge  
Ann Arbor, MI 48104

15-27-104-018  
Ronald & Beth Mersman  
5162 Edgelake Dr.  
Pinckney, MI 48169

15-27-104-025  
Robert Oelkers  
5248 Edgelake Dr.  
Pinckney, MI 48169

15-27-104-026  
Jason M. Newton  
5254 Edgelake Dr.  
Pinckney, MI 48169

15-27-104-027  
Michael J. Doheny  
5256 Edgelake Dr.  
Pinckney, MI 48169

15-27-104-028  
Bruce & Evelyn R. Schlansker  
5260 Edgelake Dr.  
Pinckney, MI 48169

15-27-104-029  
Ryan & Jacquelyn M. Emery  
8277 Tower  
South Lyon, MI 48178

15-27-104-030  
Mark T. & Darcey D. Guenther  
45257 Yorkshire Dr.  
Novi, MI 48375

15-27-104-031  
M. Andrzejewski & A. Janowicz  
5280 Edgelake Dr.  
Pinckney, MI 48169

15-27-104-032  
M. Andrzejewski & A. Janowicz  
5280 Edgelake Dr.  
Pinckney, MI 48169

15-27-104-033  
Jeffrey D. & Janet S. Morgan  
5198 Edgelake Dr.  
Pinckney, MI 48169

15-27-104-035  
Gary & Barbara Bell  
5291 Edgelake Dr.  
Pinckney, MI 48169

15-27-104-036  
David R. & Georgine L. Whitman  
5262 Crestover Rd.  
Pinckney, MI 48169

15-27-104-038  
Richard E., Jr. & Maria Dorsch  
5273 Edgelake, P.O. Box 616  
Hamburg, MI 48139

15-27-104-040  
Scott A. & Cheryl M. McLean  
3145 Forshee Ln.  
Dexter, MI 48130

15-27-104-041  
Richard & Jennifer Bakka  
5182 Edgelake  
Pinckney, MI 48169

15-27-104-042  
Ruth P. Aprill Trust  
310 Brecon Dr.  
Saline, MI 48176

15-27-104-043  
Jeffrey A. & Patricia E. Lotz  
5130 Edgelake Dr.  
Pinckney, MI 48169

15-27-104-044  
Thomas Butts  
5210 Edgelake, P.O. Box 862  
Lakeland, MI 48143

15-27-104-045  
Michael & Julie McDonald  
5190 Edgelake  
Pinckney, MI 48169

15-27-104-046  
Larry D. & Constance C. Carello  
5144 Edgelake Dr. P.O. Box B  
Lakeland, MI 48143

15-27-104-047  
James & Shirley Fitzgerald  
5176 Edgelake Dr. P.O. Box 754  
Lakeland, MI 48143

15-27-104-048  
Peter E. & Barbara J. Dulecki  
21837 Bell  
New Boston, MI 48164

15-27-104-049  
Eric A. & Karin S. Nelson  
437 Blunk St.  
Plymouth, MI 48170

15-27-104-050  
Randolph L. Forester Trust  
991 Lake Park  
Birmingham, MI 48009

15-27-104-051  
Edith C. Coan  
5152 Edgelake Dr.  
Pinckney, MI 48169

15-27-105-001  
Eric, Jr. & Pamela R. Saunders  
5005 Burton Dr.  
Pinckney, MI 48169

15-27-105-003  
Benjamin & Kayla Heilner  
5013 Burton Dr.  
Pinckney, MI 48169

15-27-105-004  
Gary D. Banas  
5017 Burton Dr.  
Pinckney, MI 48169

15-27-105-005  
Rexford W. & Marion Lockwood  
47309 Hunters Park Dr.  
Plymouth, MI 48170

15-27-105-006  
Phillip & Pamela J. Koester  
P.O. Box 526  
Lakeland, MI 48143

15-27-105-009  
Rebecca & Roscoe G. Porter  
5039 Burton Dr.  
Pinckney, MI 48169

15-27-105-010  
John Blasé & Jennifer Kaiser-Blasé  
27 Oxford Blvd.  
Pleasant Ridge, MI 48609

15-27-105-011  
Paul Balys & Kimberley Payne  
5049 Burton Dr.  
Pinckney, MI 48169

15-27-105-012  
Neal P. & Jennifer Morton  
5055 Burton Dr.  
Pinckney, MI 48169

15-27-105-013  
David & Christina St. Germain  
5059 Burton Dr.  
Pinckney, MI 48169

15-27-105-014  
Joseph P. & Deborah H. Droze  
4343 St. Andrews Dr.  
Howell, MI 48843

15-27-105-018  
Kirk A. & Suzanne S. Beadle  
5095 Burton, P.O. Box 748  
Lakeland, MI 48143

15-27-105-019  
Frank H. & Candace H. Reaume  
5105 Burton Dr.  
Pinckney, MI 48169

15-27-105-022  
Donna J. Kroll  
5135 Burton, P.O. Box 610  
Lakeland, MI 48143

15-27-105-024  
James M. Boyles  
13426 Cantaberry Ct.  
South Lyon, MI 48178

15-27-105-027  
Steven & Joyce Janiga  
5187 Burton Dr.  
Pinckney, MI 48169

15-27-105-030  
Mark & Jill Bofenkamp  
8090 Ruger Dr.  
Fowlerville, MI 48836

15-27-105-037  
Margaret Eibler  
5143 Burton, P.O. Box 601  
Lakeland, MI 48143

15-27-105-038  
Michael & Sharon Diepenhorst  
5245 Post, P.O. Box 856  
Lakeland, MI 48143

15-27-105-039  
Richard & Kristine Mancik  
5229 Post, P.O. Box 317  
Lakeland, MI 48143

15-27-105-041  
Dennis & Karen Benefield  
5191 Burton  
Pinckney, MI 48169

15-27-105-042  
Brandon Paquette & Pamela Kendall  
5201 Burton  
Pinckney, MI 48169

15-27-105-043  
Seventh Street Investment LLC  
13001 23 Mile Rd. Suite 200  
Utica, MI 48315

15-27-105-044  
Seventh Street Investment LLC  
13001 23 Mile Rd. Suite 200  
Utica, MI 48315

15-27-105-045  
Salvator & Karen Zerilli  
5125 Burton Dr.  
Pinckney, MI 48169

15-27-105-046  
Laura Maher  
5033 Burton Dr.  
Pinckney, MI 48169

15-27-105-047  
Kim & Sheryl Rzetelny  
5029 Burton Dr.  
Pinckney, MI 48169

15-27-105-048  
Harry Wilson Wagner II  
5065 Burton Dr.  
Pinckney, MI 48169

15-27-105-049  
Craig R. & Renee L. Peterson  
5181 Burton Dr.  
Pinckney, MI 48169

15-27-105-050  
Felix de la Iglesia  
5159 Burton Dr.  
Pinckney, MI 48169

15-28-200-001  
Ronald E. & Gail M. Guse  
5000 Edgelake Dr.  
Pinckney, MI 48169



10405 Merrill Road ♦ P.O. Box 157  
 Hamburg, MI 48139  
 Phone: 810.231.1000 ♦ Fax: 810.231.4295  
 www.hamburg.mi.us

## Estimate of Cost to Re-Establish the Edgelake & Burton Drive Road Maintenance Special Assessment District Year 1

**Administration Expenses:**

Postage (correspondence w/ property owners)	\$ 100.00
Publications (4 @ \$500.00 each)	2,000.00
Public Hearings (2 @ \$150.00 each)	300.00
Annual Administration Charge ((\$350 in a renewal year \$200 in a subsequent year)	350.00
	\$ 2,750.00

**Road Maintenance:**

**Snow Removal:**

– Up to five (5) times per year upon 3” or more accumulation ((\$173.00 per time - 5 assumed)	\$ 865.00
--	-----------

**Salting of Roadways:**

– Up to three (3) times per year when icy conditions require. (Assumed 3 times @ \$173.00 per application)	\$ 519.00
	\$ 1,384.00

10% Contingency Fee	413.40
---------------------	--------

Total Project Cost	\$ 4,547.40
--------------------	-------------

\$ 4,547.40 divided by 89 Parcels = **\$51.10 per parcel.\***

**\*NOTE:** Represents **first** year estimated costs to re-establish the road maintenance special assessment district. The project has been sent out for bid to determine the 2019/2020 FY road maintenance costs.

**OVER**

**Estimate of Cost to Re-Establish  
the Edgelake & Burton Drive  
Road Maintenance Special Assessment District  
Year 2**

**Administration Expenses:**

Annual Administration Charge		\$	200.00
(\$350 in a renewal year			
\$200 in a subsequent year)			
			200.00
		\$	200.00

**Road Maintenance:**

**Snow Removal:**

– Up to five (5) times per year upon 3” or more accumulation ((\$173.00 per time - 5 assumed)		\$	865.00
--	--	----	--------

**Salting of Roadways:**

– Up to three (3) times per year when icy conditions require. (Assumed 3 times @ \$173.00 per application)		\$	519.00
			1,384.00
		\$	1,384.00

10% Contingency Fee			158.40
---------------------	--	--	--------

Total Project Cost		\$	1,742.40
--------------------	--	----	----------

\$ 1,742.40 divided by 89 Parcels = **\$19.58 per parcel**.\*

**NOTE:** Represents **second** year estimated costs to establish the proposed special assessment district.

\* This number will change each year based upon the amount of services rendered the previous year. If there is money left over in the Edgelake and Burton Drive road maintenance account that money will be used to off-set the amount collected to pay for the next year’s services.

**EDGELAKE/BURTON DRIVE - ROAD MAINTENANCE  
SPECIAL ASSESSMENT DISTRICT RESOLUTION  
(Resolution #2)**

**TOWNSHIP OF HAMBURG**

At a regular meeting of the Township Board of the Township of Hamburg, Livingston County, State of Michigan, held at the Hamburg Township Hall on Tuesday, August 6<sup>th</sup>, 2019, beginning at 2:30 p.m. Eastern Time, there were:

PRESENT: \_\_\_\_\_

ABSENT: \_\_\_\_\_

and the following preamble and resolution were:

MOVED FOR ADOPTION BY: \_\_\_\_\_

MOTION SUPPORTED BY: \_\_\_\_\_ :

**RESOLUTION TO RE-ESTABLISH THE  
EDGELAKE/BURTON DRIVE SPECIAL ASSESSMENT DISTRICT  
DIRECT PREPARATION OF ASSESSMENT ROLL  
AND SET DATE OF SECOND PUBLIC HEARING**

**WHEREAS**, the Township Board (“the Board”) of the Township of Hamburg, Livingston County, Michigan (“the Township”) received Petitions signed by more than 50% of the total (approx. 8,035 linear feet) of the proposed Special Assessment District described hereinafter, and accordingly, determined to proceed under the provisions of Public Act 188 of 1954, as amended, to secure plans and estimates of cost together with a proposed Special Assessment District for assessing the costs of the proposed road maintenance to schedule a public hearing upon the same for this date, and

**WHEREAS**, the plans, estimates of cost and proposed Special Assessment District were filed with the Township Clerk for public examination and Notice of the within hearing upon the same was published and mailed in accordance with law and statute provided as shown by the Affidavit pertaining thereto on file with the Township Clerk, and

**WHEREAS**, in accordance with the aforesaid Notices, a hearing was scheduled on this 6<sup>th</sup> day of August, 2019, commencing at 2:00 o’clock p.m. and all persons given the opportunity to be heard in the matter, and

**WHEREAS**, as a result of the foregoing, the Township Board believes the project to be in the best interests of the township and of the district proposed to be established therefore;

**NOW, THEREFORE, BE IT HEREBY RESOLVED** as follows:

1. That this Township Board does hereby determine that the Petitions for the Edgelake/Burton Drive - Road Maintenance Special Assessment District were properly signed by the record owners of land whose frontage constitutes more than 50% of the total (8,035 linear feet) upon the proposed improvement.

2. That this Township Board does hereby approve the plans for the road maintenance as requested by the Petitions and the preliminary estimate of costs for the first year to establish the district in the amount \$4,547.40, which has been bid out for the final determination of costs.

3. That this Township Board does hereby re-establish, determine and define as a Special Assessment District to be known as the Edgelake/Burton Drive Special Assessment District within which the costs of such improvements shall be assessed according to benefit and which consists of the lands identified more specifically identified by the following permanent parcel numbers:

- |               |               |               |               |
|---------------|---------------|---------------|---------------|
| 15-27-100-054 | 15-27-100-055 | 15-27-100-056 | 15-27-100-057 |
| 15-27-103-001 | 15-27-103-008 | 15-27-103-011 | 15-27-103-012 |
| 15-27-103-013 | 15-27-103-014 | 15-27-103-016 | 15-27-103-019 |
| 15-27-103-020 | 15-27-103-021 | 15-27-103-022 | 15-27-103-025 |
| 15-27-103-026 | 15-27-103-028 | 15-27-103-032 | 15-27-103-034 |
| 15-27-103-037 | 15-27-103-038 | 15-27-103-039 | 15-27-103-040 |
| 15-27-104-001 | 15-27-104-002 | 15-27-104-003 | 15-27-104-004 |
| 15-27-104-007 | 15-27-104-009 | 15-27-104-011 | 15-27-104-012 |
| 15-27-104-013 | 15-27-104-018 | 15-27-104-025 | 15-27-104-026 |
| 15-27-104-027 | 15-27-104-028 | 15-27-104-029 | 15-27-104-030 |
| 15-27-104-031 | 15-27-104-032 | 15-27-104-033 | 15-27-104-035 |
| 15-27-104-036 | 15-27-104-038 | 15-27-104-040 | 15-27-104-041 |
| 15-27-104-042 | 15-27-104-043 | 15-27-104-044 | 15-27-104-045 |
| 15-27-104-046 | 15-27-104-047 | 15-27-104-048 | 15-27-104-049 |
| 15-27-107-050 | 15-27-104-051 | 15-27-105-001 | 15-27-105-003 |
| 15-27-105-004 | 15-27-105-005 | 15-27-105-006 | 15-27-105-009 |
| 15-27-105-010 | 15-27-105-011 | 15-27-105-012 | 15-27-105-013 |
| 15-27-105-014 | 15-27-105-018 | 15-27-105-019 | 15-27-105-022 |
| 15-27-105-024 | 15-27-105-027 | 15-27-105-030 | 15-27-105-037 |
| 15-27-105-038 | 15-27-105-039 | 15-27-105-041 | 15-27-105-042 |
| 15-27-105-043 | 15-27-105-044 | 15-27-105-045 | 15-27-105-046 |
| 15-27-105-047 | 15-27-105-048 | 15-27-105-049 | 15-27-105-050 |
| 15-28-200-001 |               |               |               |

4. That on the basis of the foregoing, this Township Board does hereby direct the Supervisor to make a special assessment roll in which shall be entered and described all the parcels of land to be assessed with the names of the respective owners thereof if known, and a total amount to be assessed against such parcel of land which amount shall be the relative portion of the whole sum to be levied against the parcels of land in the Special Assessment District as the benefit to the parcel of land bears to the total benefit to all the parcels of land in the Special Assessment District.



When the same has been completed, the Supervisor shall affix thereto his Certificate stating that it was made pursuant to this Resolution and that in making such assessment roll, he has, according to his best judgment, conformed in all respects to the directions contained in this Resolution and the applicable state statutes.

5. That a second public hearing, for the purpose of providing an opportunity to the property owners involved to review and comment on said Special Assessment Roll, shall be scheduled to be held on Tuesday, September 3<sup>rd</sup>, 2019, at 2:00 p.m. at the Hamburg Township Hall located at 10405 Merrill Road, Hamburg, Michigan.

6. That all Resolutions and parts of Resolutions insofar as they conflict with the provisions of this within Resolutions be and the same are hereby rescinded.

Upon a roll call vote, the following voted "Aye":

The following voted "Nay":

Absent:

Resolution \_\_\_\_\_.

#### **CLERK'S CERTIFICATE**

The undersigned, being the Clerk of the Township, hereby certifies that that (1) the foregoing is a true and complete copy of a resolution duly adopted by the Township Board, and the vote taken thereon, at the meeting described in the introductory paragraph, at which a quorum was present and remained throughout; (2) the original of such resolution is on file in the records in my office; (3) the meeting was conducted, and public notice thereof was given, pursuant to an in full compliance with the Open Meetings Act (Act No. 267, Public Acts of Michigan, 1976, as amended) and (4) minutes of such meeting were kept and have been or will be made available as required thereby.

---

Michael Dolan  
Hamburg Township Clerk