

ORDINANCE NO. 4664-18

AN ORDINANCE TO AMEND THE ZONING MAP OF THE CITY OF JOHNSON CITY, TENNESSEE BEING PART OF THE APPENDIX TO ORDINANCE NO. 1519 ENTITLED "AN ORDINANCE TO ADOPT A CODE OF LAWS AND ORDINANCES FOR THE CITY OF JOHNSON CITY, TENNESSEE, AND TO REPEAL ALL LAWS AND ORDINANCES IN CONFLICT THEREWITH", AND AMENDATORY THEREOF, BY CHANGING FROM B-4 (PLANNED ARTERIAL BUSINESS) DISTRICT TO R-5 (HIGH DENSITY RESIDENTIAL) DISTRICT CERTAIN PROPERTIES (046A-B-017.00, 046A-D-001.15, 046A-D-001.16) LOCATED AT 0 MOCKINGBIRD LANE & NORTH LANE

BE IT ORDAINED BY THE CITY OF JOHNSON CITY AS FOLLOWS:

SECTION 1. That the Zoning Map of the city of Johnson City, Tennessee, being a part of the appendix to Ordinance No. 1519 entitled, "An Ordinance to Adopt a Code of Laws and Ordinances for the City of Johnson City, Tennessee, and to Repeal All Laws and Ordinances in Conflict Therewith," and all ordinances supplementary thereto and amendatory thereof, be and the same is hereby amended and modified by changing the zoning on the following described property from B-4 (Planned Arterial Business) District to R-5 (High Density Residential) District.

See property depiction and Concept Plan marked "Exhibit 'A'" hereto.

See zoning map of the above-described property marked "Exhibit 'B'" hereto.

SECTION 2. BE IT FURTHER ORDAINED, That all ordinances and parts of ordinances in conflict herewith be and the same are hereby repealed.

SECTION 3. BE IT FURTHER ORDAINED, That this ordinance shall take effect from and after its passage on third and final reading and publication as required by law, the public welfare requiring it.

PASSED ON FIRST READING

5 July 2018

PASSED ON SECOND READING

16 August 2018

PASSED ON THIRD READING

15 November 2018

APPROVED AND SIGNED IN OPEN MEETING

ON THE 15th DAY OF November, 2018

/s/ David Tomita

MAYOR

ATTEST:

/s/ Janet Jennings

City Recorder

APPROVED AS TO FORM:

/s/ Erick Herrin

City Attorney

“Exhibit ‘A’”

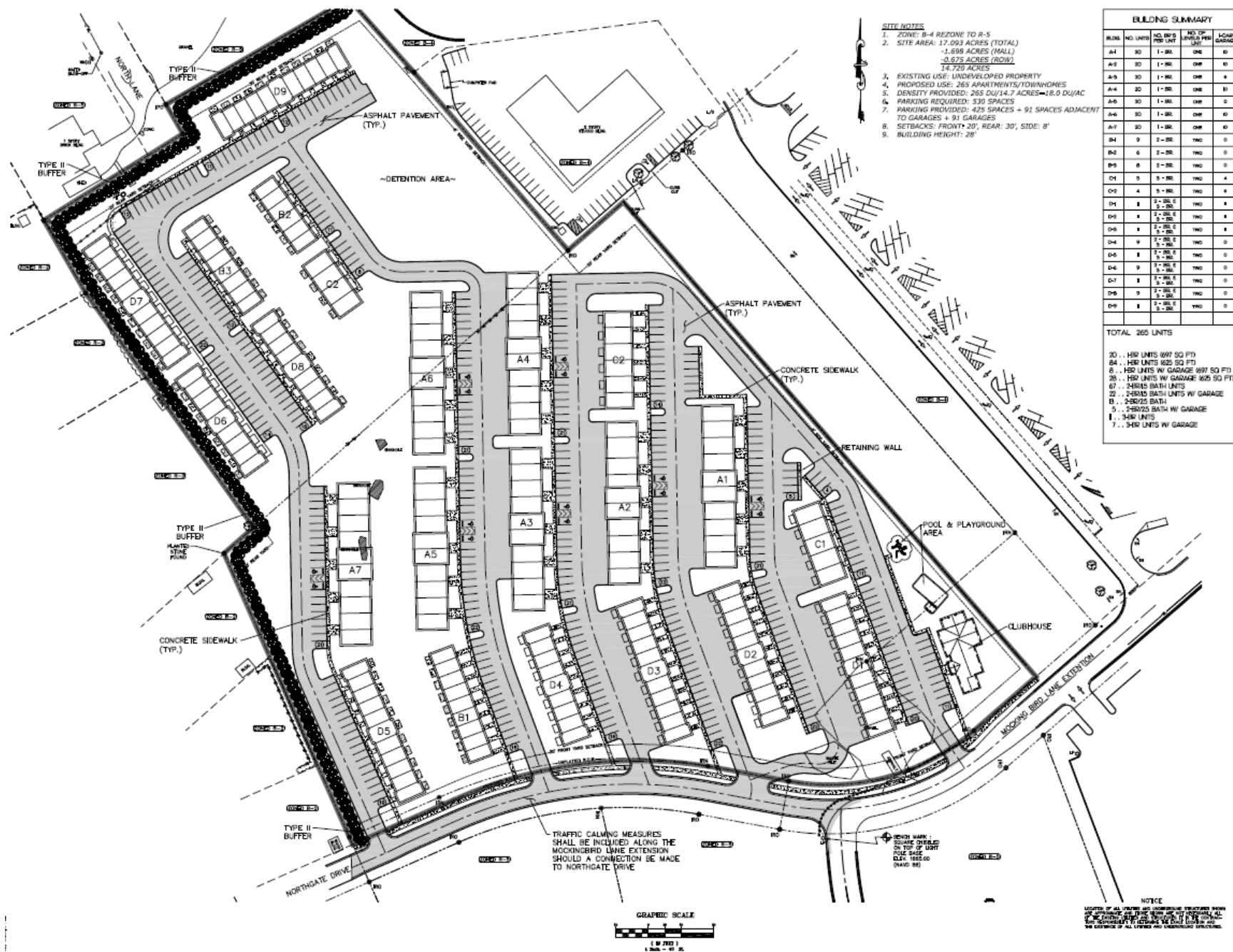

BUILDING SUMMARY				
MODEL	NO. UNITS	NO. BPTS PER UNIT	NO. OF FLOOR	LOAD CAPACITY
A-1	30	1 - Bkt.	ONE	60
A-2	30	1 - Bkt.	ONE	60
A-3	30	1 - Bkt.	ONE	60
A-4	30	1 - Bkt.	ONE	60
A-5	30	1 - Bkt.	ONE	60
A-6	30	1 - Bkt.	ONE	60
A-7	30	1 - Bkt.	ONE	60
B-1	9	2 - Bkt.	TWO	0
B-2	6	2 - Bkt.	TWO	0
B-3	6	2 - Bkt.	TWO	0
C-1	5	3 - Bkt.	TWO	4
C-2	4	3 - Bkt.	TWO	4
D-1	2	3 - Bkt.	TWO	8
D-2	2	3 - Bkt.	TWO	8
D-3	2	3 - Bkt.	TWO	8
D-4	9	3 - Bkt.	TWO	0
D-5	6	3 - Bkt.	TWO	0
D-6	9	3 - Bkt.	TWO	0
D-7	2	3 - Bkt.	TWO	0
D-8	2	3 - Bkt.	TWO	0
D-9	6	3 - Bkt.	TWO	0
TOTAL 265 UNITS				

NO.	DESCRIPTION	DATE
1	OWNER COMMENTS	NOV/14/10
2	OWNER CITY COMMENTS	NOV/14/10
3	CITY COMMENTS	NOV/14/10
4		
5		
6		
7		
8		
9		
10		
11		
12		
13		
14		
15		
16		
17		
18		
19		
20		
21		
22		
23		
24		
25		
26		
27		
28		
29		
30		
31		
32		
33		
34		
35		
36		
37		
38		
39		
40		
41		
42		
43		
44		
45		
46		
47		
48		
49		
50		
51		
52		
53		
54		
55		
56		
57		
58		
59		
60		
61		
62		
63		
64		
65		
66		
67		
68		
69		
70		
71		
72		
73		
74		
75		
76		
77		
78		
79		
80		
81		
82		
83		
84		
85		
86		
87		
88		
89		
90		
91		
92		
93		
94		
95		
96		
97		
98		
99		
100		

"Exhibit 'B'"

