

R33E

R34E

R35E

R36E

Humboldt County

T34N

T33N

ALPHA
MTN

EUGENE MOUNTAINS

EAST RANGE

DUN GLEN
FLAT

Pg 65

Pg 01

Pg 61

Pg 62

Pg 67

Pg 66

Pg 03

Pg 05

Pg 59

Pg 02

Pg 04

Bk 02

Bk 09
Ind 02

Pg 64

Pg 15

Pg 60

Pg 63

Pg 16

Pg 68

Pg 07

Pg 08

Pg 06

Majuba Flat Rd

Callahan Rd

Humboldt River

Tungsten Rd

Kaiser Canyon Rd

Humboldt River

80

Dun Glen Rd

See Detail A

Pg 10

Pg 09

Pg 07

Pg 14

Barber Canyon Rd

Bk 08
Ind 02

Bk 06

Book 08 - Index 01

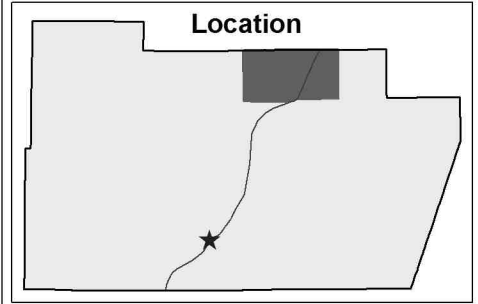

0 2 Mi

Map date: 11/04/2011
Created by: PC Assessor's Office/CPS

Detail A

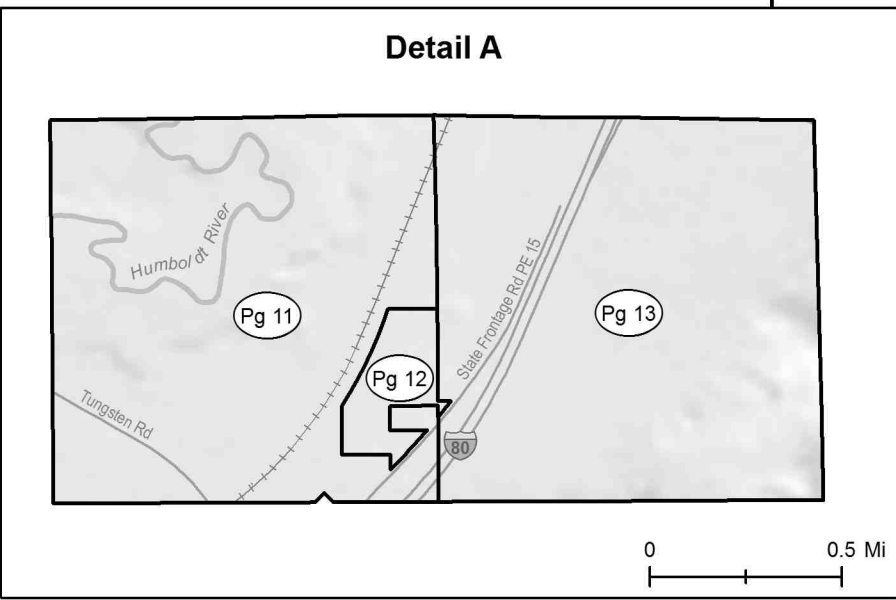

0 0.5 Mi



Assessor's Office
398 Main St
Lovelock, NV 89419
775-273-2369

Disclaimer: This map was prepared for use by the Pershing County Assessor's Office for assessment purposes only. It does not represent a survey. No liability is assumed as to the accuracy of the data delineated hereon or to the sufficiency of the data for any other use.