

11-014-002

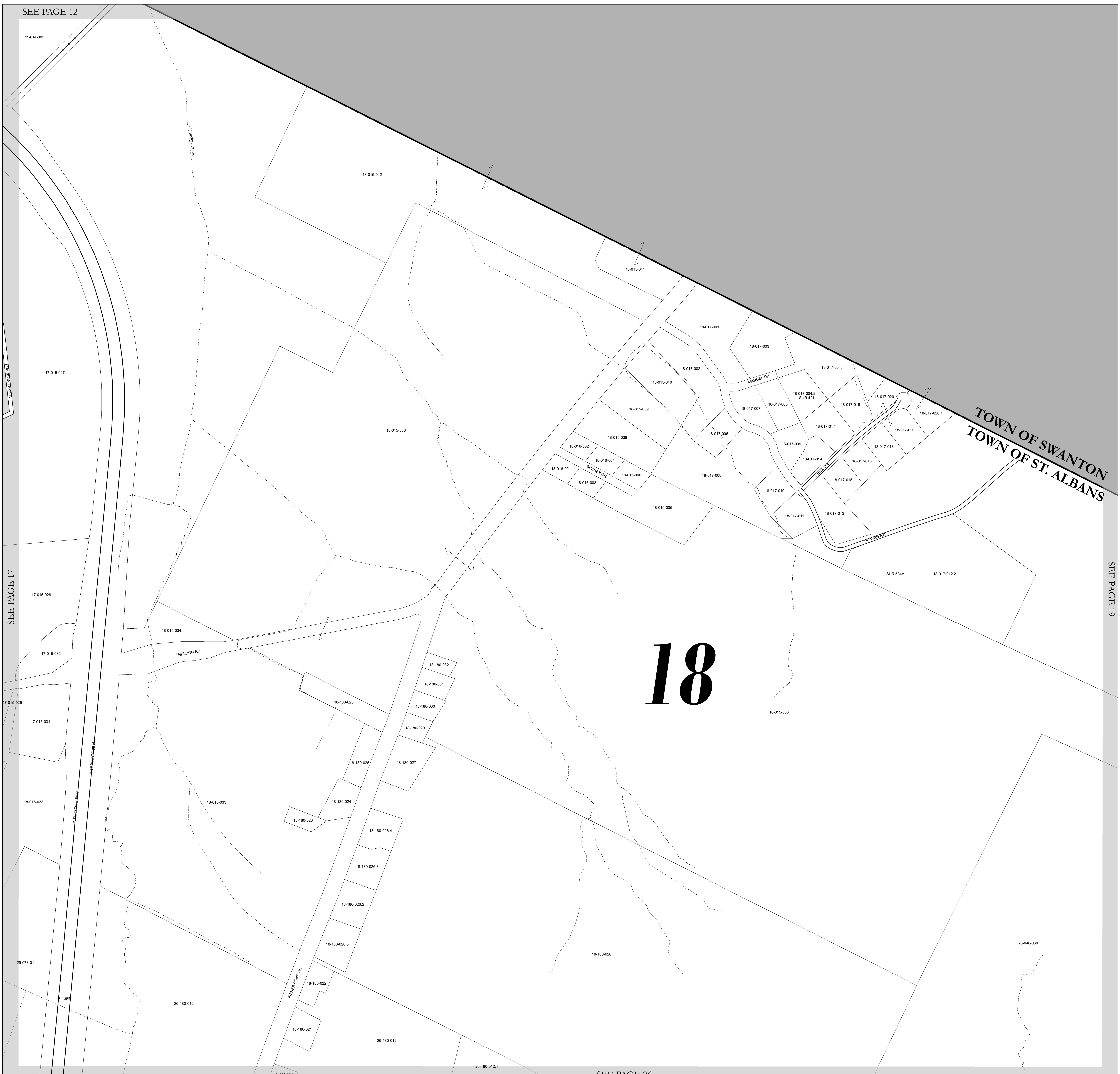

TOWN OF SWANTON  
 TOWN OF ST. ALBANS

18

SEE PAGE 17

SEE PAGE 19

SEE PAGE 26

PARCEL MAP  
**TOWN OF ST. ALBANS**  
 PREPARED BY  
 DEPARTMENT OF COMMUNITY DEVELOPMENT  
 ST. ALBANS, VERMONT  
 (802) 524-7589  
 FOR THE EXCLUSIVE USE OF THE TOWN OF ST. ALBANS

THIS MAP IS FOR ASSESSMENT PURPOSES ONLY.  
 IT IS NOT TO BE USED FOR DESCRIPTION OR  
 CONVEYANCE OF PROPERTY

REVISION TABLE	
DATE	MADE BY

LEGEND

- PROPERTY LINE
- STREAM
- ▬ TOWN BOUNDARY
- ▬ RAILROAD

05-081-018 TAX MAP NUMBER  
 (SUR) SURVEYED PARCEL

N  
 MAP ORIENTATION  
 VERMONT GRID NORTH  
 (NAD 83)

TOWN OF ST. ALBANS	1	2	3	4
-----------------------	---	---	---	---

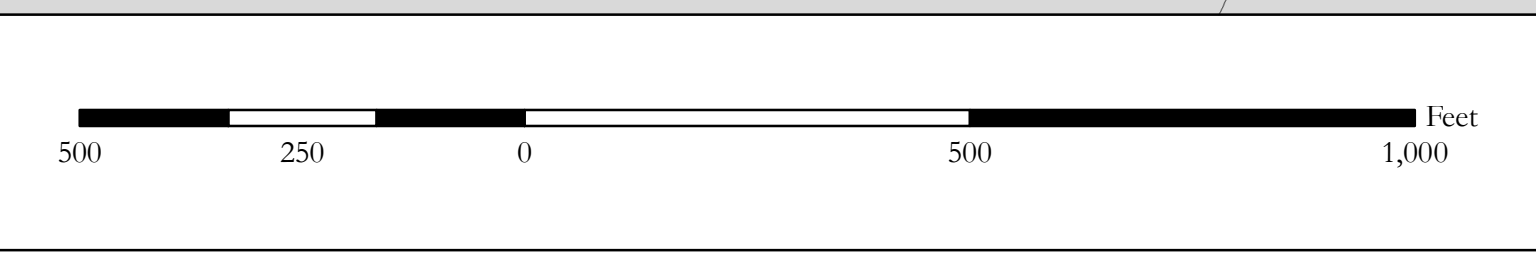

**TOWN OF ST. ALBANS** SHEET NO. **18**