

RECEIVED

MAR 01 2023

WW County Comm Dev.

To: Walla Walla Community Development Department  
Lauren Prentice, Department Director  
310 W. Poplar street # 200, Walla Walla WA 99362

From: Joe Grant

Date: February 21, 2023

Subject: Shoreline Substantial Development Permit  
Dell Sharpe Bridge Replacement on Pettyjohn Road

RE: Hearing on February 13 was improperly closed, it needs to be rescheduled  
My concern is the preservation of the Pettyjohn School house  
I oppose this Permit unless action is taken to prevent future erosion  
of the Pettyjohn school house

At the hearing the examiner asked if there were any more questions,  
I raised my hand and waited to be called on. The examiner continued on.  
I spoke up but the examiner continued and closed the meeting. At that point  
the examiner told me I was out of order.

After the meeting was closed, I spoke to Seth Walker about actions that could be  
implemented to minimize the possibility of the school house being washed out  
by the river. Several options were discussed. Subsequence on February 15 I along  
with Mary Grant Tompkins and Monesa Grant, met with Seth Walker at the site.  
The Dell Sharp Bridge options disussed included;

1. building a concrete containment wall from the North Abutment of  
the new bridge to the north abutment of the existing bridge.
2. Keeping and maintaining the present road elevation to the north  
abutment of the existing Dell Sharp bridge. This option would require  
adding rip rock, as needed, to the abutment to prevent erosion.

Seth Walker will be getting back to me in the near future.

The Pettyjohn School House was built by Jonathan Pettyjohn and neighbors in  
the 1860's and moved it to this location in 1885.

Operation was paid for by area farmers until 1901 when operation was transferred to the Prescott school district. This may be the earliest rural school house still in existence in the county. (A more detailed account is enclosed.)

Copy to: Jennifer B Ballard Community Health Department  
Seth Walker, P.E Public Works Department  
Jenny Mayberry, County Commissioner District #1  
Todd Kimball, County Commissioner District #2  
Gunner Fulmer, County Commissioner District #3

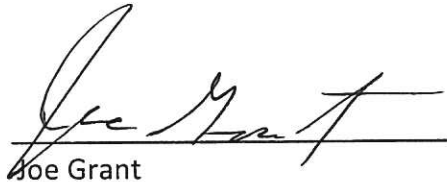
A handwritten signature in black ink, appearing to read "Joe Grant", written over a horizontal line.

Joe Grant

2-26-23

P O Box 1245  
Walla walla WA 99362  
509 301 9546

## THE PETTYJOHN SCHOOL

Jonathan and Hannah Warner Pettyjohn established a school near their log cabin home five miles west of the present town of Prescott, Washington. They paid the teachers themselves in the mid 1860's and thereafter for several years. The American flag displayed at the school was handmade by Hannah. The flag included thirteen stripes and thirteen stars. The stars were arranged in three rows of four with the thirteenth star beginning a fourth row.

In 1885 the school was moved to its present site near the Pettyjohn Road and Bridge and the Touchet River. Over the past 138 years the river has flooded several times, however, the school was never in danger due in part to its protected position near the road and bridge. (We had a wheat fire in 1942 that destroyed the old Pettyjohn log cabin that was built in 1858 but did not harm the schoolhouse.)

There was quite a bit of stalling concerning turning the school and its one and a half acre grounds over to the Prescott School District. Jonathan Pettyjohn refused to approve the transfer unless there was a clause stating that if the building and grounds were no longer used for school purposes all would revert to the family member who owned the adjoining property. The clause was approved in 1901 and the Prescott School District took over control of the Pettyjohn School.

In 1922 the building and grounds were returned to the Pettyjohns as classes were no longer held there. Mary Ellen Pettyjohn Grant owned the adjoining ground and became the owner of the school house. Directors of the Prescott School District at this time were Clyde Brown, Bill Williams, and Winnie Winkle.

Improvements were made to the old building in 1981, including a foundation, new roof, and paint. Workers were Sam Grant, Sam Grant, Jr., Bill Grant, and others. Sam Grant and sister Elda Grant paid for the materials.

WW County Public Works Dept

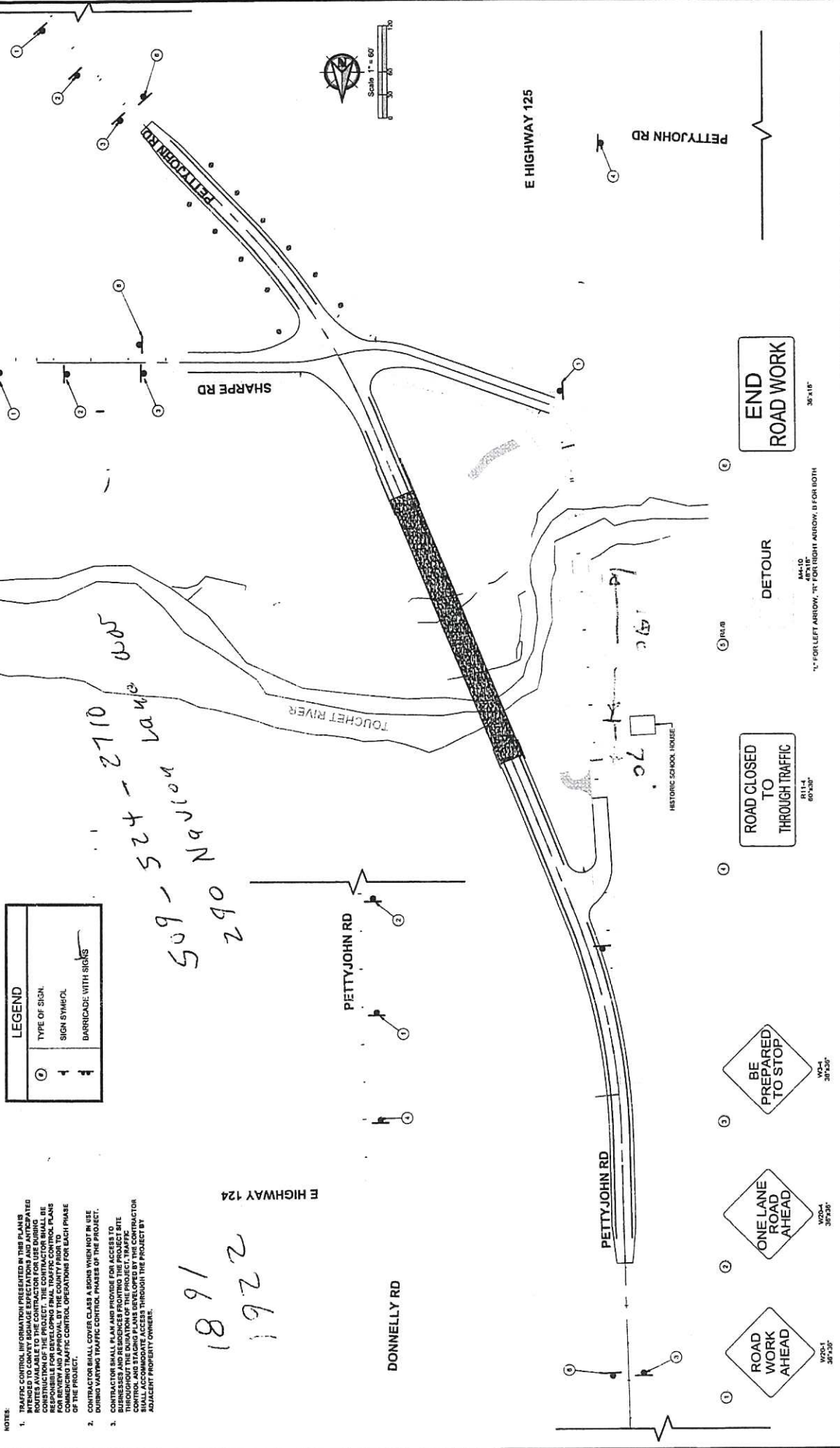

PROJECT NUMBER <b>CRP20-02</b>	
SHEET <b>CS01</b>	
PAGE <b>2</b> OF <b>XX</b>	
<b>DELL SHARPE BRIDGE REPLACEMENT PROJECT</b>	
<b>CONSTRUCTION SIGNING</b>	
 WALLA WALLA COUNTY Public Works Department Walla Walla, Washington, 99382 Phone: 509.324.2010 Web Address: www.wallawalla.com	 BELLEVUE OFFICE: 385 - 118th AVE SE, STE 100 BELLEVUE WA 98005 WWW.TRANTECHENG.COM PH: 425-458-5535 FAX: 425-458-6077
ISSUED / REVISED	DATE
REV. _____	DATE _____
DATE _____	DATE _____