

**BEFORE THE HEARING EXAMINER
FOR WALLA WALLA COUNTY**

Application for a Conditional Use Permit)
and Critical Areas Permit to authorize a)
Type II Bed and Breakfast with ten)
detached guest units and an owner/)
operator living in an existing dwelling on)
Adjusted Lot 3 of BLA22-002, known as)
Applicant's "South Parcel", at the)
applicant's existing Winery property,)
submitted by)

File Nos. CUP 22-004; CAP 22-004

**FINDINGS OF FACT,
CONCLUSIONS OF LAW AND
DECISION APPROVING
REQUESTED PERMITS**

YELLOWHAWK RESORT WW, LLC,)
Applicant)

*(Location: In the south portion of Walla Walla County,
south of the City of College Place, between Highway
125 to the east and Old Milton Highway on the west, a
26+ acre site addressed as 2901 Old Milton Highway,
tax parcel no. 350611120008)*)

I. SUMMARY OF DECISION.

The requested Conditional Use Permit and Critical Areas Permit to develop a Type II Bed and Breakfast on part of the applicant's existing winery property is approved, subject to conditions.

II. BACKGROUND AND RELEVANT CODE PROVISIONS.

The applicant, Yellowhawk Resort WW, LLC ("Yellowhawk", with Scott Clark, as primary Applicant representative), submitted a conditional use permit application for the

**FINDINGS OF FACT, CONCLUSIONS OF LAW AND
DECISION – APPROVING CONDITIONAL USE
PERMIT FOR TYPE II BED AND BREAKFAST ON
THE SOUTH PARCEL OF THE YELLOWBACK
WINERY – FILE NO. CUP22-004**

WALLA WALLA COUNTY HEARING EXAMINER
310 W. POPLAR STREET, SUITE 200
WALLA WALLA, WASHINGTON 99362

1 purpose of receiving authorization to develop and operate a Type II Bed and Breakfast (B&B)
2 on part of the applicant's existing winery property. Yellowhawk operates as a Winery under
3 prior approvals granted by the County.

4 ***Basis and Criteria for approval of Conditional Use Permit.***

5 There is no dispute that the Yellowhawk property is located in the County's Rural
6 Residential (RR-5) zoning district, and that a Type II Bed & Breakfast use is classified as a
7 Conditional Use in the RR-5 zoning district. (See "Permitted Uses" table found at WWCC
8 17.16.014).

9 ***Special development standards for Bed and Breakfast uses.***

10 There is no dispute that the applicant's proposed Bed and Breakfast use falls within
11 the County Code's definition of "Bed and Breakfast Guesthouse" and is subject to specific
12 conditions found in WWCC 17.08.074, which reads as follows:

13 "Bed and breakfast guesthouse" means an establishment located in a primary dwelling unit
14 or accessory building providing overnight accommodations and food services to transients
15 for compensation or utilized by the owner or operator as short-term lodging for travelers and
16 transient guests. A bed and breakfast guesthouse establishment is subject to the following
17 conditions:

18 A. Number of Guest Rooms. A bed and breakfast guesthouse establishment shall not have
19 more than ten guest rooms; travelers or transient guests may not stay longer than thirty
20 consecutive days;

21 B. Occupancy. Property owner or operator occupied;

22 C. Parking. One off-street parking space must be provided for each guest room in addition
23 to any other parking requirements;

24 D. Food Service. Except in the case of Type III bed and breakfasts, only limited food service
25 as permitted under Washington Administrative Code (WAC) Chapter 246-215, Food
26 Service, may be provided. Food service is limited to overnight guests, or, in the case of Type
27 III bed and breakfast guesthouses, 50 guests at a time;

28 E. Signs. Signs associated with this use shall be limited to four square feet in size, except
29 bed and breakfast establishments in a zone which allows signs larger than four square feet
30 may have a larger sign, provided it is in compliance with the size standards for that district.
31 Signs shall meet all setback requirements for the zone in which the bed and breakfast
32 establishment is located.

1 ***Cumulative Impacts on Critical Areas.***

2 WWCC 18.08.020 defines "Cumulative impacts or effects" as follows: "The
3 combined, incremental effects of human activity on critical areas functions and
4 values. Cumulative impacts result when the effects of an action are added to or interact with
5 other effects in a particular place and within a particular time. It is the combination of these
6 effects, and any resulting environmental degradation, that should be the focus
7 of cumulative impact analysis and changes to policies and permitting decisions."

8 Where critical areas are considered as part of a development proposal in a particular
9 area, if a Critical Areas Report is required, such report must include: "An assessment of the
10 probable cumulative impacts to critical areas resulting from development of the site and the
11 proposed development". (See WWCC 18.08.095(C)(6)).

12 ***Jurisdiction of Hearing Examiner:***

13 The County Code vests the Hearing Examiner with authority to hear and issue
14 decisions on applications for Conditional Use Permits. See WWCC 2.50.070(A)(3);
15 14.09.020(C), and 14.09.025. The Hearing Examiner may grant or deny the application, or
16 may attach reasonable conditions, modifications and restrictions found necessary to make the
17 project compatible with its location and to carry out the goals and policies of the applicable
18 comprehensive plan, or other applicable plans or programs adopted by the board of county
19 commissioners. See WWCC 2.50.070(C) and WWCC 14.09.090.F.3.

20 **III. RECORD.**

21 All exhibits entered into evidence as part of the record, and an audio recording of the
22 public hearing, are maintained by the County, and may be examined or reviewed by
23 contacting the County's public records officer.

24 ***Exhibits:***

- 25 1. *Staff Report* – Walla Walla County Community Development Department Staff Report and
26 Recommendation of Approval to the Hearing Examiner for the Doubleback Winery Type II Bed and
Breakfast application, prepared by Associate Planner, Jennifer Ballard, dated October 13, 2022 (nine
pages, with the following attached Exhibits);
2. Conditional Use Permit application (CUP22-004) and Exhibit A dated 1/26/2022
3. SEPA Checklist (SEPA22-004) dated 1/14/2022
4. SEPA Checklist Staff Evaluation Report dated 9/19/2022
5. Geotechnical Report by PBS Engineering dated 1/17/2022
6. Site Plan submitted 7/5/2022 and Plans submitted for SCR22-0207
7. Trip Generation Letter/Tier 1 Traffic Impact Analysis dated 7/1/2022
8. Comments from the Department of Ecology dated 3/24/2022

27 **FINDINGS OF FACT, CONCLUSIONS OF LAW AND
28 DECISION – APPROVING CONDITIONAL USE
PERMIT FOR TYPE II BED AND BREAKFAST ON
THE SOUTH PARCEL OF THE YELLOWBACK
WINERY – FILE NO. CUP22-004**

WALLA WALLA COUNTY HEARING EXAMINER
310 W. POPLAR STREET, SUITE 200
WALLA WALLA, WASHINGTON 99362

9. Comments from WSDOT 3/22/2022
10. Comments from DAHP dated 3/23/2022
11. Comments from Walla Walla County Public Works dated 3/29/2022 (Stormwater) and 9/21/2022 (Traffic)
12. Email from Department of Ecology Watermaster dated 4/14/2022
13. Ground Water Certificate 2982-A
14. SEPA Determination of Mitigated Non-Significance dated 10/5/2022
15. Notice of Application ODNs and Certificate
16. Notice of Public Hearing and Certificate
17. Comments from County Building Official/Fire Marshal
18. Critical Areas Application, CAP22-006
19. Written Public Comment from Susan Bicknell dated 10/7/2022
20. Written Public Comment from G&S Owsley, dated 10/18/2022
21. Written Public Comment from D&M Brower, dated 10/20/2022
22. Written Public Comment from RL McFarland, day of hearing, 10/20/2022
23. Written Public Comment from C Vinti, day of hearing, 10/20/2022
24. Written Public Comment from B Brown, day of hearing, 10/20/2022
25. Applicant's Response to Public Comments, dated 10/25/2022
26. Site Plan sheet showing 50-foot steep slope buffer, dated 10/27/2022
27. Plat of Applicant's property before BLA in following exhibit, Amended Mussman Short Plat 2003-23 Recorded on 11/03/2003, with recording number AFN 2003-17039 [*Added by the Examiner]
28. Boundary Line Adjustment BLA22-002, modifying lot configurations on Applicant's property, Recorded on 09/16/2022, under recording number AFN 2022-07726 [*Added by the Examiner]

Testimony: The public hearing for this matter was conducted using a hybrid in-person and online audio/video platform coordinated by County staff, accessible to parties and members of the public using sign-in details provided in public notices. The Hearing Examiner presided in-person with numerous participants and members of the public present in a Department conference room, and several members of the public observed or testified via the online platform. The applicant confirmed that they would like the hearing for both applications, for CUPs on the North and South parcels, consolidated into a single hearing. The following persons provided testimony under oath as part of the record during the open-record consolidated hearing held on October 20, 2022:

1. Jennifer Ballard, Senior Planner, and primary Staff Contact for the pending application, for Walla Walla County;
2. Scott Clark, Applicant, Yellowhawk co-owner, lead applicant representative;
3. Philip Chistofides, project architect, Yellowhawk co-owner;
4. JaiDee Taruscio, local property owner, expressed general concerns about noise from concerts and the like that she hasn't complained about but hears from her property, luxury project with expensive cabanas could cause agricultural type businesses to move away;
5. Mike Eggleston, read letter from the Brower's into record, expressed general concerns about possible noise, traffic, light at night, septic impacts on wells, feels this is a hotel and not a true B&B;
6. Brenda Brown, owns property along Hwy 125, opposes project, expressed general concerns about too many tourists in Ag area, traffic, noise, wells, crime, luxury resort causing property values to increase causing her taxes to go up, littering, does not want luxury resort "in her

**FINDINGS OF FACT, CONCLUSIONS OF LAW AND
DECISION – APPROVING CONDITIONAL USE
PERMIT FOR TYPE II BED AND BREAKFAST ON
THE SOUTH PARCEL OF THE YELLOWBACK
WINERY – FILE NO. CUP22-004**

WALLA WALLA COUNTY HEARING EXAMINER
310 W. POPLAR STREET, SUITE 200
WALLA WALLA, WASHINGTON 99362

back yard”;

7. Lon Ferguson, local resident, expressed concerns about traffic along Old Milton Hwy., not a win-win for folks in the area, concern about negative impacts on surrounding area, notes that he has called Sheriff’s Dept. to report noise problems from the Yellowhawk property, concern that more project like this will come, general concerns about cumulative impacts from multiple projects like this one;
8. Connie R Vinti, local resident, opposes applications, notes this is a Commercial venue that does not fit in the Rural Residential zone;
9. R.L. McFarland, appeared online, summarized written comments included as part of Ex. 22, opposes applications noting that two B&B permits might allow for more units than would be allowed under the County’s Type III winery codes and amendments proposed by the applicant, expressed concerns about steep slopes, wants only buildable acreage used to determine if enough acreage is available for project;
10. Linda Washington-Fory, opposes applications, believes the project will cause bad impacts with nothing good for local residents.

Site Visit: The Examiner personally visited the Yellowhawk winery property and conducted a site visit to the project location and surrounding road network on the day of the hearing.

IV. FINDINGS OF FACT.

Based on the record, and following consideration of all the evidence, testimony, codes, policies, regulations, and other information included therein, the undersigned issues the following findings of fact:

1. All statements of fact included in previous or following sections of this Decision that are deemed to be findings of fact are incorporated by reference into this section as findings of fact issued by the Hearing Examiner.
2. This application for a Conditional Use Permit is for the purpose of authorizing development and operation of a Type II Bed and Breakfast establishment on a portion of the applicant’s existing Winery property, known as the Yellowhawk Resort and Sparkling Winery, located on the east side of Old Milton Highway and west of Highway 125, in the south part of unincorporated Walla Walla County. (*Staff Report, page 3*) This Decision addresses the B&B proposed on the “South Parcel”, a 26.68-acre site. (*Id.*).
3. The applicant’s website provides the following history regarding the property, once known the Basel Cellars winery:

Yellowhawk Resort is an 84-acre hillside retreat featuring Walla Walla’s only sparkling winery and tasting room with farm-to-table dining, swimming pool and cabanas, lodging and event space for weddings, reunions, and

1 corporate retreats. The elevated hilltop setting provides a sweeping
2 outlook on the fields of wheat, lush vineyards, and Blue Mountains.

3 Originally built in 1997 as a private residence, the Estate House at Basel
4 Cellars was once one of the finest homes in the Walla Walla valley. It was
5 purchased in 2002 and converted to Basel Estate Winery & Resort. In
6 December 2020, Pacific Northwest hospitality leaders Dan Thiessen, Chad
7 Mackay, Scott Clark, Philip Christofides and Paul Mackay purchased the
8 property and changed the name to Yellowhawk Resort, and the winery
9 shifted to a sparkling wine program led by winemaker George-Anne
10 Robertson.

11 *(Excerpt from Yellowhawkresort.com, page captioned "About Yellowhawk Resort").*

- 12 4. Notes on the applicant's proposed Site Plans (See Ex. 24) include the following
13 explanation:

14 **NOTE TO REVIEWER**

15 UNDER A SEPARATE APPLICATION, THE
16 PROPERTY OWNER IS REQUESTING THE
17 APPROVAL OF A BOUNDARY LINE
18 ADJUSTMENT OF THE TWO EXISTING
19 PARCELS. THE APPLICANT IS PROPOSING
20 TO CONSTRUCT A TYPE 2 BED AND
21 BREAKFAST FACILITY ON EACH
22 RECONFIGURED PARCEL. THE SOUTHERN
23 PARCEL GUEST UNITS ARE SHOWN
24 HEREON AS "FIG 2". THE NORTHERN
25 PARCEL GUEST UNITS ARE SHOWN AS "FIG
26 1" UNDER A SEPARATE APPLICATION.

5. Given such circumstance, this application was not complete and could not have been
approved as designed before a boundary line adjustment was approved. In any event,
Boundary Line Adjustment No. BLA22-002, modifying lot configurations on the Applicant's
property, was approved and recorded on September 16, 2022, under recording number AFN
2022-07726, and has been added into the record by the Examiner as Ex. 28.

6. This Decision addresses the application for the applicant's "South Parcel." There is
a separate CUP application that was consolidated into the same hearing process for this
permit, for a Type II B&B on the applicant's "North Parcel." The Site Plan for both
applications on the Yellowhawk property is provided below (Ex. 6, Sheet A1.1):

25 FINDINGS OF FACT, CONCLUSIONS OF LAW AND
26 DECISION – APPROVING CONDITIONAL USE
PERMIT FOR TYPE II BED AND BREAKFAST ON
THE SOUTH PARCEL OF THE YELLOWBACK
WINERY – FILE NO. CUP22-004

WALLA WALLA COUNTY HEARING EXAMINER
310 W. POPLAR STREET, SUITE 200
WALLA WALLA, WASHINGTON 99362

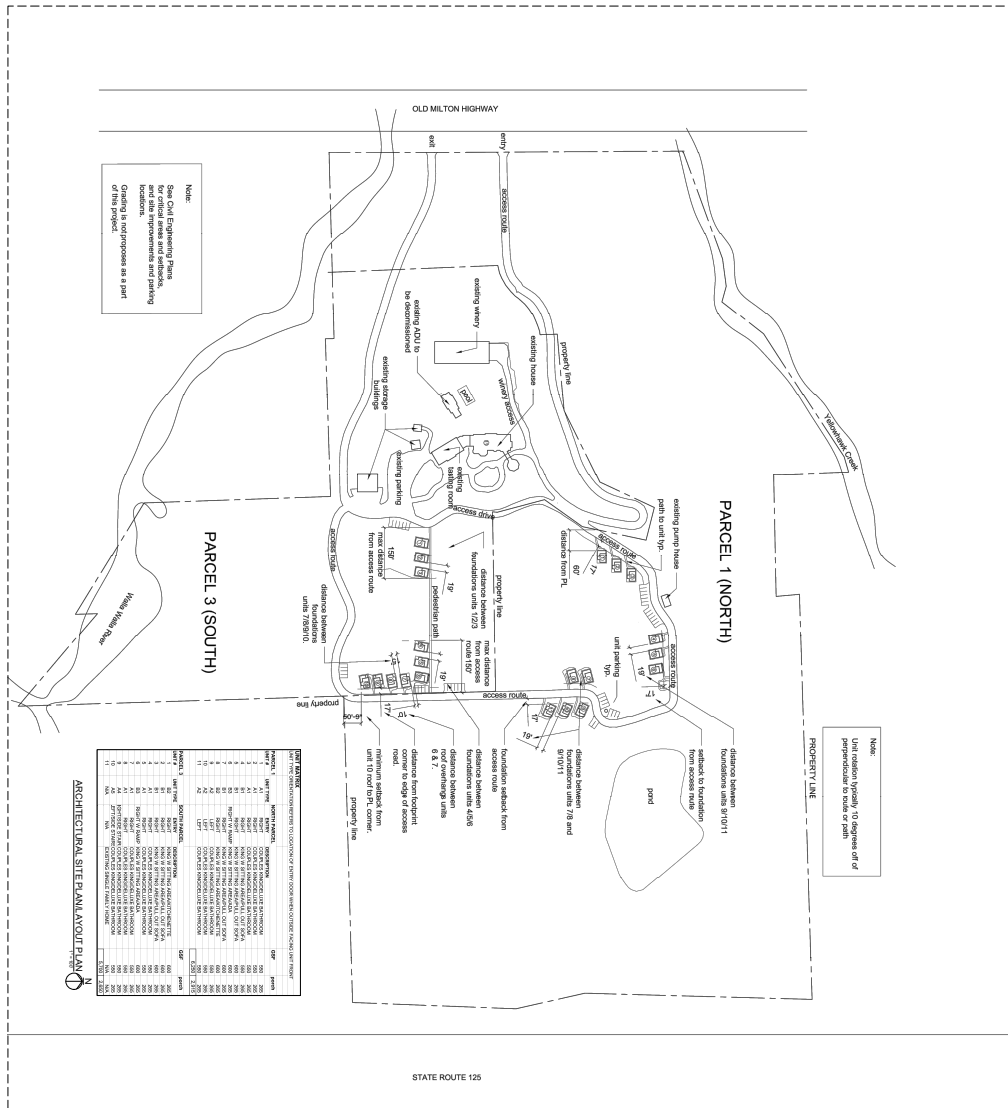

A1.1

YELLOWHAWK

ARCHITECT

310 W. POPLAR STREET, SUITE 200
WALLA WALLA, WASHINGTON 99362

FINDINGS OF FACT, CONCLUSIONS OF LAW AND DECISION – APPROVING CONDITIONAL USE PERMIT FOR TYPE II BED AND BREAKFAST ON THE SOUTH PARCEL OF THE YELLOWBACK WINERY – FILE NO. CUP22-004

WALLA WALLA COUNTY HEARING EXAMINER
310 W. POPLAR STREET, SUITE 200
WALLA WALLA, WASHINGTON 99362

7. This application seeks approval to develop 10 (ten) detached guest units, each with its own restroom, ranging in size 550 – 600 square feet. Under this permit for the South Parcel, the on-site B&B operator/manager will live in the existing house on the site. (*Site Plans; Testimony of Ms. Ballard*). The proposed Site Plan includes a chart providing a description of the units proposed on both the North and South parcels, unit type/design (shown on other pages), and approximate sizes, which is enlarged and republished below (screenshot from Ex. 6, on Sheet A1.1):

UNIT MATRIX					
UNIT TYPE ORIENTATION REFERS TO LOCATION OF ENTRY DOOR WHEN OUTSIDE FACING UNIT FRONT					
PARCEL 1 NORTH PARCEL				GSF	porch
UNIT #	UNIT TYPE	ENTRY	DESCRIPTION		
1	A1	RIGHT	COUPLES KING/DELUXE BATHROOM	550	265
2	A1	RIGHT	COUPLES KING/DELUXE BATHROOM	550	265
3	A1	RIGHT	COUPLES KING/DELUXE BATHROOM	550	265
4	B1	RIGHT	KING W SITTING AREA/PULL OUT SOFA	550	265
5	B1	RIGHT	KING W SITTING AREA/PULL OUT SOFA	600	265
6	B3	RIGHT W RAMP	KING W SITTING AREA/ADA	600	265
7	B1	RIGHT	KING W SITTING AREA/PULL OUT SOFA	600	265
8	B2	RIGHT	KING W SITTING AREA/KITCHENETTE	600	265
9	A2	LEFT	COUPLES KING/DELUXE BATHROOM	550	265
10	A2	LEFT	COUPLES KING/DELUXE BATHROOM	550	265
11	A2	LEFT	COUPLES KING/DELUXE BATHROOM	550	265
				6,250	2,915
PARCEL 3 SOUTH PARCEL				GSF	porch
UNIT #	UNIT TYPE	ENTRY	DESCRIPTION		
1	B2	RIGHT	KING W SITTING AREA/KITCHENETTE	600	265
2	B1	RIGHT	KING W SITTING AREA/PULL OUT SOFA	600	265
3	B1	RIGHT	KING W SITTING AREA/PULL OUT SOFA	600	265
4	A1	RIGHT	COUPLES KING/DELUXE BATHROOM	550	265
5	A1	RIGHT	COUPLES KING/DELUXE BATHROOM	550	265
6	B3	RIGHT W RAMP	KING W SITTING AREA/ADA	600	265
7	A1	RIGHT	COUPLES KING/DELUXE BATHROOM	550	265
8	A1	RIGHT	COUPLES KING/DELUXE BATHROOM	550	265
9	A4	RIGHT/SIDE STAIR	COUPLES KING/DELUXE BATHROOM	550	265
10	A5	LEFT/SIDE STAIRS	COUPLES KING/DELUXE BATHROOM	550	265
11	N/A	N/A	EXISTING SINGLE FAMILY HOME	N/A	N/A
				5,700	2,650

8. Any subsequent plans to expand the number of guest units, or other significant modifications, will require a separate Conditional Use Permit, requiring a new application, public notices and opportunities for comment, staff review, and a public hearing before the

FINDINGS OF FACT, CONCLUSIONS OF LAW AND
DECISION – APPROVING CONDITIONAL USE
PERMIT FOR TYPE II BED AND BREAKFAST ON
THE SOUTH PARCEL OF THE YELLOWBACK
WINERY – FILE NO. CUP22-004

WALLA WALLA COUNTY HEARING EXAMINER
310 W. POPLAR STREET, SUITE 200
WALLA WALLA, WASHINGTON 99362

County's Hearing Examiner.

9. This Conditional Use Permit is limited in scope, and it is expressly conditioned in this Decision to authorize only the number and nature of structures identified in the application materials and available for public review and comment in connection with notices, SEPA environmental reviews, and the public hearing process for this application. This Decision is in no way affected by the applicant's recent requests for changes in the County's zoning codes, as mentioned by various hearing witnesses.

10. Staff reviewed the application materials, including the SEPA Checklist (*Ex. 3*) and relevant environmental information, resulting in the County's final SEPA threshold Mitigated Determination of Non-Significance (MDNS) for the project, issued on or about October 5, 2022 (*Exhibit 14*). Public notices and requests for comments, regarding the pending application and environmental review, from members of the public, adjacent property owners, and relevant state and local agencies, were provided in accord with standard County practices. (*Staff Report, Exs. 15-16, public noticing materials; all written comments from agencies and members of the public*). No one appealed the MDNS, so the threshold determination stands unchallenged for purposes of issuing this Decision.

11. As noted above, a Conditional Use Permit is required for Type II Bed and Breakfast establishment located on land zoned RR-5. The criteria for approval of a conditional use permit (CUP) are found at WWCC 17.40.020. The Hearing Examiner is delegated specific authority to hear, consider, and decide on applications for conditional use permits. *See WWCC 17.16.014 and 2.50.070(A)(3)*. The Examiner is also delegated specific authority to condition or modify a proposal to make the project compatible with its location, provisions of the County's Comprehensive Plan, or county development regulations. *See WWCC 2.50.070(C) and WWCC 14.09.090.F.3*.

12. In accord with applicable county project review regulations, Jennifer Ballard, the County's designated planner for this matter, reviewed the application materials, and generated a Staff Report, which was issued to the Examiner before the public hearing.

13. The open-record public hearing for the conditional use permit was duly noticed in accord with law and the hearing occurred on October 20, 2022.

14. During the public hearing, Ms. Ballard summarized the Staff Report, describing the scale of the project, limits on B&B operations, a SEPA condition requiring a Cultural Resources Report, steep slope considerations as part of the Critical Areas review, traffic impact analysis with no additional mitigation required, Fire Marshall comments requiring sprinkler systems in cottages unless exemptions/exceptions apply, and her recommendation of approval subject to conditions. She clarified that the hearing was not intended to cover proposed code amendments pursued by the applicant, only the CUP requested for a Type II

**FINDINGS OF FACT, CONCLUSIONS OF LAW AND
DECISION – APPROVING CONDITIONAL USE
PERMIT FOR TYPE II BED AND BREAKFAST ON
THE SOUTH PARCEL OF THE YELLOWBACK
WINERY – FILE NO. CUP22-004**

WALLA WALLA COUNTY HEARING EXAMINER
310 W. POPLAR STREET, SUITE 200
WALLA WALLA, WASHINGTON 99362

1 B&B.

2 15. The Examiner finds that public comments opposing a bed and breakfast as generally
3 incompatible with Agricultural uses run counter to County codes that allow such uses in the
4 RR-5 zone subject to requirements for a conditional use permit, noting that another B&B
5 permit was recently issued for another winery in the County. The Examiner is only aware of
6 two wineries with separate approvals to operate a Type II Bed and Breakfast, and both of
7 those wineries have adequate space to comply with applicable standards, including
8 restrictions on allowed units per acre that could be permitted for a Type III winery, and
9 sufficient undeveloped "agricultural land" on each site. While this is NOT a Type III winery
10 application, the Examiner notes that the two CUP applications addressed in this consolidated
11 hearing process would not result in density or loss of agricultural lands exceeding limits for
12 a Type III winery. Subsequent applications, if any, may need to address such situation.

13 16. The applicant witnesses, Mr. Clark and Mr. Christofides, clarified a few issues raised
14 by Ms. Ballard, noting that the project is designed to satisfy all applicable steep slope
15 setbacks/buffers. After the hearing, as authorized by the Examiner during the hearing, Mr.
16 Clark submitted a page from the project Site Plan illustrating this point, showing steep slopes,
17 buffers, and building locations. (See Ex. 26). Applicant witnesses explained that the existing
18 kitchen in the "pool-house" on the South Parcel will be removed, and the pool house will not
19 be offered for-rent. Mr. Christofides noted that the applicant intends to comply with
20 applicable Fire Codes, but they intend to pursue any exemptions/exceptions that may apply
21 to sprinkler requirements. This Decision does not limit the Fire Marshall's authority to
22 address the topic in accord with applicable County codes and policies at the time of building
23 permit reviews for this project.

24 17. The Staff Report and exhibits included in the record constitute a preponderance of
25 evidence that demonstrates how the pending CUP application, as conditioned, is consistent
26 with the County's Comprehensive Plan. *Staff Report, at pages 5 and 6, citing relevant*
Comp. Plan Goals and Policies.

As Conditioned, the pending application satisfies the approval criteria for a Conditional Use Permit.

20 18. Based on evidence in the record, the Examiner finds and concludes that, as
21 conditioned, the proposed Type II Bed and Breakfast satisfies all of the approval criteria for
22 a Conditional Use Permit set forth in WWCC 17.40.020(A – F). Except as modified in this
23 Decision, the Staff Report's explanations of how the pending application complies with such
24 criteria are expressly adopted as findings of the Hearing Examiner. (Staff Report, pages 7
25 and 8).

1
2 ***Critical Areas considerations.***

3 19. Critical areas in Walla Walla County are regulated under WWCC Chapter 18.08. As
4 provided in WWCC 18.08.060.B, if a project requires another permitting action by the county
5 that requires a public hearing (like the Conditional Use Permit addressed in this Decision),
6 consideration of critical areas will be integrated with the underlying permitting process. The
7 Examiner finds and concludes that Staff's review of the requested permit appropriately
8 integrated consideration of potential critical areas issues associated with the proposed Bed &
9 Breakfast use.

10 20. The applicant's Geotech Report and Ex. 26 establish that the project has been
11 designed to avoid impacts on steep slopes. Other Critical Areas and buffers, for creeks,
12 streams and the like, are located well outside any jurisdictional limits for this application.
13 Thus, the applicant's requested critical areas permit should be approved for this project,
14 noting that subsequent applications for additional uses on the applicant's larger winery/resort
15 property, may trigger the need for new or additional Critical Areas Reports, and such reports
16 must include an analysis of cumulative impacts, as explained in applicable County codes. An
17 additional condition of approval has been added to clarify this subject.

18 ***Bed and Breakfast Development Standards; Concerns expressed by local residents.***

19 21. Bed and Breakfast establishments must comply with special conditions found in
20 WWCC 17.08.074. The Conditions of Approval for this permit are written to ensure that the
21 applicant's proposed Bed and Breakfast establishment will be consistent with these
22 requirements, including those limiting guest stays to not more than thirty consecutive days,
23 mandating owner/operator occupancy on the site, and parking, among other things.

24 22. Witness testimony provided a preponderance of credible evidence establishing the
25 need for better ways to "enforce" reasonable conditions after B&B operations commence.
26 Surrounding property owners described legitimate concerns about potential noise, smoke,
possible trespassers, and the like – all among the sorts of issues that a call to an on-site
property manager/agent might resolve more quickly than calls for service directed to the
Sheriff's Office.

27 23. Accordingly, the Examiner has added a condition of approval, requiring the applicant
28 to provide the Director and all property owners within five hundred (500) feet of the project
29 site the name and contact information for a designated local property representative who lives
30 on-site where the B&B is located and will respond to complaints and emergencies; and a
valid telephone number where the local property representative can be reached twenty-four
(24) hours per day. (*See Condition of Approval No. 13*).

31
32
33
34
35
36
37
38
39
40
41
42
43
44
45
46
47
48
49
50
51
52
53
54
55
56
57
58
59
60
61
62
63
64
65
66
67
68
69
70
71
72
73
74
75
76
77
78
79
80
81
82
83
84
85
86
87
88
89
90
91
92
93
94
95
96
97
98
99
100
101
102
103
104
105
106
107
108
109
110
111
112
113
114
115
116
117
118
119
120
121
122
123
124
125
126
127
128
129
130
131
132
133
134
135
136
137
138
139
140
141
142
143
144
145
146
147
148
149
150
151
152
153
154
155
156
157
158
159
160
161
162
163
164
165
166
167
168
169
170
171
172
173
174
175
176
177
178
179
180
181
182
183
184
185
186
187
188
189
190
191
192
193
194
195
196
197
198
199
200
201
202
203
204
205
206
207
208
209
210
211
212
213
214
215
216
217
218
219
220
221
222
223
224
225
226
227
228
229
230
231
232
233
234
235
236
237
238
239
240
241
242
243
244
245
246
247
248
249
250
251
252
253
254
255
256
257
258
259
260
261
262
263
264
265
266
267
268
269
270
271
272
273
274
275
276
277
278
279
280
281
282
283
284
285
286
287
288
289
290
291
292
293
294
295
296
297
298
299
300
301
302
303
304
305
306
307
308
309
310
311
312
313
314
315
316
317
318
319
320
321
322
323
324
325
326
327
328
329
330
331
332
333
334
335
336
337
338
339
340
341
342
343
344
345
346
347
348
349
350
351
352
353
354
355
356
357
358
359
360
361
362
363
364
365
366
367
368
369
370
371
372
373
374
375
376
377
378
379
380
381
382
383
384
385
386
387
388
389
390
391
392
393
394
395
396
397
398
399
400
401
402
403
404
405
406
407
408
409
410
411
412
413
414
415
416
417
418
419
420
421
422
423
424
425
426
427
428
429
430
431
432
433
434
435
436
437
438
439
440
441
442
443
444
445
446
447
448
449
450
451
452
453
454
455
456
457
458
459
460
461
462
463
464
465
466
467
468
469
470
471
472
473
474
475
476
477
478
479
480
481
482
483
484
485
486
487
488
489
490
491
492
493
494
495
496
497
498
499
500
501
502
503
504
505
506
507
508
509
510
511
512
513
514
515
516
517
518
519
520
521
522
523
524
525
526
527
528
529
530
531
532
533
534
535
536
537
538
539
540
541
542
543
544
545
546
547
548
549
550
551
552
553
554
555
556
557
558
559
560
561
562
563
564
565
566
567
568
569
570
571
572
573
574
575
576
577
578
579
580
581
582
583
584
585
586
587
588
589
590
591
592
593
594
595
596
597
598
599
600
601
602
603
604
605
606
607
608
609
610
611
612
613
614
615
616
617
618
619
620
621
622
623
624
625
626
627
628
629
630
631
632
633
634
635
636
637
638
639
640
641
642
643
644
645
646
647
648
649
650
651
652
653
654
655
656
657
658
659
660
661
662
663
664
665
666
667
668
669
670
671
672
673
674
675
676
677
678
679
680
681
682
683
684
685
686
687
688
689
690
691
692
693
694
695
696
697
698
699
700
701
702
703
704
705
706
707
708
709
710
711
712
713
714
715
716
717
718
719
720
721
722
723
724
725
726
727
728
729
730
731
732
733
734
735
736
737
738
739
740
741
742
743
744
745
746
747
748
749
750
751
752
753
754
755
756
757
758
759
760
761
762
763
764
765
766
767
768
769
770
771
772
773
774
775
776
777
778
779
780
781
782
783
784
785
786
787
788
789
790
791
792
793
794
795
796
797
798
799
800
801
802
803
804
805
806
807
808
809
810
811
812
813
814
815
816
817
818
819
820
821
822
823
824
825
826
827
828
829
830
831
832
833
834
835
836
837
838
839
840
841
842
843
844
845
846
847
848
849
850
851
852
853
854
855
856
857
858
859
860
861
862
863
864
865
866
867
868
869
870
871
872
873
874
875
876
877
878
879
880
881
882
883
884
885
886
887
888
889
890
891
892
893
894
895
896
897
898
899
900
901
902
903
904
905
906
907
908
909
910
911
912
913
914
915
916
917
918
919
920
921
922
923
924
925
926
927
928
929
930
931
932
933
934
935
936
937
938
939
940
941
942
943
944
945
946
947
948
949
950
951
952
953
954
955
956
957
958
959
960
961
962
963
964
965
966
967
968
969
970
971
972
973
974
975
976
977
978
979
980
981
982
983
984
985
986
987
988
989
990
991
992
993
994
995
996
997
998
999
1000

FINDINGS OF FACT, CONCLUSIONS OF LAW AND
DECISION – APPROVING CONDITIONAL USE
PERMIT FOR TYPE II BED AND BREAKFAST ON
THE SOUTH PARCEL OF THE YELLOWBACK
WINERY – FILE NO. CUP22-004

WALLA WALLA COUNTY HEARING EXAMINER
310 W. POPLAR STREET, SUITE 200
WALLA WALLA, WASHINGTON 99362

1 24. Based on the record, the Examiner finds that the underlying project has been
2 reviewed in substantial compliance with applicable SEPA procedures. Witness testimony
3 expressing displeasure with provisions of the County's zoning code are outside the
4 Examiner's jurisdiction. No one submitted a preponderance of evidence that would serve as
5 a basis to deny the pending permit. However, subsequent applications for a similar use on
6 the same winery property may be subject to additional conditions, limits on units, and the
7 like, or could be denied, if they are inconsistent with then-applicable County codes or
8 policies.

9 25. Except as modified in this Decision, all Findings, and statements of fact contained in
10 the Staff Report, are incorporated herein by reference as Findings of the undersigned hearing
11 examiner.

12 V. CONCLUSIONS OF LAW.

13 1. As explained above, the record, particularly the Staff Report, includes a
14 preponderance of evidence that the pending permit application satisfies all applicable
15 decision criteria specified in the County's code.

16 2. Any finding or other statement contained in this Decision that is deemed to be a
17 Conclusion of Law is hereby adopted as such and incorporated by reference.

18 VI. DECISION.

19 Based upon the preceding Findings of Fact and Conclusions of Law, evidence
20 presented through the course of the open record hearing, all materials contained in the
21 contents of the record, and the examiner's previous site visits to the area in connection with
22 other matters, the undersigned Examiner APPROVES the Conditional Use Permit for the
23 Yellowhawk Type II Bed and Breakfast, South Parcel Project (File No. CUP22-004), subject
24 to the following Conditions of Approval:

25 CONDITIONS OF APPROVAL

26 1. As provided in Walla Walla County Code Section 17.40.025, the action for which the
conditional use permit is required shall begin within one year of approval unless extended
for up to one year by the Director. Failure to begin such action within the time limits
specified shall void approval of the conditional use.

2. Before construction, the applicant must first obtain any and all associated permit(s) or
approvals required by the County or any other governmental agency or regulatory
authority with jurisdiction over a particular aspect of the project. Any conditions of
approval or requirements imposed as part of such permits or approvals shall be and are

**FINDINGS OF FACT, CONCLUSIONS OF LAW AND
DECISION – APPROVING CONDITIONAL USE
PERMIT FOR TYPE II BED AND BREAKFAST ON
THE SOUTH PARCEL OF THE YELLOWBACK
WINERY – FILE NO. CUP22-004**

WALLA WALLA COUNTY HEARING EXAMINER
310 W. POPLAR STREET, SUITE 200
WALLA WALLA, WASHINGTON 99362

hereby incorporated as Conditions of Approval for this permit.

3. For the duration of this permit, all operations and activities conducted on the property shall be in accord with applicable local, state and federal health and occupational safety regulations, and Washington codes and regulations regarding Transient Accommodations, including without limitation those found in RCW 70.62 and WAC 146-360, as currently written or may subsequently be amended, which are also incorporated herein as Conditions of approval for this CUP.

4. Pursuant to Walla Walla County Code Section 14.13.110, at any time during the life of the permit, the Community Development Department Director may ask the Hearing Examiner to revoke the permit if the project is not in compliance with any of the conditions of approval and/or required permits.

5. Future changes in operations, plans, or additions will require an amendment to the CUP issued herein, which shall be processed as a quasi-judicial review before the County's hearing examiner, consistent with applicable county codes and requirements for a new conditional use permit, as currently written or as may be subsequently amended by the Walla Walla County Board of County Commissioners and in effect as of the date of filing a complete application for an amendment to the CUP issued herein. (*See* WWCC 14.03.050 and Ch. 14.09 WWCC).

6. Because the applicant's property is located within an area with a "high potential for archaeological resources," the applicant shall comply with the recommendations of the Washington State Department of Archaeology and Historic Preservation (*Exhibit 10*) and commission a professional archaeological survey of the project area and submit a report of such survey with any recommendations to the Director, DAHP, and any affected tribes. No ground disturbing activities will be authorized on the site until the cultural resources report is approved by the Director and all recommendations from such report are implemented. If the report includes a recommended Inadvertent Discovery Plan, such plan shall be posted and/or available for review on-site by contractors and applicant representatives during ground disturbing activities.

7. Consistent with County standards for similar uses, outdoor lighting should be shielded to minimize spillage of glare to adjacent properties, roadways, and the night sky. Exterior lighting shall be directed and shielded in a manner that minimizes its visibility at the site's boundaries. Exterior lighting shall not be used in a manner that produces glare on public streets and neighboring residential properties.

8. The Bed and Breakfast establishment shall comply with WWCC Chapter 17.20, Parking Requirements. No parking is allowed off-site or on a County right-of-way. A parking plan demonstrating compliance with Ch. 17.20 WWCC must be submitted for review and approval by the Director before issuance of any building permit associated with this project.

9. The permittee's Bed and Breakfast establishment shall comply with applicable conditions for such uses found in WWCC 17.08.074, including the following:

1 A. Number of Guest Rooms. This permit authorizes no more than ten (10) guest
2 rooms on the parcel addressed in this application, and travelers or transient guests
3 may not stay longer than thirty consecutive days;

4 B. Occupancy. One of the on-site cottages/units must be occupied by the Property
5 Owner or Bed and Breakfast operator;

6 C. Parking. One off-street parking space must be provided for each guest room in
7 addition to any other parking requirements;

8 D. Food Service. Only limited food service as permitted under Washington
9 Administrative Code (WAC) Chapter 246-215, Food Service, may be provided.
10 Food service is limited to overnight guests.

11 E. Signs. Signs associated with this use shall be limited to four square feet in size,
12 except bed and breakfast establishments in a zone which allows signs larger than
13 four square feet may have a larger sign, provided it is in compliance with the size
14 standards for that district. Signs shall meet all setback requirements for the zone in
15 which the bed and breakfast establishment is located.

16 10. No access relating to this Type II Bed & Breakfast use is permitted from State Route
17 125.

18 11. The applicant must comply with all requirements of WWCC 18.08, regarding Critical
19 Area Protection, for any portion of the project within a critical area or critical area buffer.
20 New or updated Critical Area Reports may be required by the Director.

21 12. Subsequent applications for additional Bed & Breakfast or hospitality related uses
22 on the Yellowhawk property must include a full Critical Areas Report and such report
23 must provide "An assessment of the probable cumulative impacts to critical areas
24 resulting from development of the site and the proposed development". (See WWCC
25 18.08.095(C)(6)). WWCC 18.08.020 defines "Cumulative impacts or effects" as follows:
26 "The combined, incremental effects of human activity on critical areas functions and
values. Cumulative impacts result when the effects of an action are added to or interact
with other effects in a particular place and within a particular time. It is the combination
of these effects, and any resulting environmental degradation, that should be the focus
of cumulative impact analysis and changes to policies and permitting decisions."

[Final Condition on following page]

//

//

//

1
2 13. Prior to operation and occupancy of any unit by a guest, the owner/operator must
3 provide the Director and all property owners within five hundred (500) feet of any
4 boundary of the subject property and including any property within 500 feet of any
5 contiguous property in the applicant's ownership, the name and contact information for
6 a designated local property representative/B&B operator who lives onsite where the B&B
7 is located and will respond to complaints and emergencies; and a valid telephone number
8 where the local property representative can be reached twenty-four (24) hours per day.

9 ISSUED this 22nd Day of November, 2022

10 

11
12
13
14
15
16
17
18
19
20
21
22
23
24
25
26
Gary N. McLean
Hearing Examiner

FINDINGS OF FACT, CONCLUSIONS OF LAW AND
DECISION – APPROVING CONDITIONAL USE
PERMIT FOR TYPE II BED AND BREAKFAST ON
THE SOUTH PARCEL OF THE YELLOWBACK
WINERY – FILE NO. CUP22-004

Page 15 of 16

WALLA WALLA COUNTY HEARING EXAMINER
310 W. POPLAR STREET, SUITE 200
WALLA WALLA, WASHINGTON 99362

1
2
3 **FINALITY OF DECISION AND NOTICE OF RIGHTS OF APPEAL**

4 As provided in WWCC 2.50.070(B), *the decision of the hearing examiner on all matters is final and*
5 *conclusive, unless appealed pursuant to Chapter 14.11 of the Walla Walla County Code.*

6 WWCC 2.50.120, captioned "Reconsideration", provides that: *An applicant or party of record to a*
7 *hearing examiner's public hearing may seek reconsideration only of a final decision by filing a written request*
8 *for reconsideration with the community development director within ten days of the final decision. The request*
9 *shall comply with Section 14.11.030 of this code. The hearing examiner shall consider the request at the next*
10 *regularly scheduled meeting, without public comment or argument by the party filing the request. If the request*
11 *is denied, the previous action shall become final as of the date of the decision on the request for*
12 *reconsideration. If the request is granted, the hearing examiner may immediately revise and reissue its decision*
13 *or may call for argument in accordance with the procedures for closed record appeals. Reconsideration should*
14 *be granted only when an obvious legal error has occurred or a material factual issue has been overlooked that*
15 *would change the previous decision.*

16 Finally, WWCC 2.50.130 addresses appeals of a hearing examiner decision, and reads as follows:
17 *The final decision by the hearing examiner on any matter within his or her jurisdiction may be appealed in*
18 *accordance with Chapter 14.11 of the Walla Walla County Code.*

19 **NOTE:** The Notice provided on this page is only a short summary, and is not a complete
20 explanation of fees, deadlines, and other filing requirements applicable to appeals.
21 Individuals should confer with advisors of their choosing and review all relevant codes,
22 including without limitation the code provision referenced above and state law, particularly
23 the Land Use Petition Act (Chapter 36.70C RCW), for additional information and details that
24 may apply.

25 **FINDINGS OF FACT, CONCLUSIONS OF LAW AND**
26 **DECISION – APPROVING CONDITIONAL USE**
PERMIT FOR TYPE II BED AND BREAKFAST ON
THE SOUTH PARCEL OF THE YELLOWBACK
WINERY – FILE NO. CUP22-004

WALLA WALLA COUNTY HEARING EXAMINER
310 W. POPLAR STREET, SUITE 200
WALLA WALLA, WASHINGTON 99362