



City of Yelm

EST. 1924

WASHINGTON

"Pride of the Prairie"

THE CITY OF YELM COMMUNITY DEVELOPMENT DEPARTMENT WILL CONSIDER THE FOLLOWING
CASES VIA GOTO MEETING VIDEO CONFERENCING

WEDNESDAY, MAY 27, 2020

TIME	PRESUBMISSION Applicant Attendance Required	SITE PLAN REVIEW Internal Staff Review Only*	OTHER	DESCRIPTION
2:00 p.m.				Luke Taylor Retail Landscape Supply 1405 Yelm Ave. E 22730140400
3:00 p.m.				



A pre submission conference is an opportunity for project proponents to meet with City staff prior to making a development application to the City. The intent is to identify and eliminate as many potential issues as possible in order for the project to be processed without delay. The conference should take place prior to detailed work by an engineer or surveyor, **however a site drawing must be submitted that has sufficient information to allow a meaningful review.** Staff notes are prepared and available for review. There is no charge for this meeting. **Meetings are held every Wednesday starting at 2:00 PM.** The request must be submitted no later than 5:00 PM least one week before the preferred meeting date.

Requested Date: 5/27/2020

Requested Time: 06:00:00 PM

Project Information

Site Plan Upload:* You may upload multiple Files. Files must be in .PDF, .TIF or Image Format.
Scan0126.pdf 163.55KB

Parcel #:* <http://www.geodata.org/parcelinfo/>
22730140400

Parcel Address*
Street Address
1405 Yelm Avenue East
City State / Province / Region
Yelm Washington
Postal / Zip Code
98597

Description of project proposal*
The proposed project at 1405 Yelm Ave East would be a retail landscape supply store open to the public. The store would operate seven days a week and carry a variety of different wood products, along with rock and soil. The different materials would be brought in by either Semis or dump trucks. The material would be organized in bins made up of ecology blocks along the sides of the property and a portable office would be placed on the lot. The business will offer U-Haul and delivery options. A front loader will be used to load customers with trucks or trailers when they purchase for U-Haul. A dump truck will be used to deliver material to customers throughout the city of Yelm and surrounding areas who are buying bigger quantities of material or don't have access to a truck for U-Haul. Customers would either enter the lot from Yelm Avenue or Morris Rd depending on which direction they are coming from.

Applicant Information

Applicant Name:* Luke Taylor

Telephone #: 3609183702

Email:* luketaylor96@gmail.com

Applicant Address:* Street Address
4701 60th Lane SW
City State / Province / Region
Tumwater Washington
Postal / Zip Code
98512

Owner

Owner Name: D&B Retail Development LLC
Telephone #: 12537321740
Email: dan@firstwesternproperties.com
Owner Address: Street Address
6402 Tacoma Mall BLVD
City State / Province / Region
Tacoma WA
Postal / Zip Code
98409

Representative

Rep Name: Dan Durr
Telephone #: 12534715505
Email: dan@firstwesternproperties.com
Rep Address: Street Address
6402 Tacoma Mall BLVD
City State / Province / Region
Tacoma WA
Postal / Zip Code
98409

For Internal Use Only

Presub Assignment Date:* 5/27/2020

Presub Assignment Time:* 02:00:00 PM

Notes: Please note that the Presubmission meeting will be held virtually in GoToMeeting. An email with instructions will follow in a few days. The meeting time is 2:00PM

Morris Rd SE

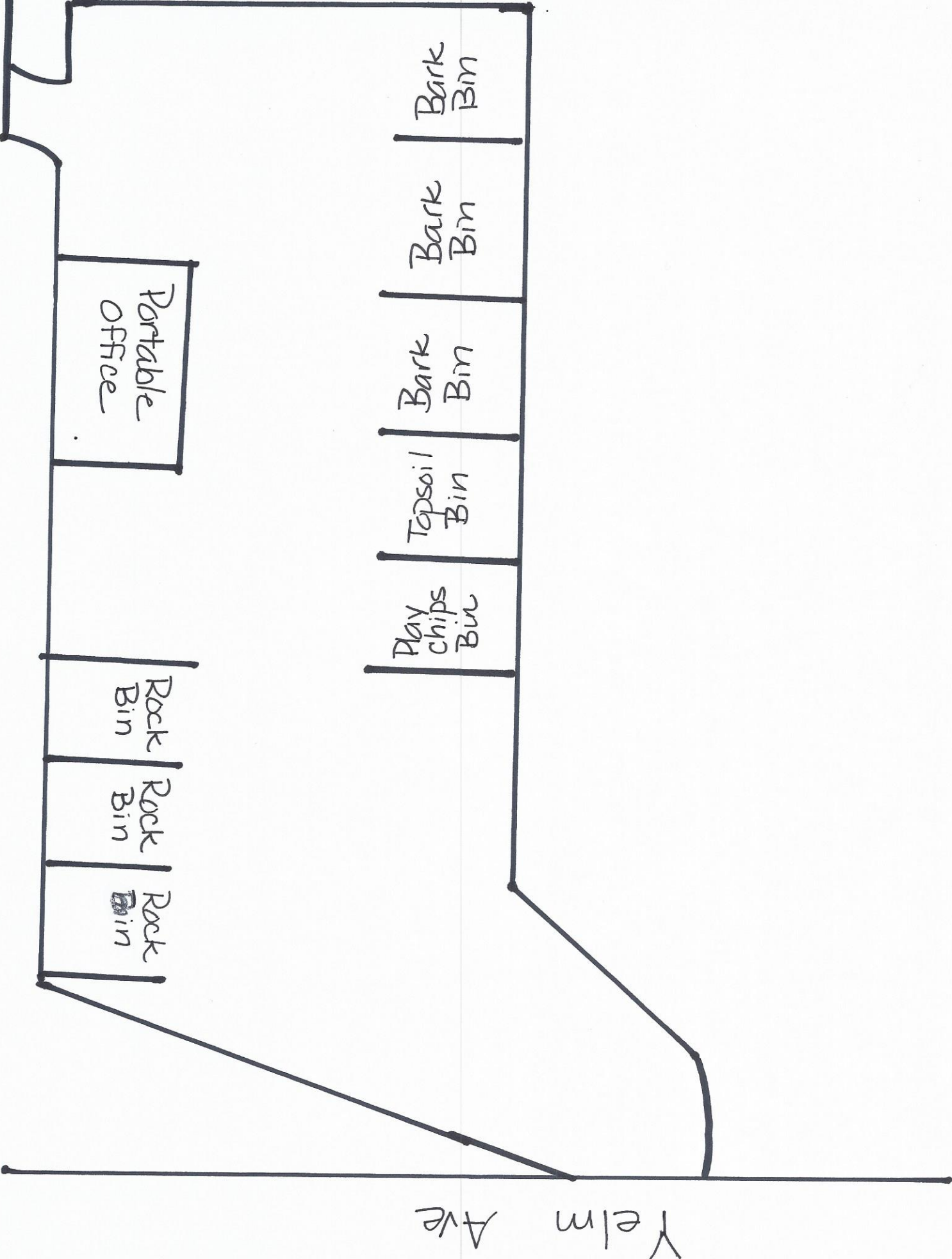

Yelm Ave