



County of Yuba

Community Development and Services Department

Building Division

915 8th Street, Suite 133
Marysville, Ca 95901

PHONE : (530) 749-5440

FAX: (530) 749-5616
www.co.yuba.ca.us

WINDOW REPLACEMENTS

- 1). A permit is required for all types of window replacements.
- 2). Inspections required: Final Inspection Only.
- 3). Inspection criteria as follows:
 - Confirm emergency escape or rescue windows in sleeping rooms meet minimum California Building Code requirements to include, a minimum net clear openable area of 5.7 square feet (5 sq feet see exception).
 - Minimum net clear height dimension of 24".
 - Minimum net clear width dimension of 20".
 - Maximum of 44" from finished floor to lowest part of window opening.
- 4). Confirm interior / exterior glazing meets California Building codes for human impact loads in specific hazardous locations. Labeling for safety glazing must be permanently identified by the manufacturer as tempered either by being etched or ceramic fired on the window and visible to the Building inspector.
- 5). Confirm that the replacement windows meet current minimum California Energyefficiency Standards for U-factor and solar heat gain coefficient.
- 6). Confirm that all replacement windows are weather tight.

Please note:

Basements require a window well be installed in addition to all other requirements. please contact a Building inspector with any questions.

Please see the "Emergency Escape or Rescue" handout for all required opening information.

Window clear width	20"	21"	22"	23"	24"	25"	26"	27"	28"	29"	30"	31"	32"	33"	34"
Window clear height	41"	40"	38"	36"	35"	34"	33"	32"	31"	30"	29"	28"	27"	26"	25"



County of Yuba

Community Development and Services Agency

Building Department

915 8th Street, Suite 133

Marysville, Ca 95901

PHONE : (530) 749-5440

FAX: (530) 749-5616

www.co.yuba.ca.us

WINDOW FLASHING

STEP # 1

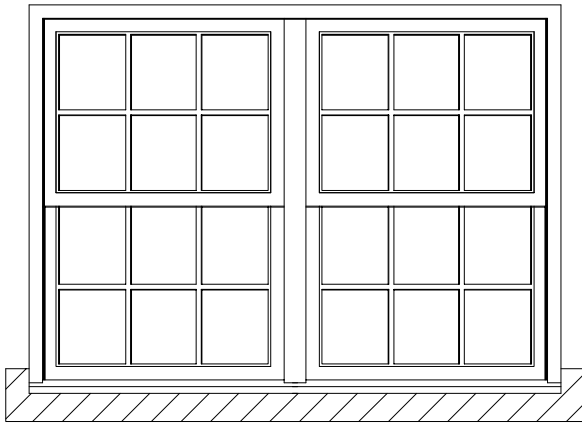

INSTALL THE FIRST FLASHING SHEET UNDER BOTTOM NAILING FLANGE *BEFORE* INSTALLING THE WINDOW.

STEP # 2

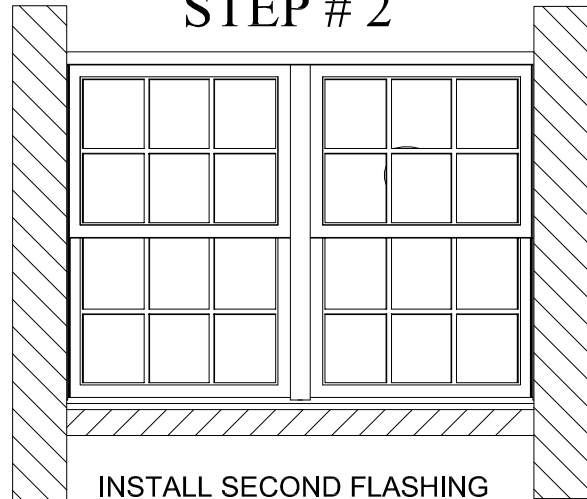

INSTALL SECOND FLASHING SHEETS ON TOP OF THE NAILING FLANGE ON BOTH SIDES OF THE WINDOW AND OVERLAP PAST TOP AND BOTTOM

STEP # 3

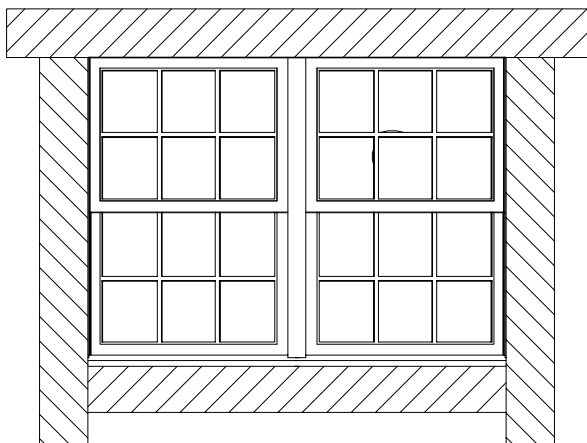

INSTALL THIRD FLASHING SHEET OVER TOP NAILING FLANGE AND OVERLAP PAST SIDE FLASHING SHEETS.

NOTE: PLEASE BE AWARE THAT THESE DETAILS ARE FOR REFERENCE ONLY.

PLEASE FOLLOW THE WINDOW MANUFACTURES INSTALLATION RECOMMENDATIONS AND GUIDELINES. FAILURE TO INSTALL WINDOWS WITHOUT FOLLOWING MANUFACTURES INSTALLATION RECOMMENDATIONS AND GUIDELINES MAY VOID THE WINDOWS WARRANTY.